

TEAMPRP
PRENEVOST RACING PERFORMANCE

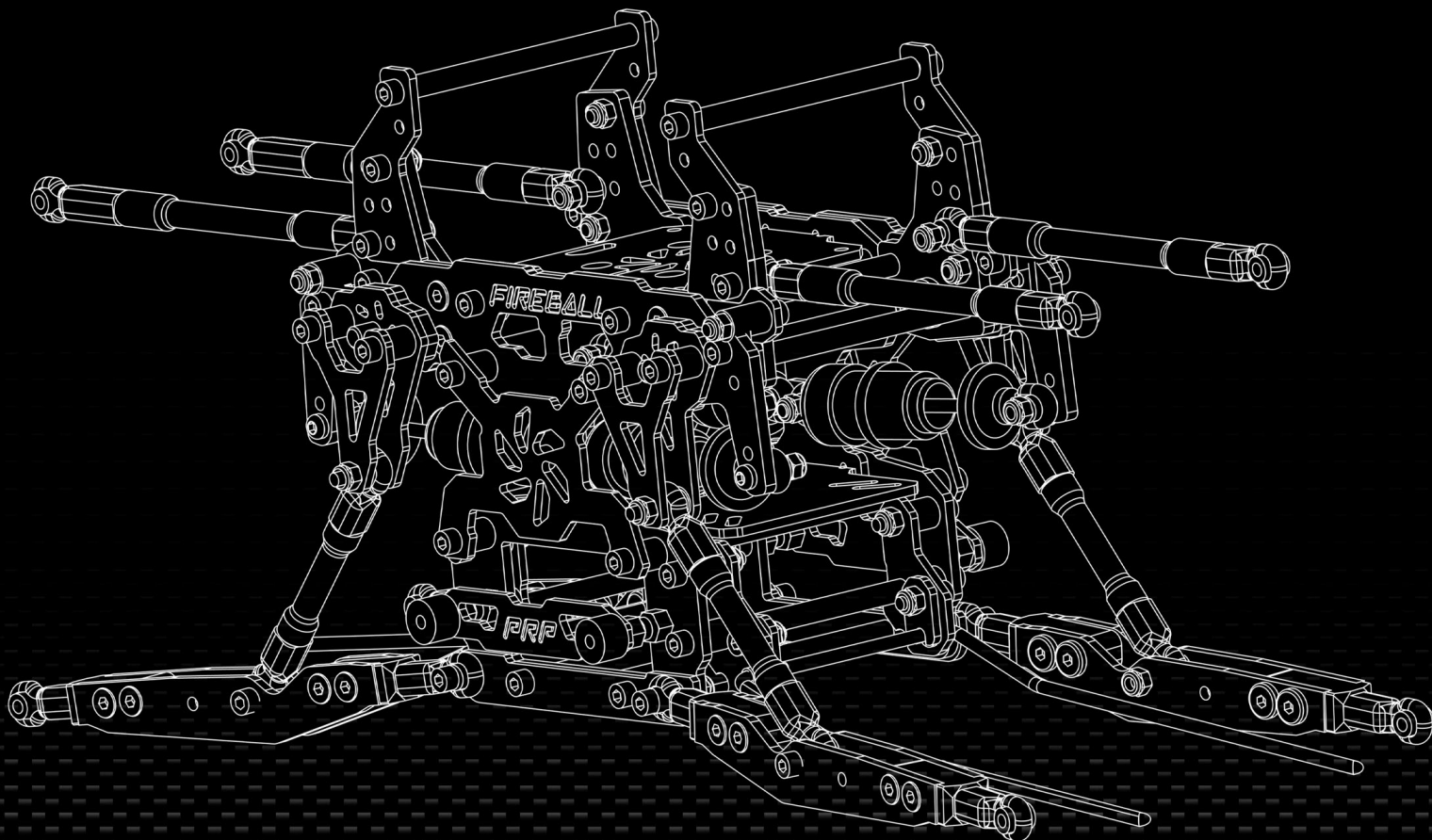

FIREBALL

ADVANCED TAMIYA CLOBUSTER RACING
CONVERSION KIT

// INSTRUCTION MANUAL

REQUIRED PARTS:

For the optimal Fireball suspension geometry Team PRP recommends the Yeah Racing Big Bore Go Shocks in 70mm length. They come in Red, Black and Blue. Of course you should get the Red ones for the Fireball ;)

70mm Shock / Damper Set Part# YEA-BBG-0070RD

Amain Hobbies sells the red shocks and you can often find them at Nitro Hobbies, RCMart, eBay and of course you should just order them from your Local Hobby Shop if they are Yeah Racing dealers.

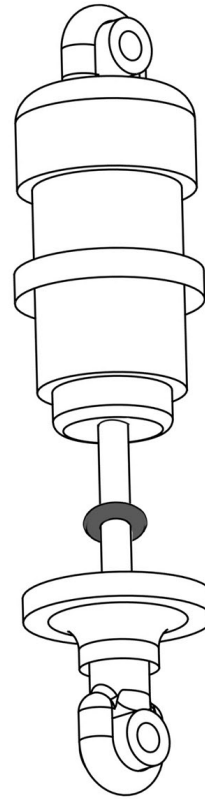

My Base Indoor Carpet Shock Setup:

- Yeah Racing included soft springs
- Yeah Racing 4-hole pistons
- 50wt Team Associated shock fluid
- Oring on shock shaft (Bump stop)
- Avid RC Slop Shock Oring Lube

FULL BLING NOTE:

48 red counterbore finishing washers are included and are used mainly on the core chassis and trailing arm shock screw. They will not cover every screw on the kit.

RECOMMENDED TOOLS:

- 4mm Hex Key
- Metric Ball Hex Drivers in 2.5mm and 2.0mm
- Metric Nut Drivers in 5.5mm and 5.0mm
- 8mm Nut Driver
- Needle Nose Pliers



1 Insert 4 bearings into 4 Suspension Towers seating them flush on the backside. Towers included in your kit will vary depending on version purchased.



5x11x4 Bearing x4

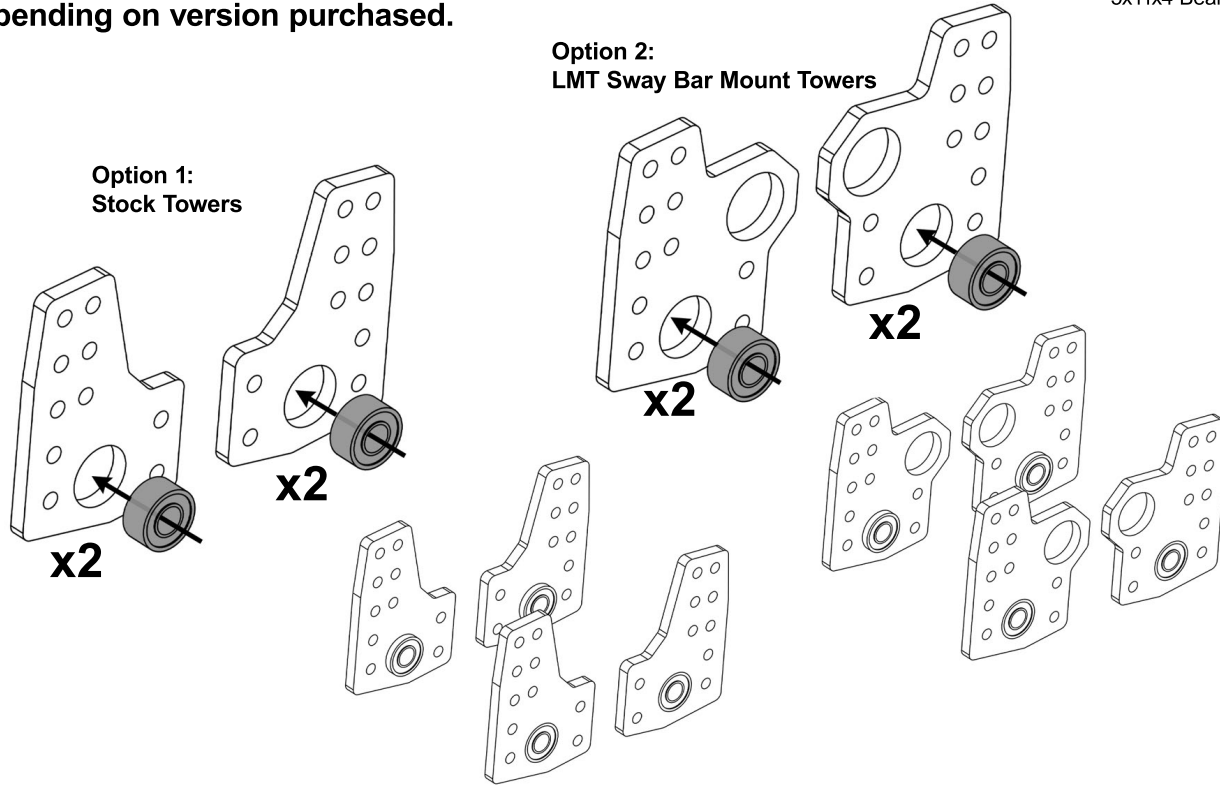

2 Install 2 Suspension towers onto 1 side plate.

!!DO NOT install all 4 Suspension Towers yet!!



M3x14mm
Flat Head x4

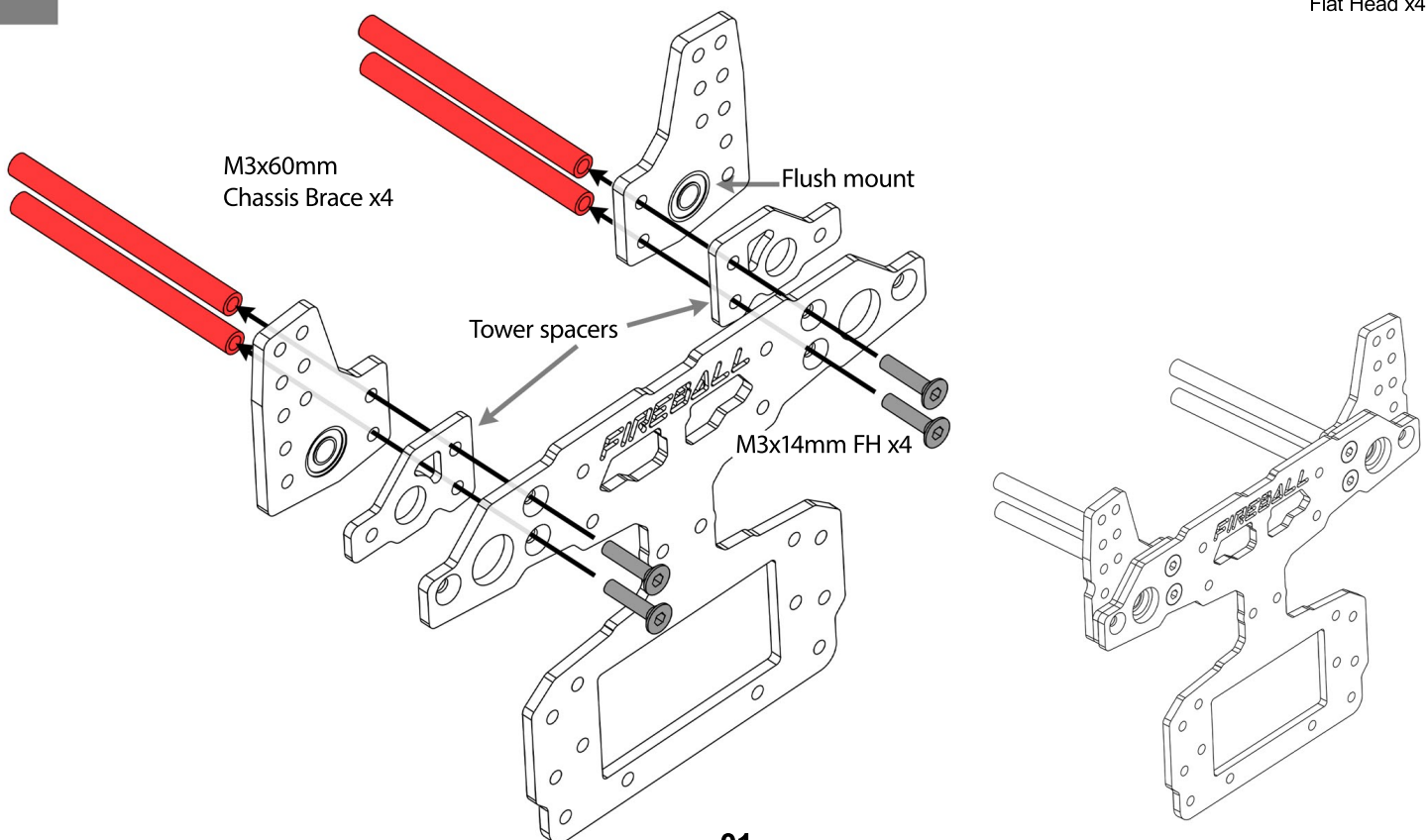

3

Install Rocker Arm pivot screws x2.

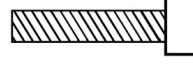

M5x25mm
Cap Head x2



5x7x1 Shim x4

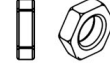

M5 Hex Nut
x2



5x11x4 Bearing
x2

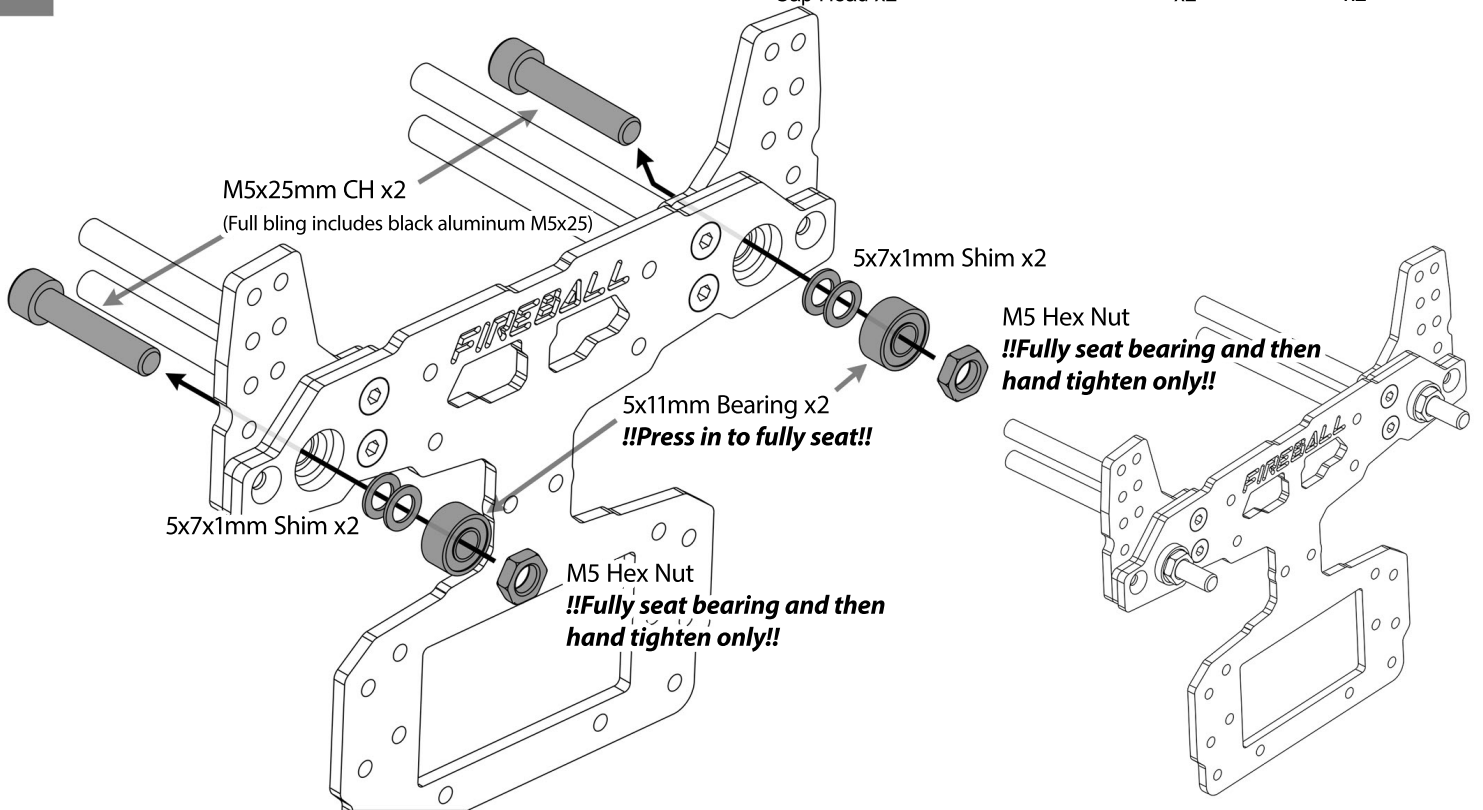

4

Take other side plate and install Suspension Towers x2.



M3x14mm
Flat Head x2

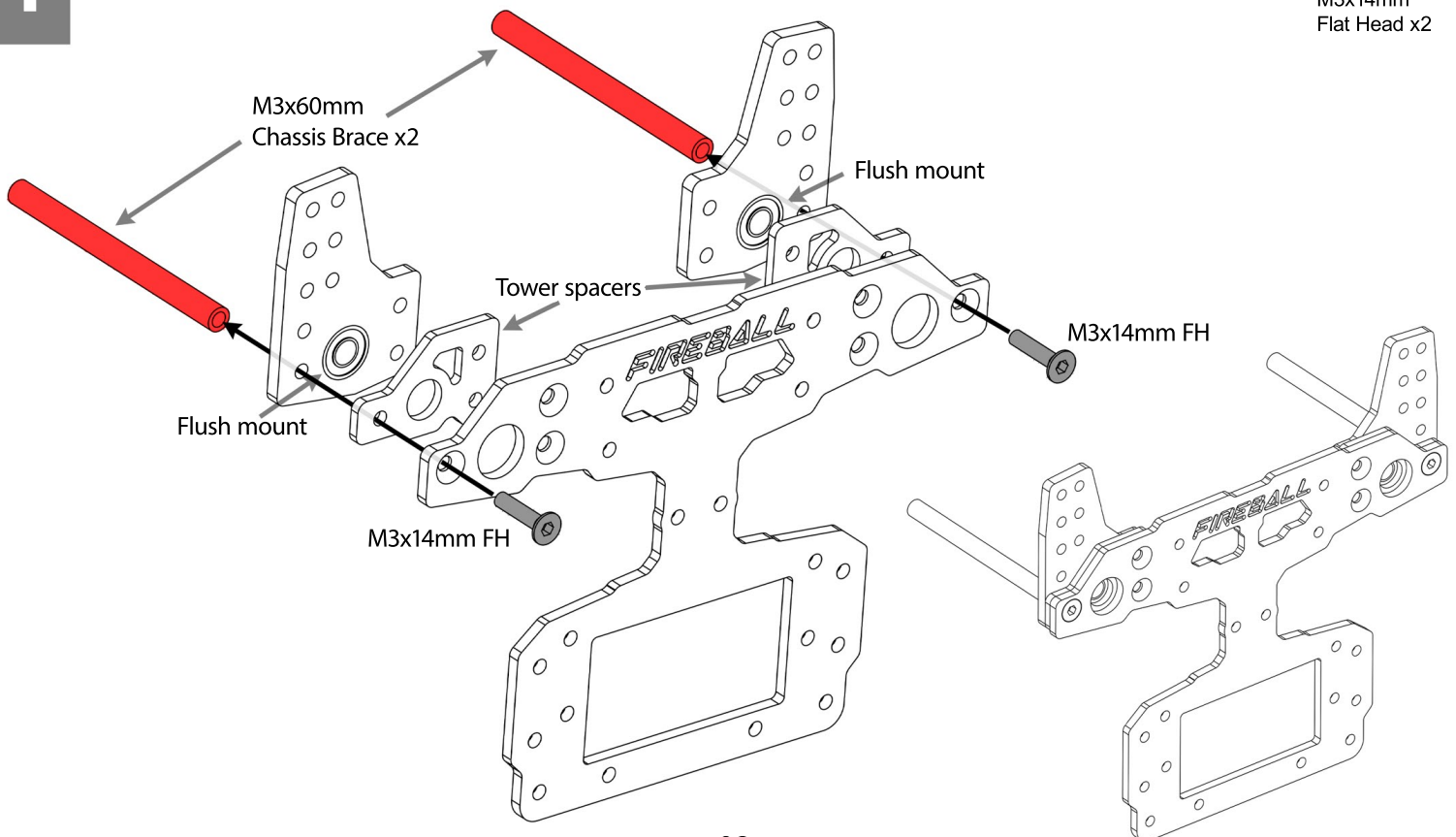

5

Install Rocker Arm pivot screws x2.

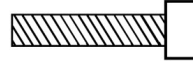

M5x25mm
Cap Head x2



5x7x1 Shim x4

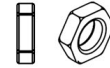

M5 Hex Nut
x2



5x11x4 Bearing
x2

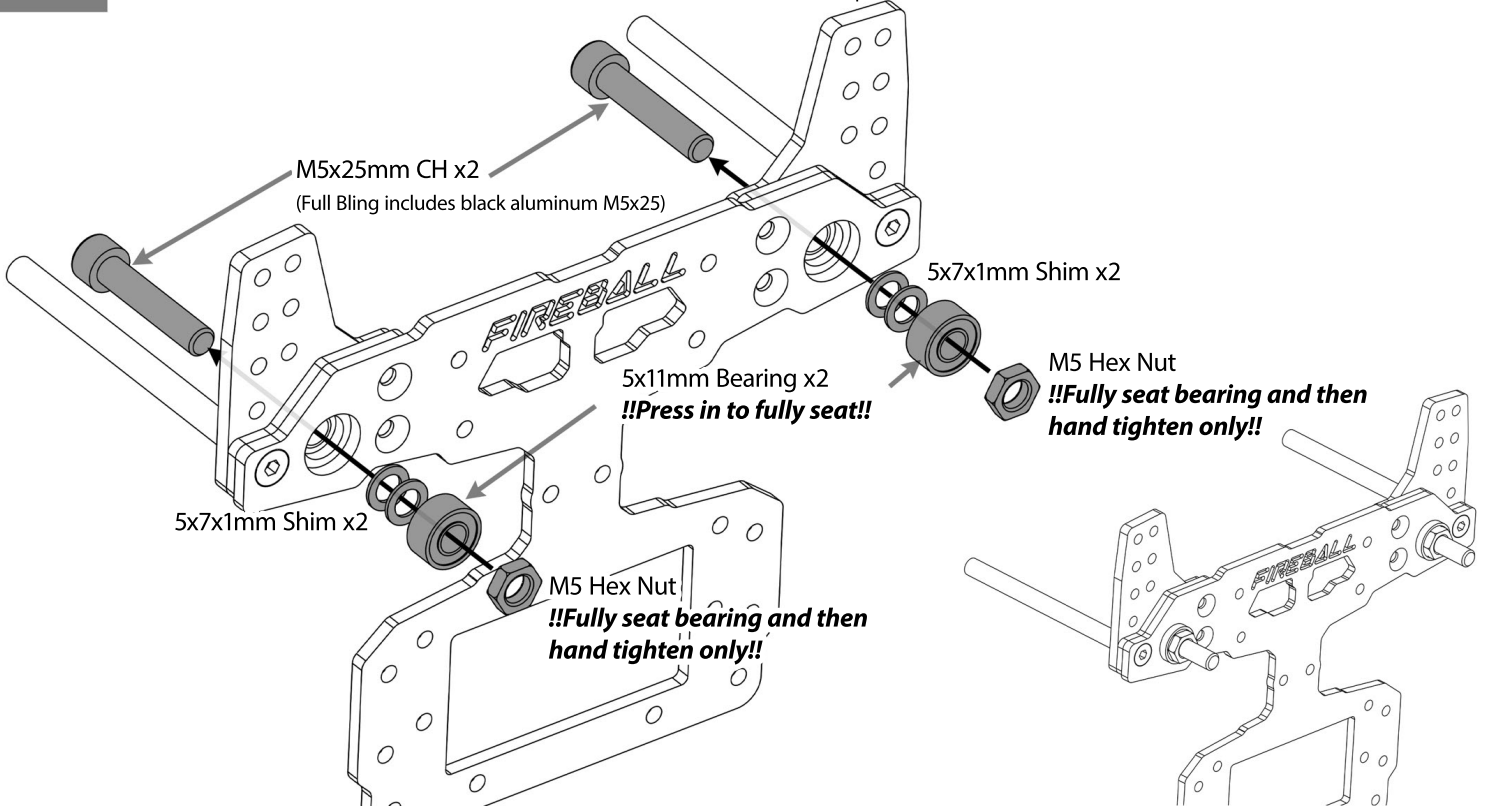

6

Install shocks x2 with o-ring bump stops.



O-ring x2



M3 Locknut x2



M3x16mm
Cap Head x2

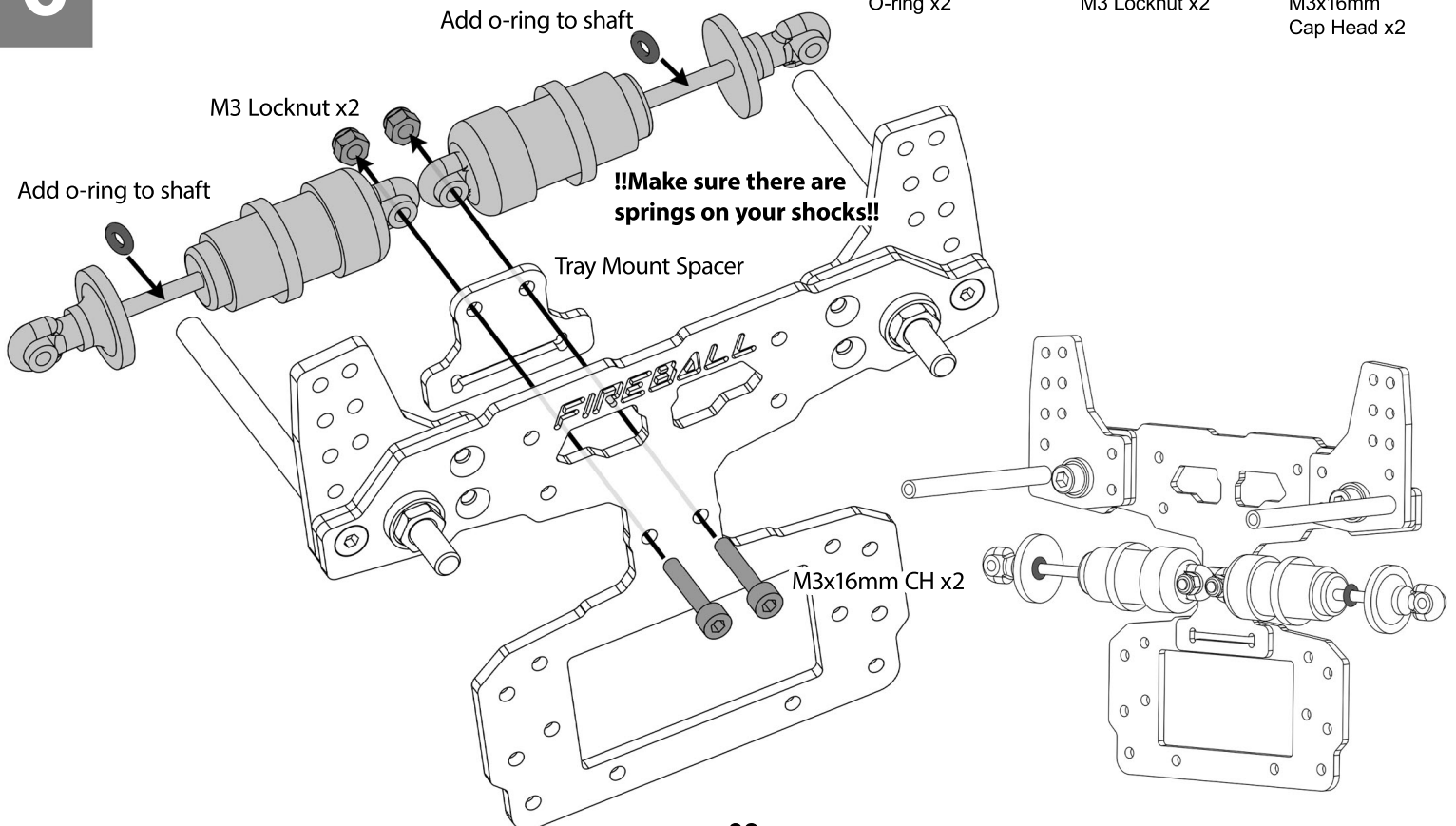

7 Install shocks x2 with o-ring bump stops.

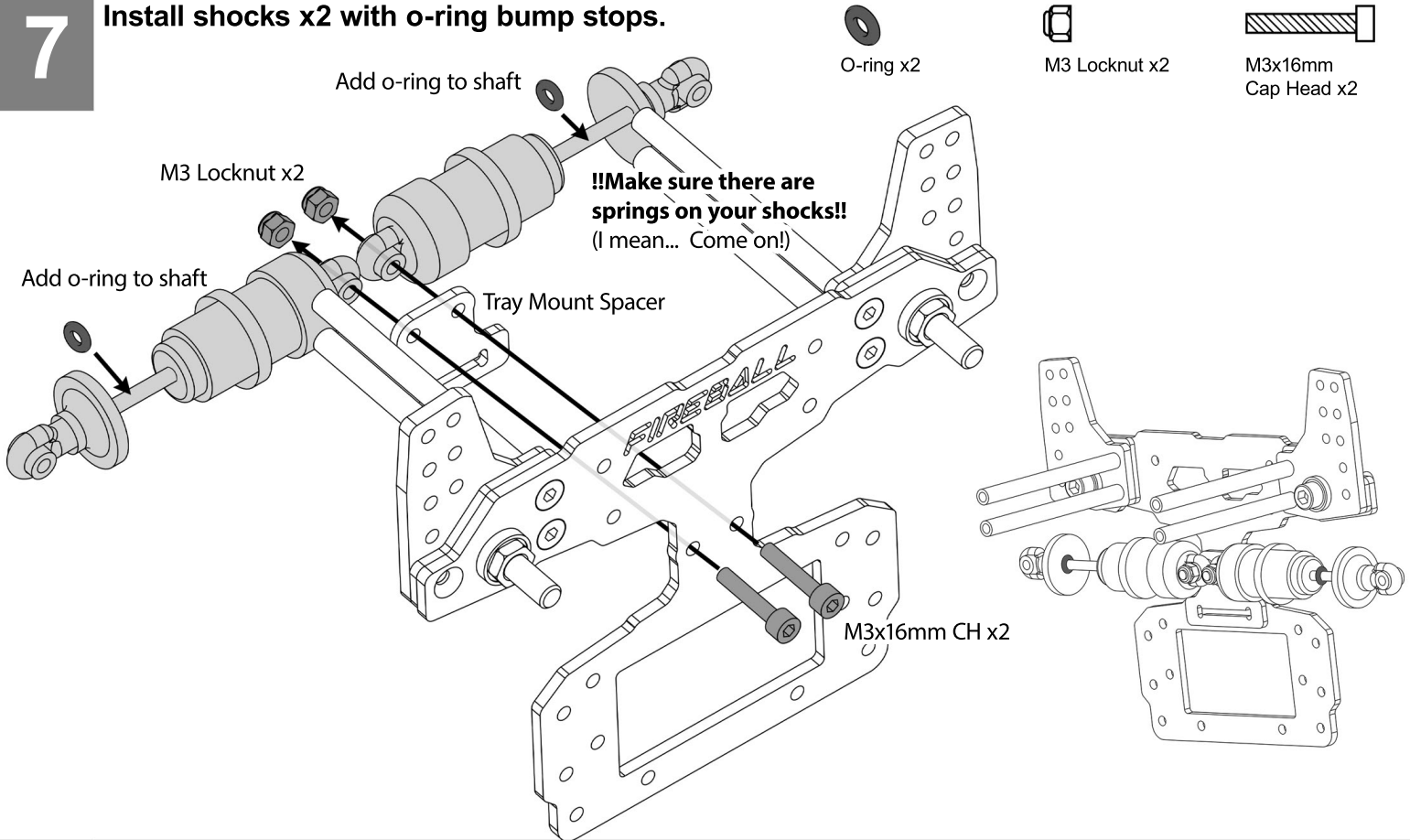

8 Install Icon Brace and 70mm Cross Braces x2

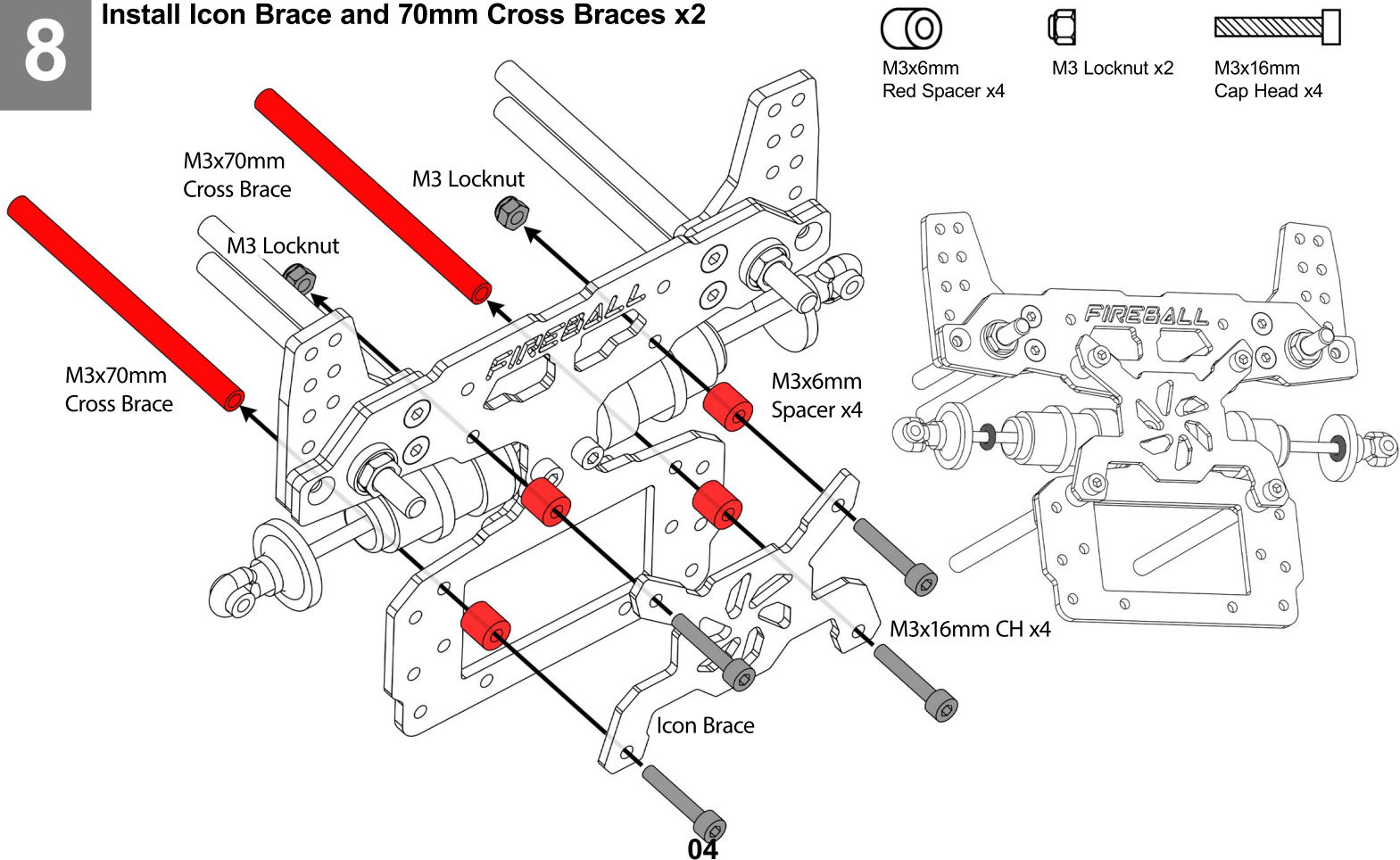

9

Install Battery Straps on both left and right chassis plates.



M3x12
Standoff x4



Thumbnut x4



M3x22mm
Cap Head x4

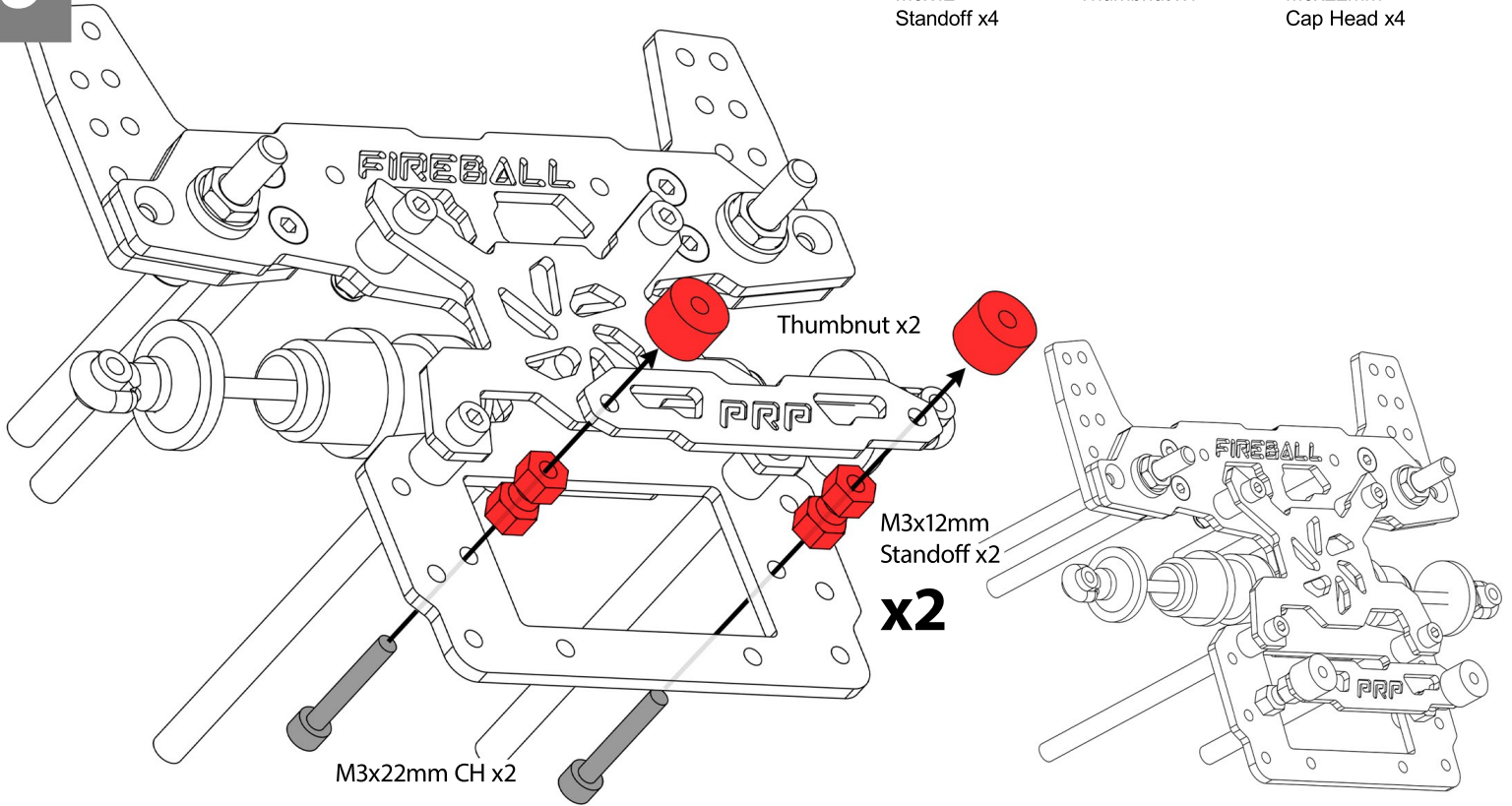

10

Install Icon Brace



M3x6mm
Red Spacer x4



M3 Locknut x2



M3x16mm
Cap Head x4

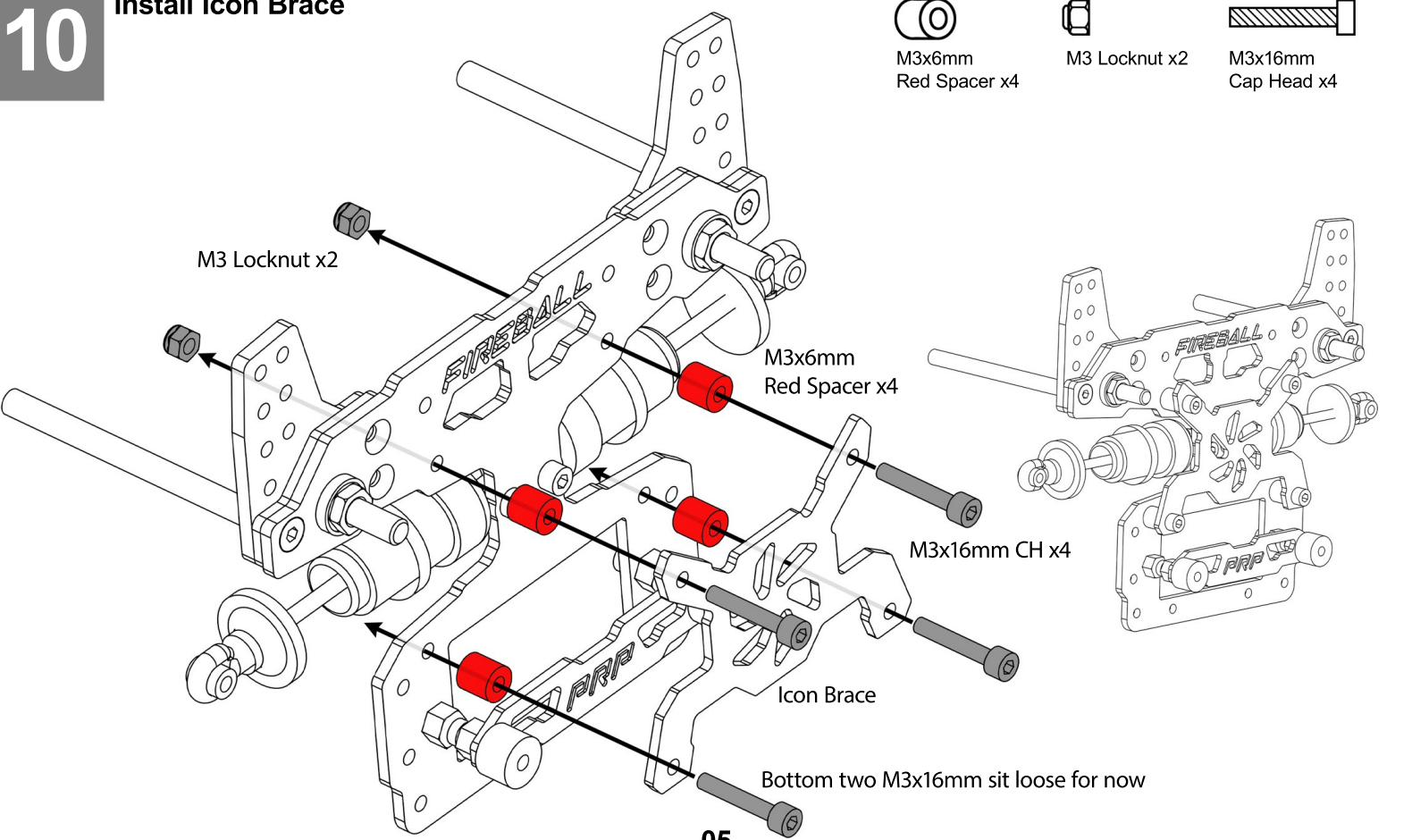

11

1. Assemble carbon fiber droop stops. Make two of each orientation. 2. Attach droop stops x4 to left and right chassis plates.

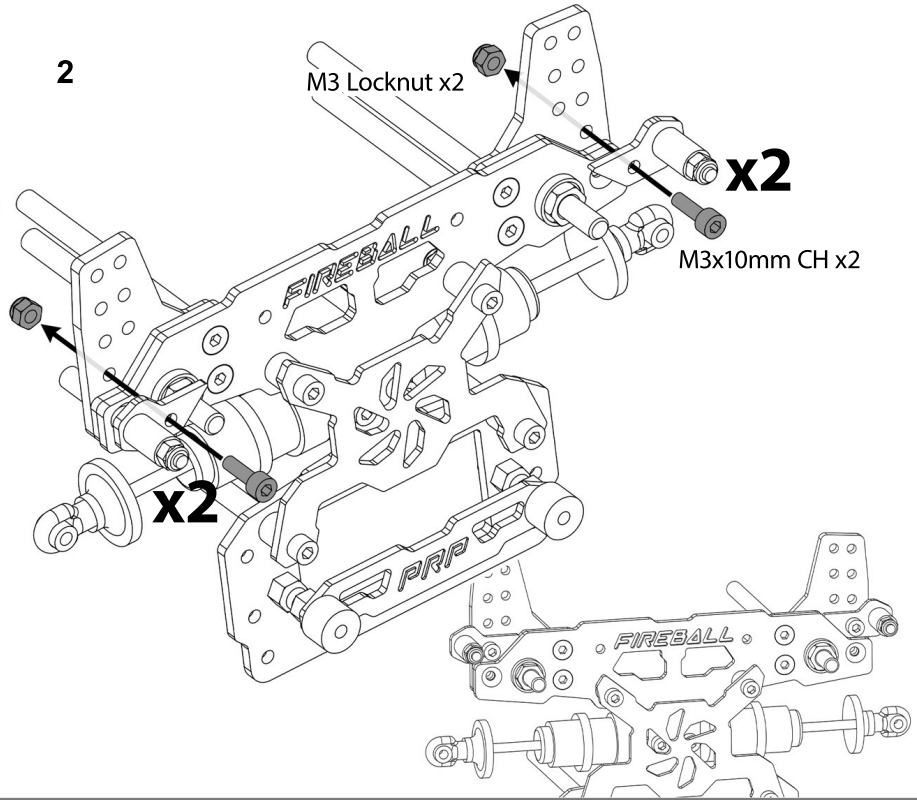
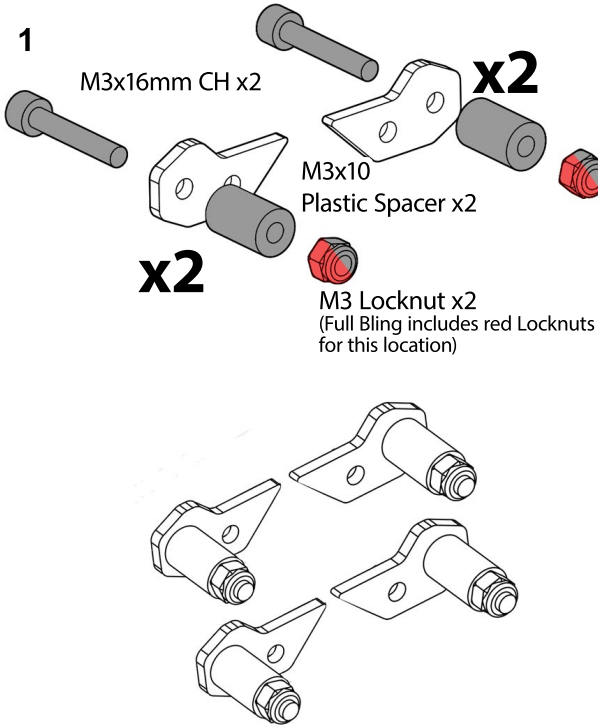
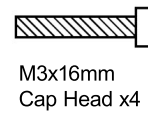
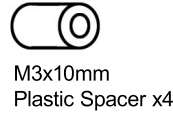

12

Attach Skid Rail to bottom of chassis. Note: Full Bling kit includes CNC black aluminum bulkhead brace.

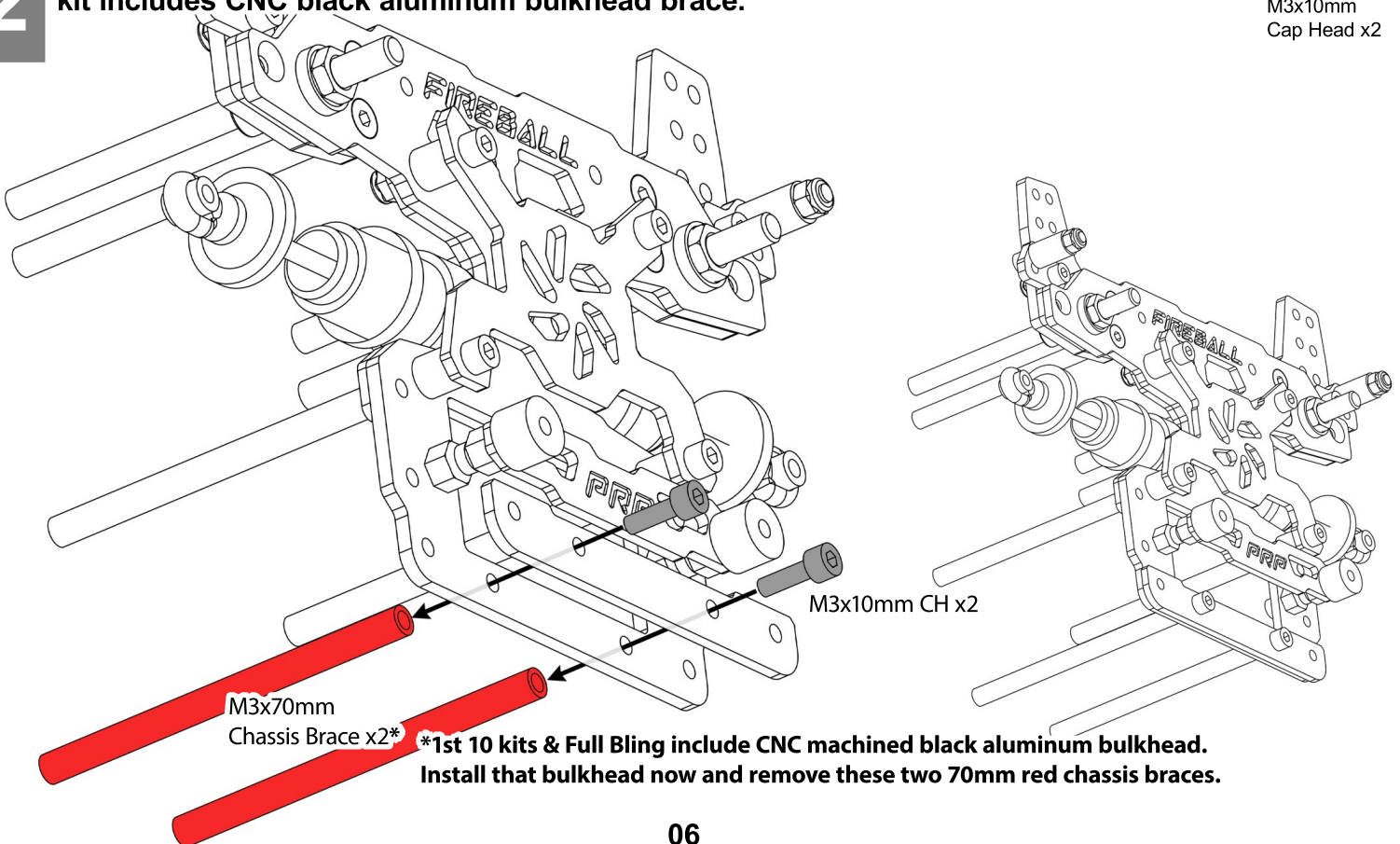
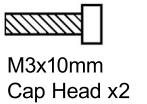

13

Assemble Upper Tray Mounts and attach them to both chassis side plates.



M3 Press Nut
x4



M3 Washer



M3x6mm
Cap Head x4

1 Seat press nuts with screw and washer.

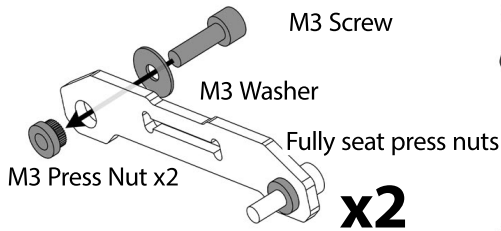

x2

2 Remove screw and washer.

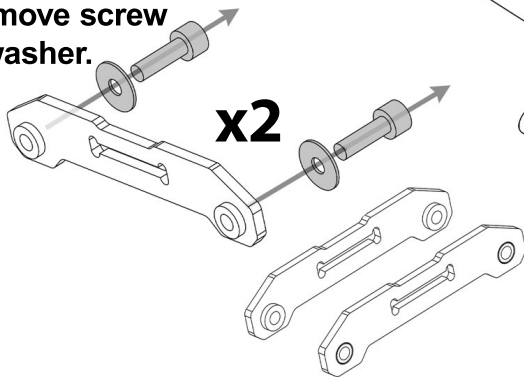

3 Attach mounts to both side plates.

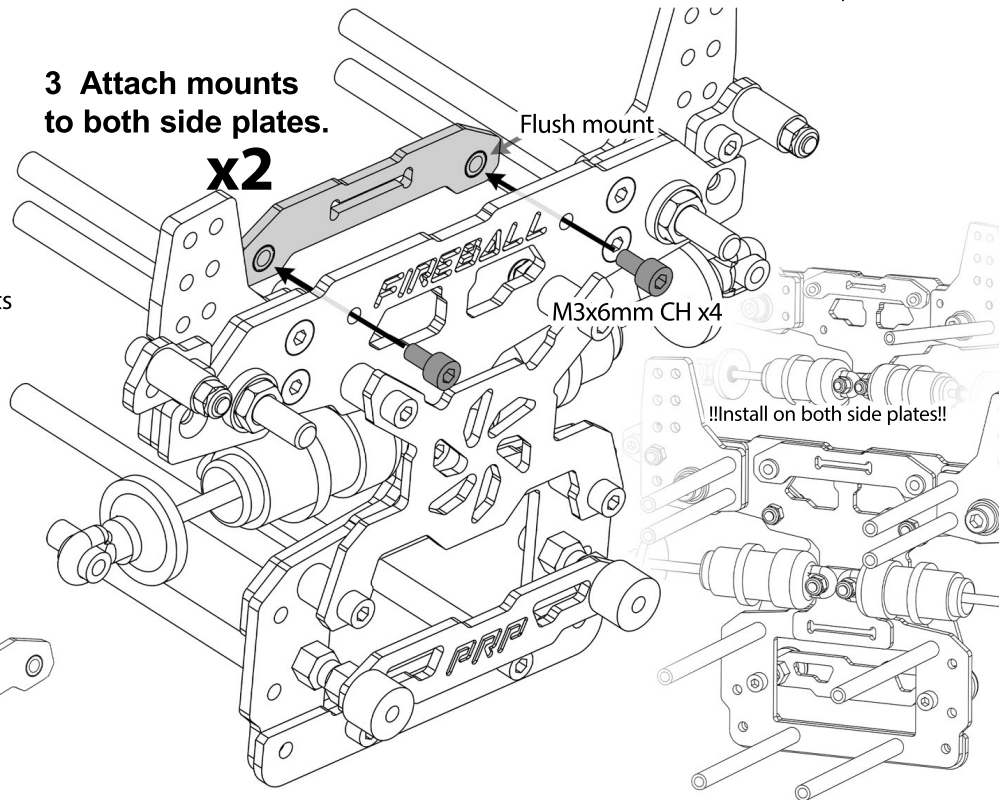

14

1. Slide Upper and Lower Trays into place. 2. Attach left and right chassis sides together. If you are using the LMT Sway Bar install the aluminum rods before putting the chassis together.

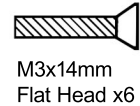

M3x14mm
Flat Head x6

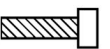

M3x10mm
Cap Head x2

1

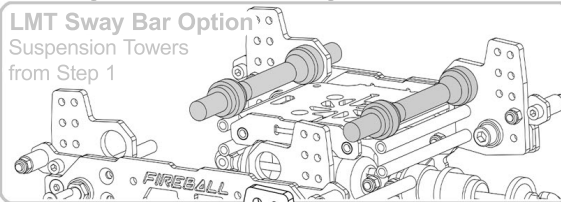
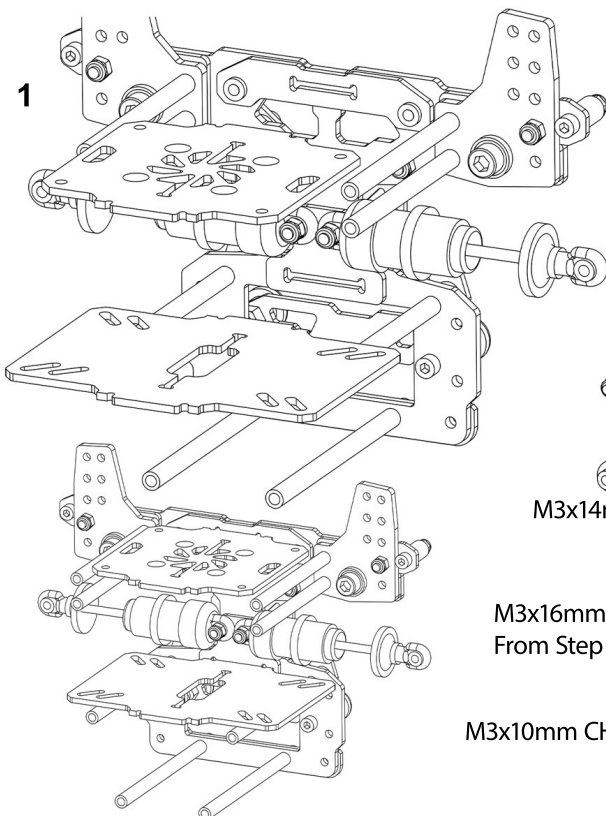

2

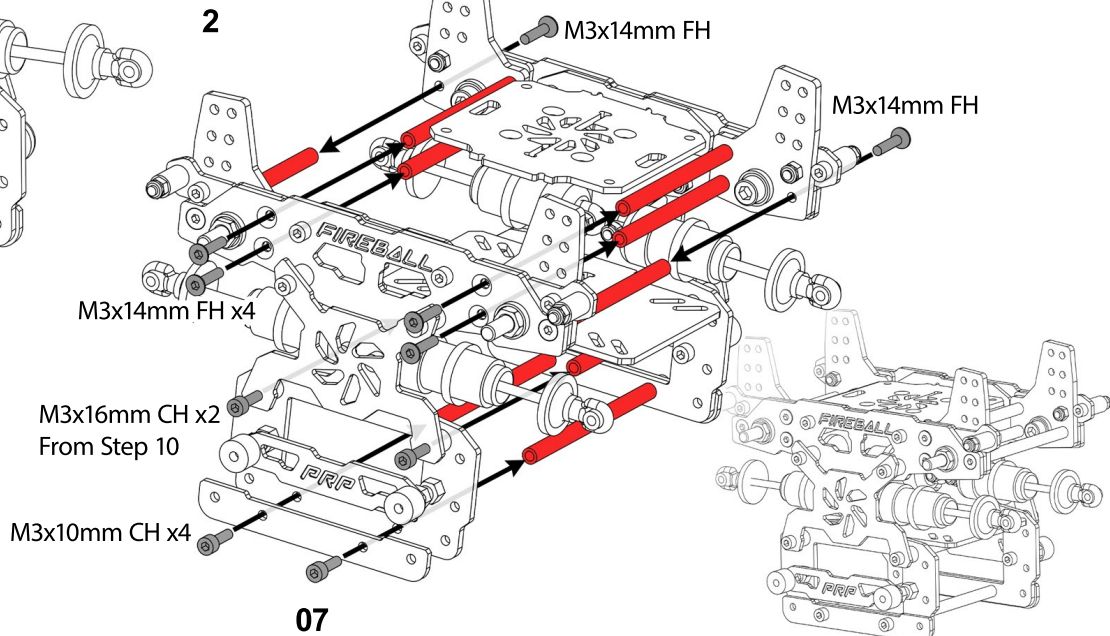

15

Install Body Post Mounts. Body posts not included and must be chosen based on your preferred body and mounting style.

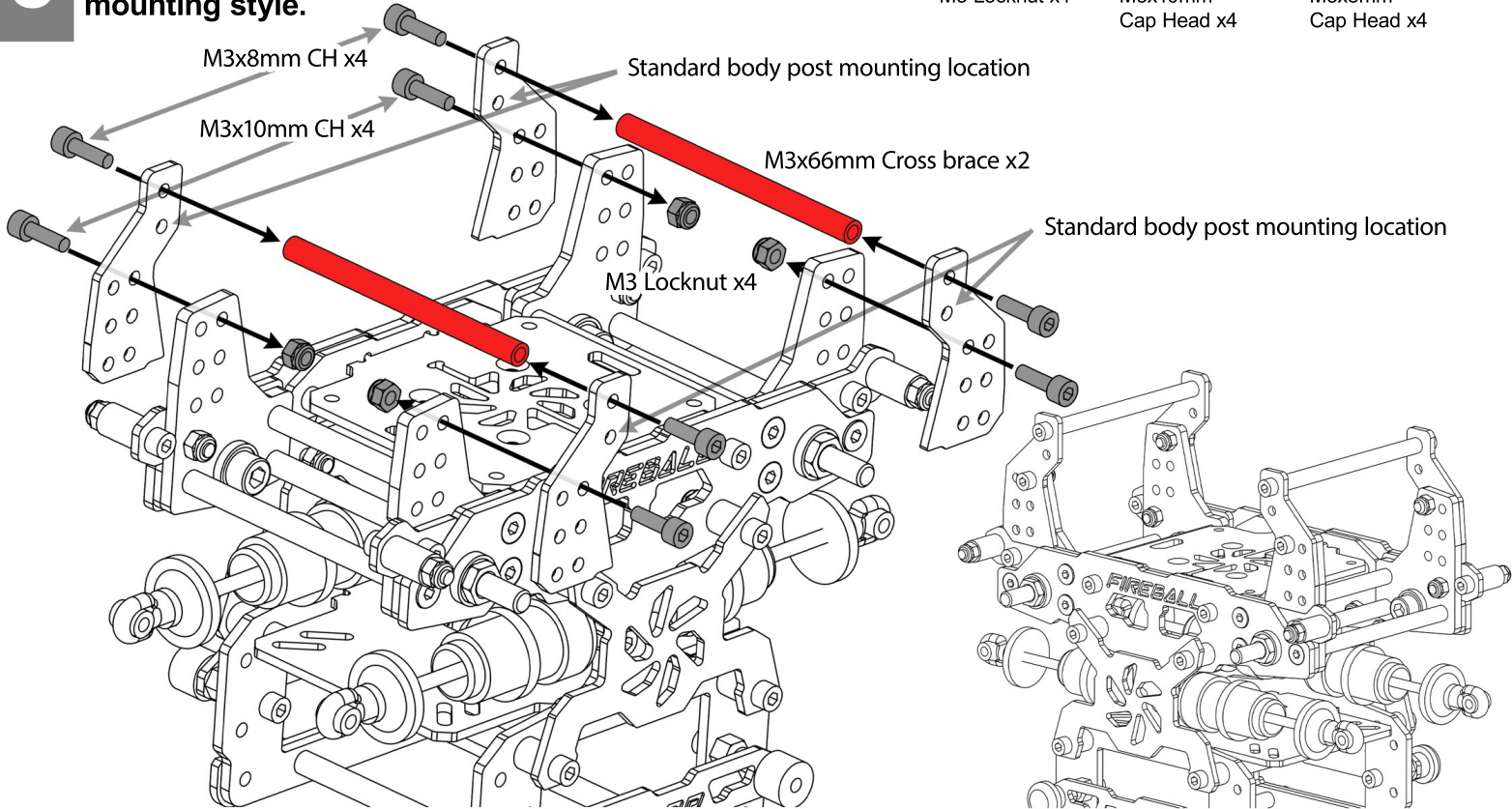

16

Assemble Links and attach upper links to chassis.

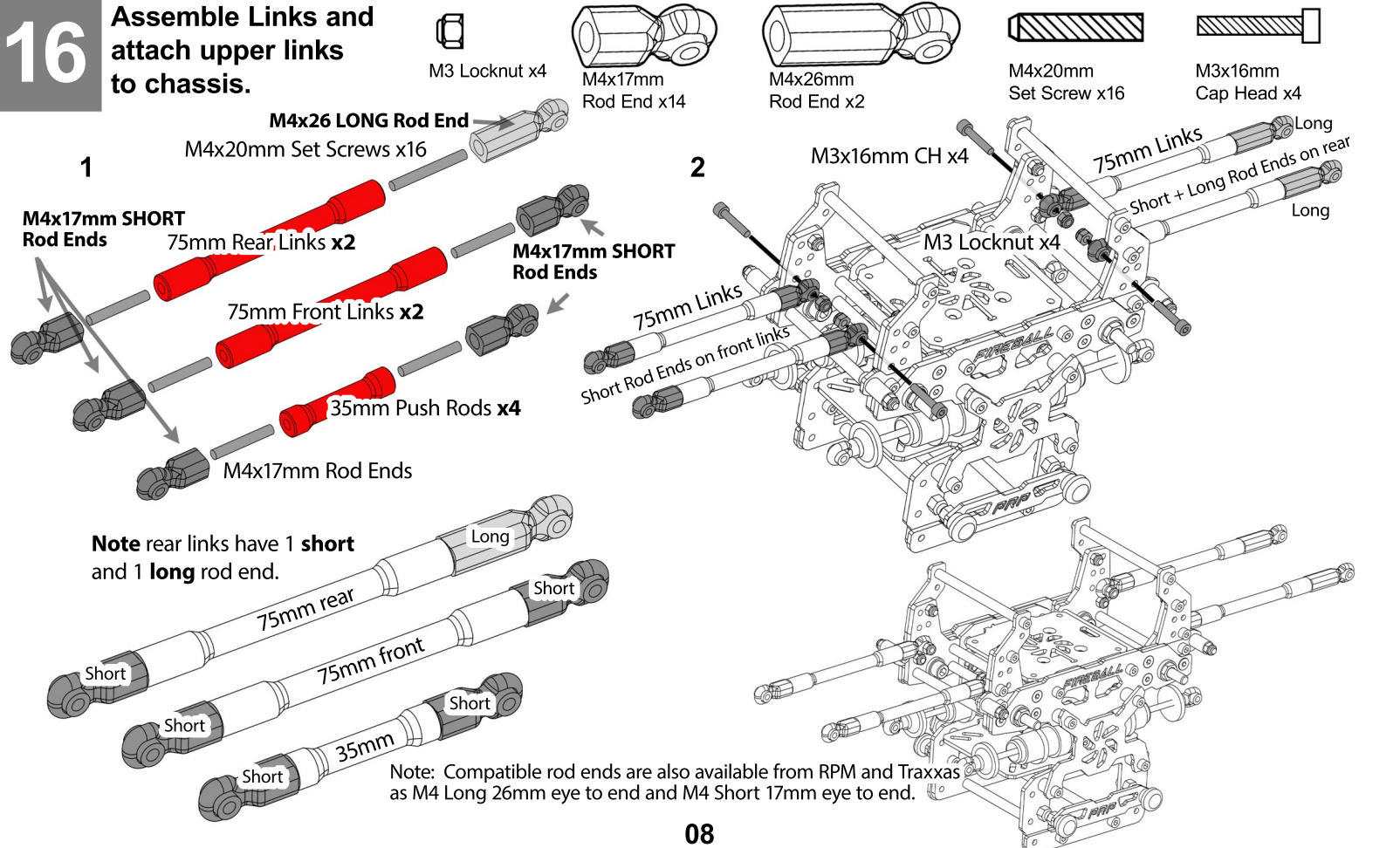

17

Assemble Trailing Arms x4. Pay attention to assembly orientation.

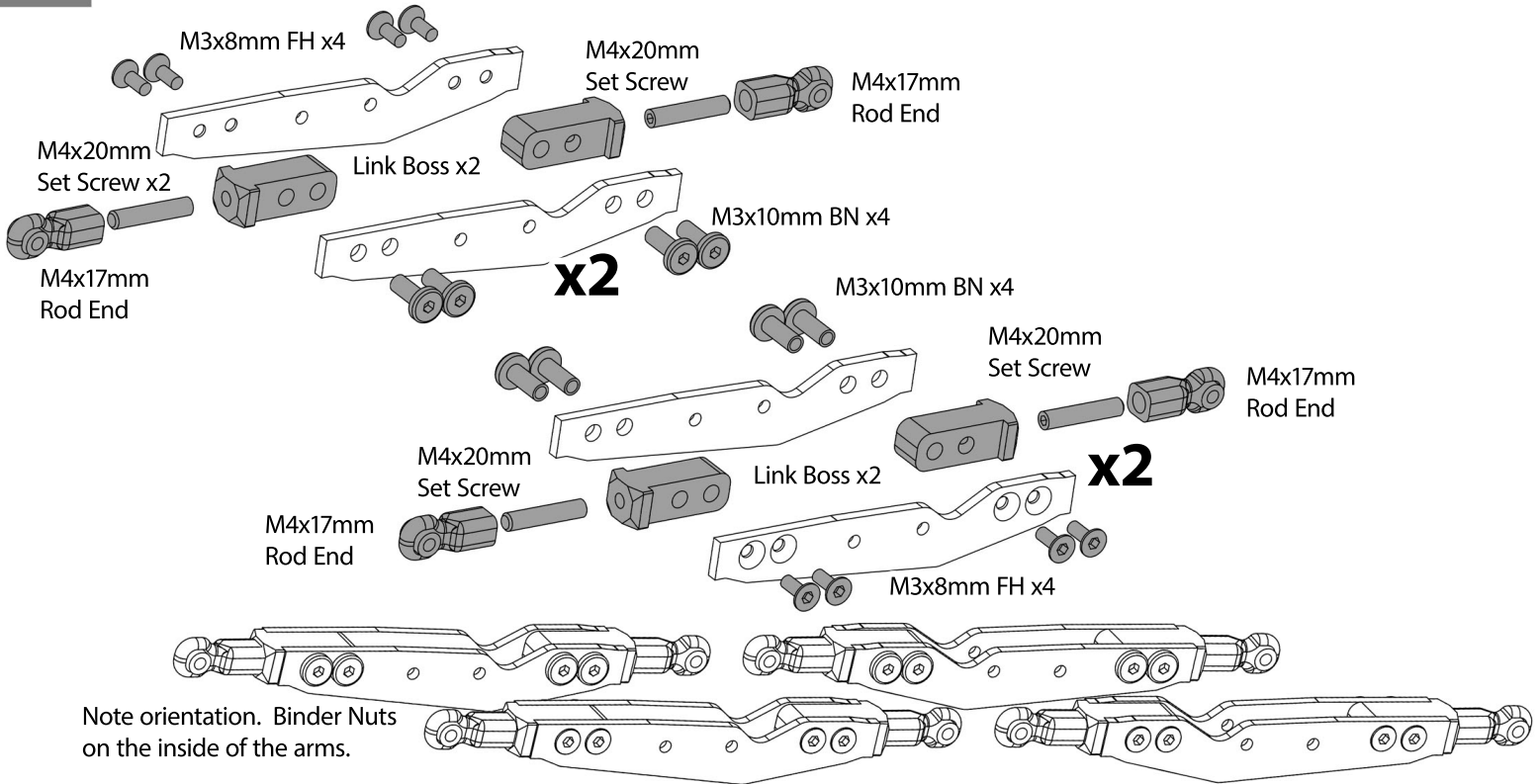
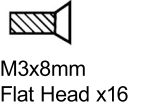
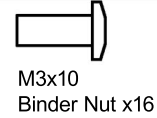
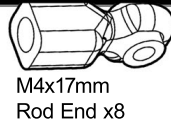

18

Attach Trailing Arms to chassis.

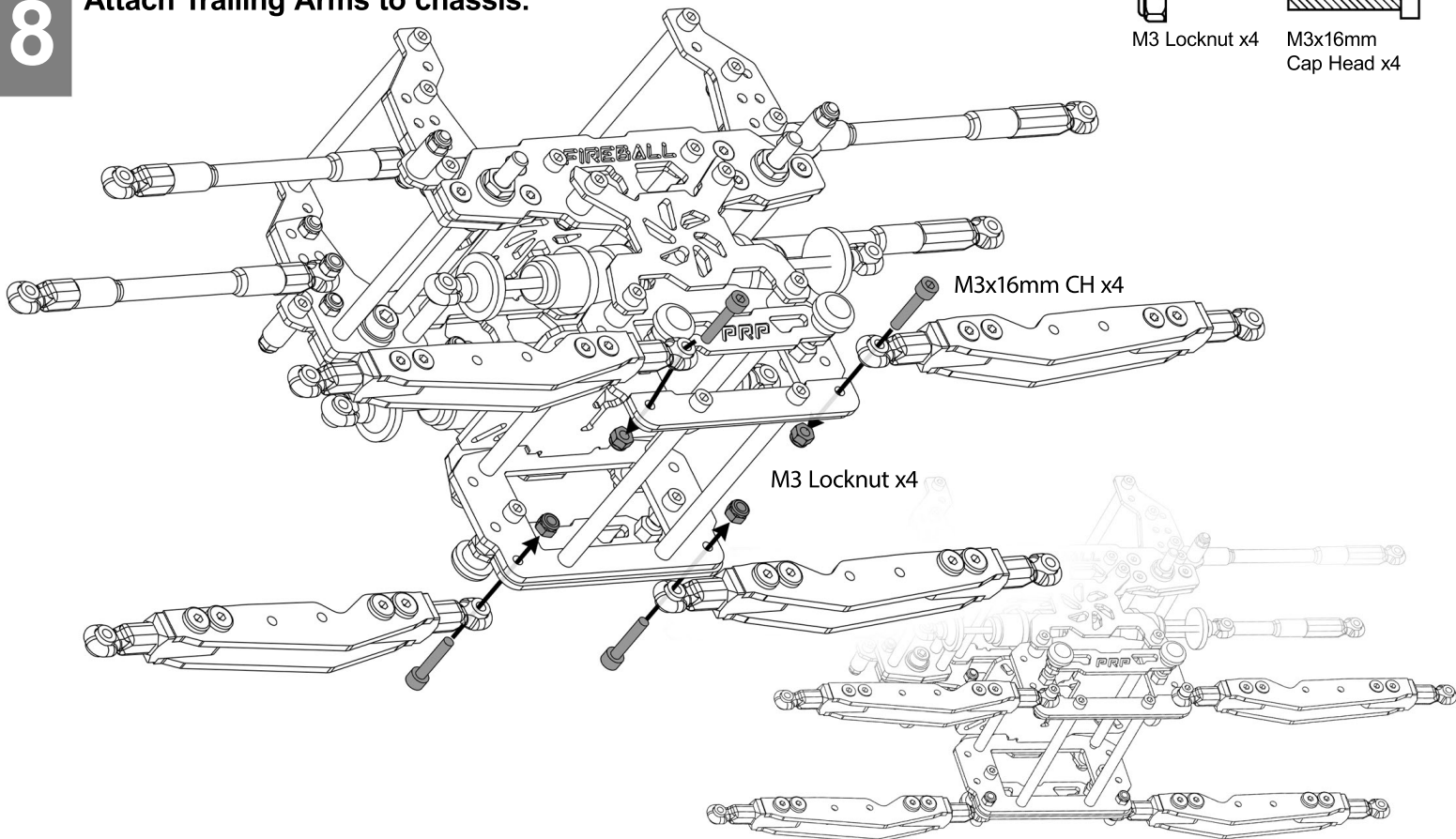
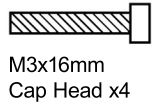

19

Fully seat Press Nuts with M3 screw and washer. Then remove screw and washer. Build two in each orientation for a total of four Rocker Arms.



M3 Press Nut x8

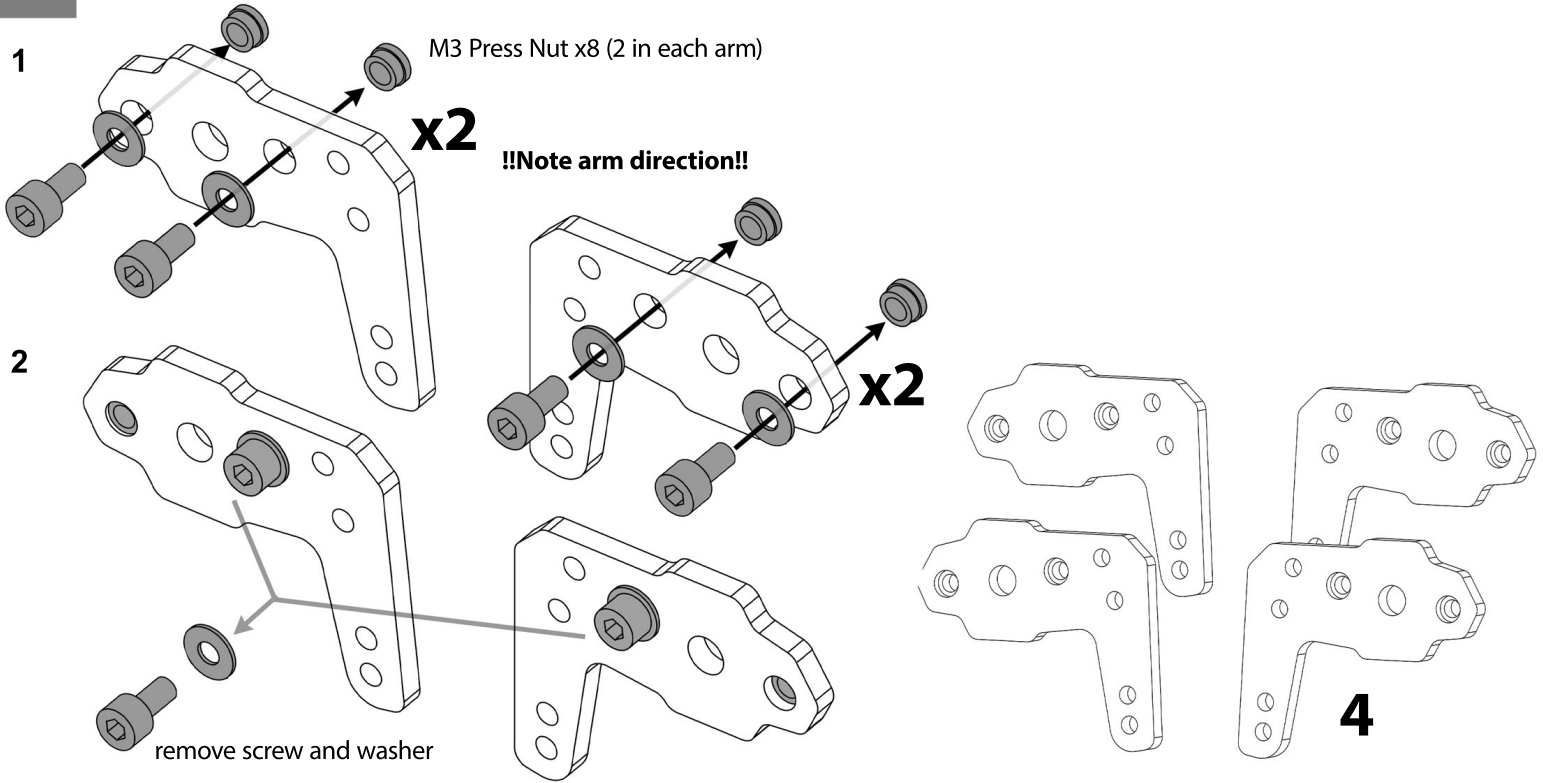

20

Assemble Rocker Arms x2 in each direction shown for a total of four arms.

- M3 Washer x8
- M3 Locknut x4
- M3x8mm Square Nut x4
- M3x8mm Spacer x8
- M3x16mm Flat Head x4
- M3x18mm Cap Head x8
- M3x6mm Cap Head x4

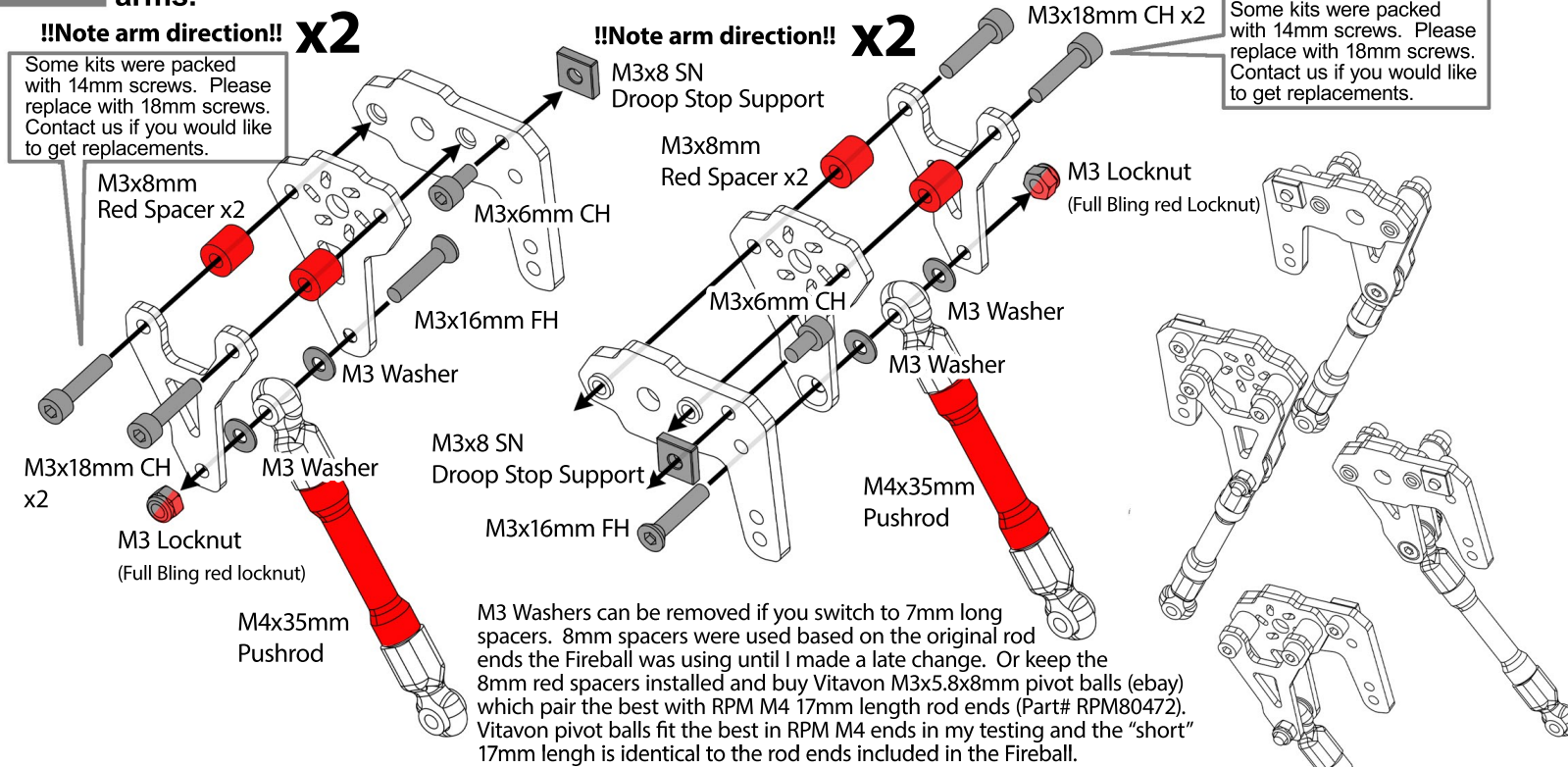

M3 Washers can be removed if you switch to 7mm long spacers. 8mm spacers were used based on the original rod ends the Fireball was using until I made a late change. Or keep the 8mm red spacers installed and buy Vitavon M3x5.8x8mm pivot balls (ebay) which pair the best with RPM M4 17mm length rod ends (Part# RPM80472). Vitavon pivot balls fit the best in RPM M4 ends in my testing and the "short" 17mm length is identical to the rod ends included in the Fireball.



M5 Locknut x4

21

Attach all four Rocker Arm assemblies in correct orientation. Use Hex Key to keep the M5 screw in place when tightening the M5 Locknuts.

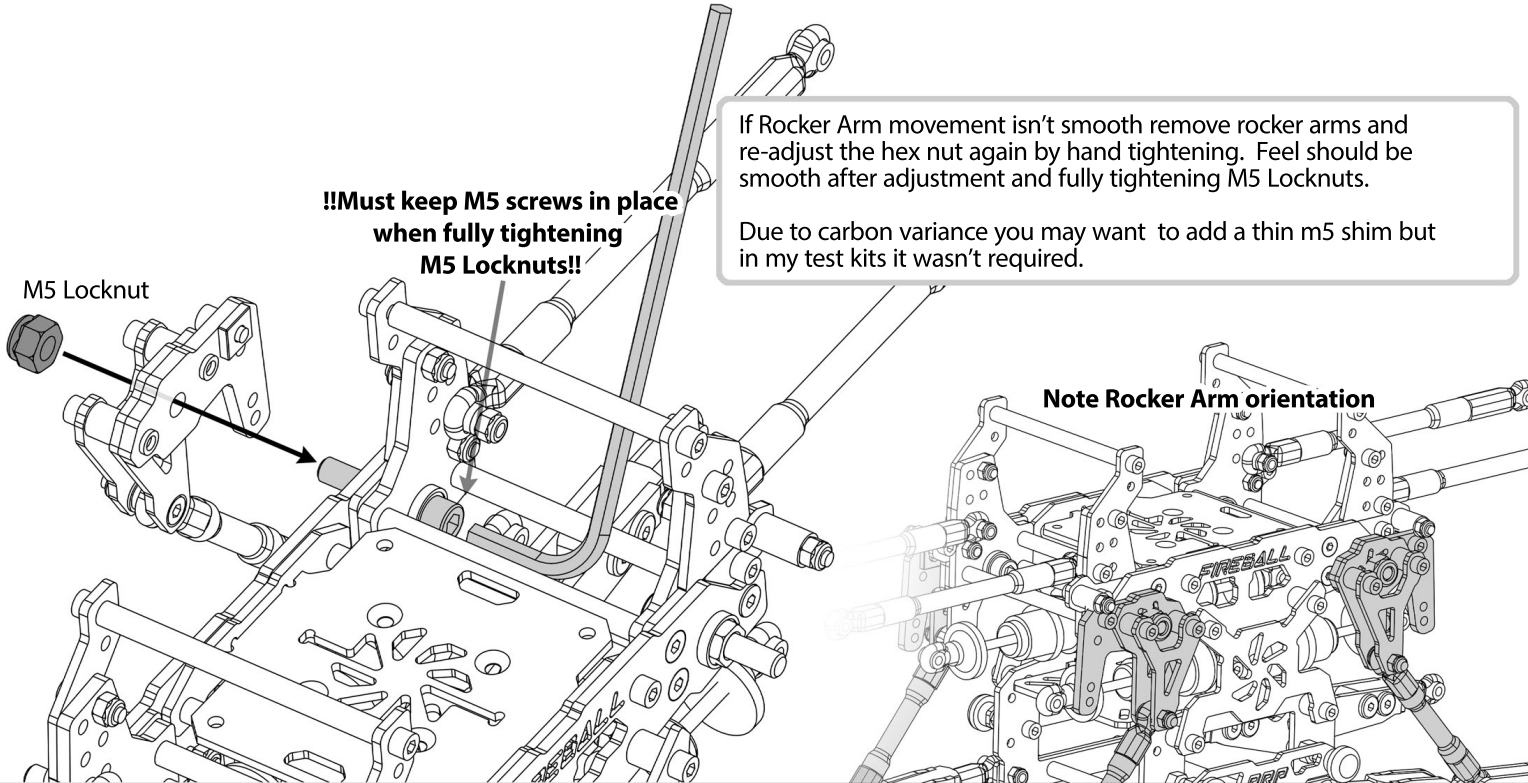

!!Must keep M5 screws in place when fully tightening M5 Locknuts!!

If Rocker Arm movement isn't smooth remove rocker arms and re-adjust the hex nut again by hand tightening. Feel should be smooth after adjustment and fully tightening M5 Locknuts.

Due to carbon variance you may want to add a thin m5 shim but in my test kits it wasn't required.

Note Rocker Arm orientation

22

Attach all four Pushrods to Trailing Arms.



M3 Washer x8



M3 Locknut x4



M3x18mm Cap Head x4

For an easier Pushrod washer install remove Trailing Arm plate.

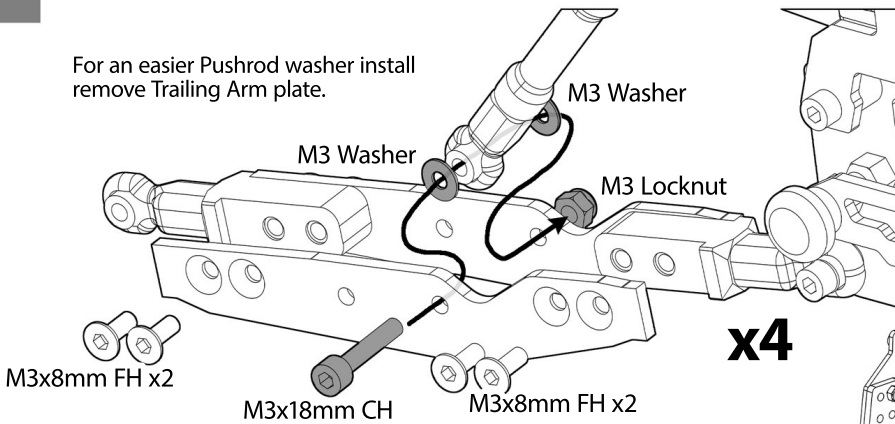

x4

Washers can be removed if you change to 8mm pivot balls. Vitavon makes 5.8x8mm Pivot Balls that work best in RPM brand Rod Ends (Traxxas short M4x17mm eye to end) in my testing.

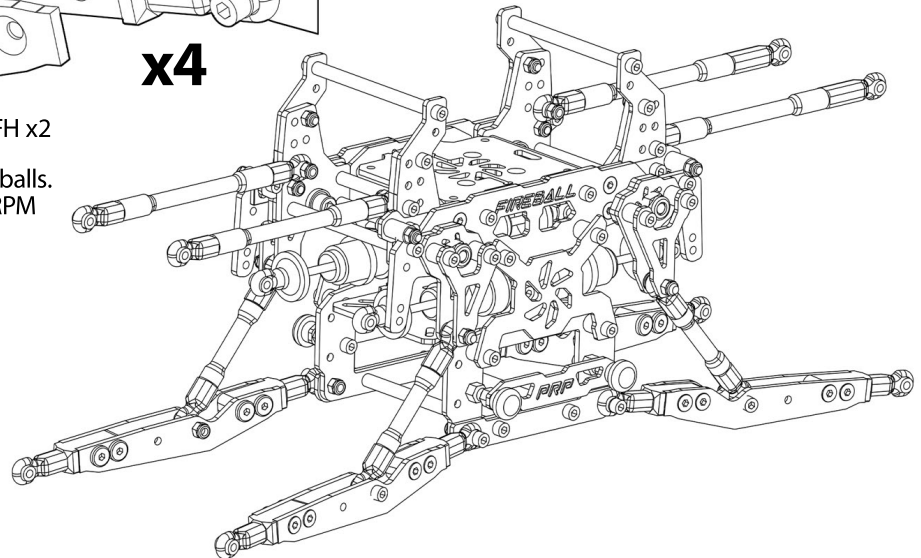

23

Attach all four Shock ends to Rocker Arms.



M3 Locknut x4



M3x1mm
Spacer x4



M3x16mm
Button Head x4

Rear shown. Attach front now as well.

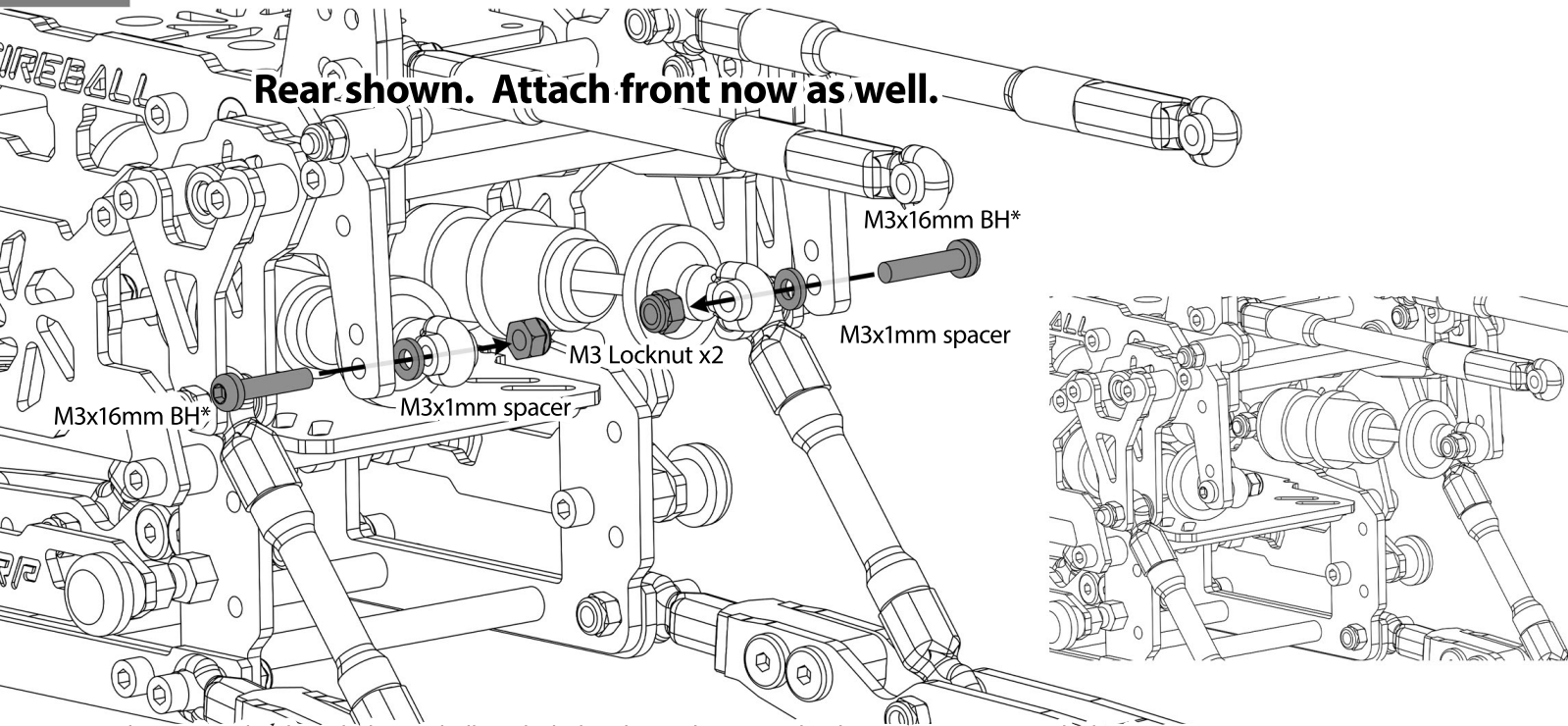

* When using the threaded pivot balls included in the Yeah Racing shocks you can use a much shorter screw without a Locknut. Team PRP also has Low Profile socket head screws available for purchase for this application.

24

Assemble four LCG Sway Bar Mounts and slide them over Sway Bars. Skip this step if you are using LMT Sway Bars.



M3x1mm
Spacer x4



M3 Shoulder
Bushing x4



M3 Locknut x4



M3x10mm
Cap Head x4

x2

Some early kits were missing this spacer. You may use spare washers or another similar spacer in it's place.

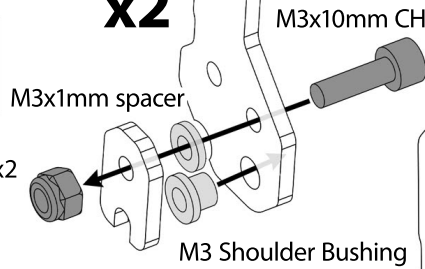

x2

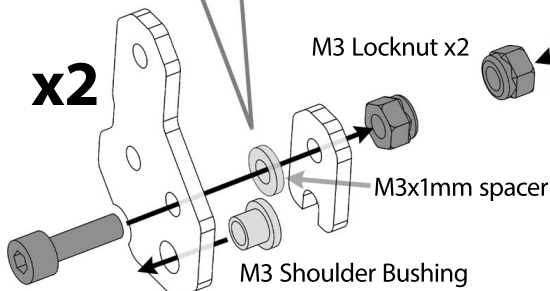

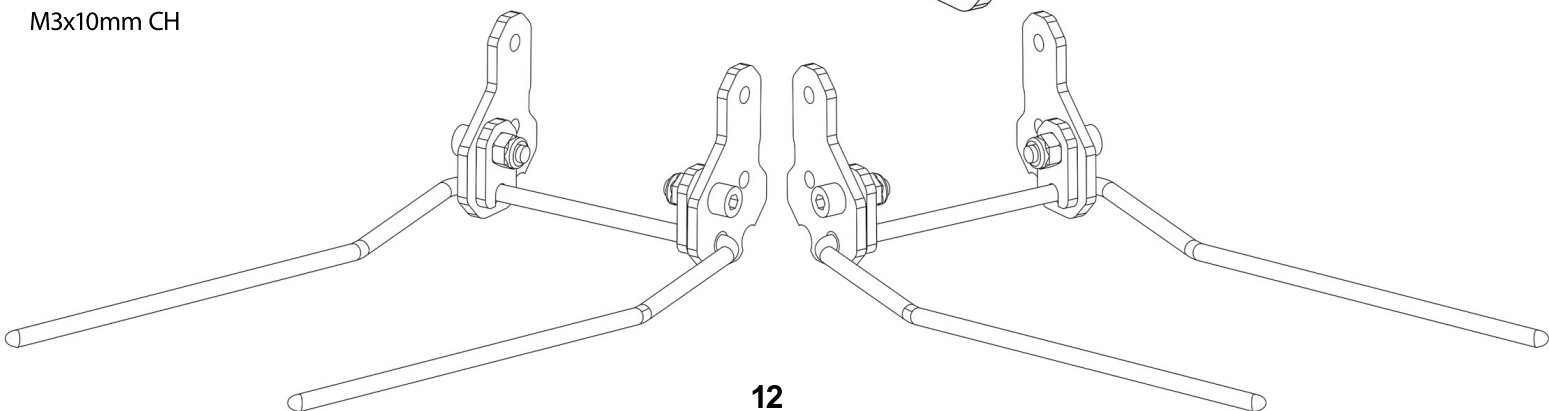

M3x10mm CH



25

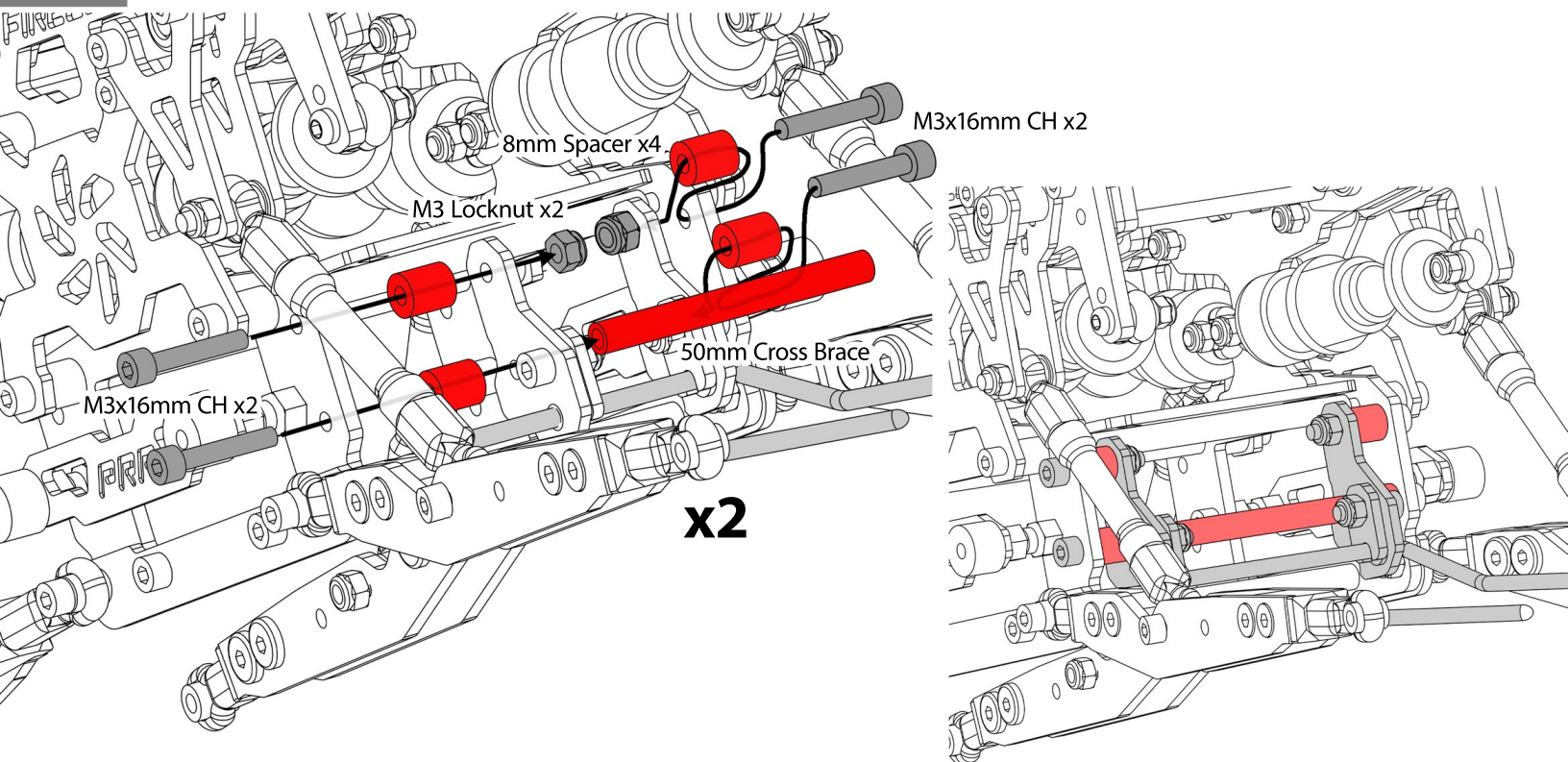

Attach front and rear LCG Sway Bars. Skip this step if you are using LMT Sway Bars.

-  M3 Locknut x4
-  M3x8mm Red Spacer x8
-  M3x16mm Cap Head x8



26

Begin assembling the FAST (Fireball Axle System Tech) Front Axle System.

-  M3x10mm Cap Head x2
-  M3x10mm Flat Head x4

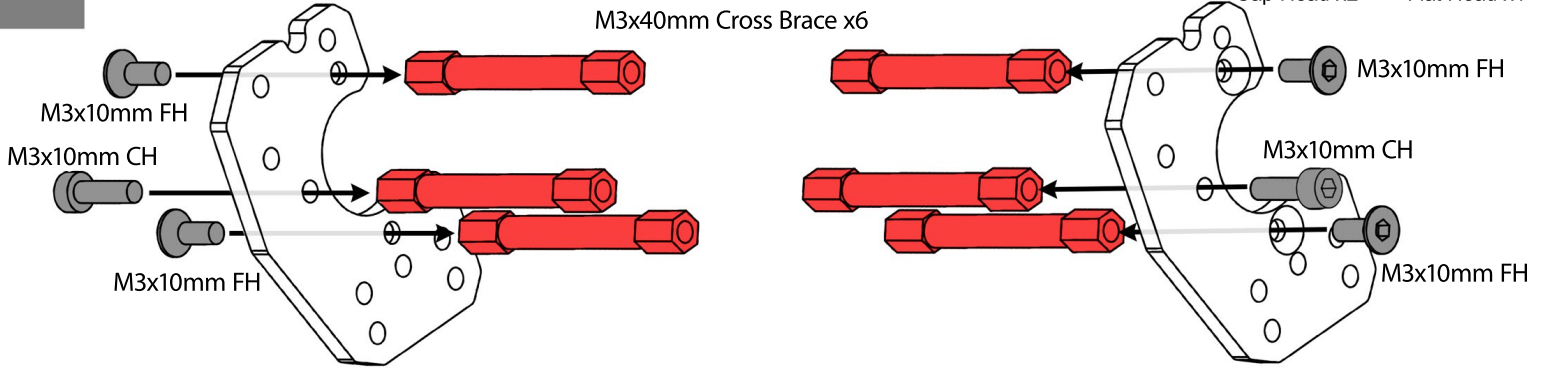

!! Mount the upper and lower cross braces so the hex is aligned perfectly straight !!

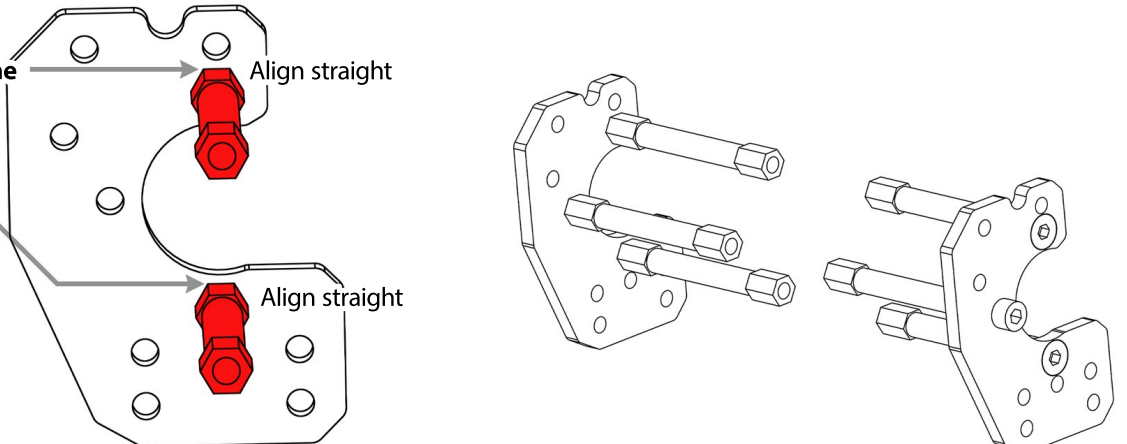

27

1. Attach Trailing Arm screws and M3 Rod Ends.
2. Install assemblies to Clod Axle Tubes.



M3x7mm Plastic Spacer x4



M3 Locknut x4



M3 Hex Nut x4



M3 Washer x4



M3x20mm Cap Head x2

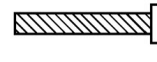

M3x18mm Cap Head x4



M3x14mm Cap Head x2

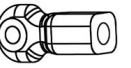

M3 Rod End x2

1

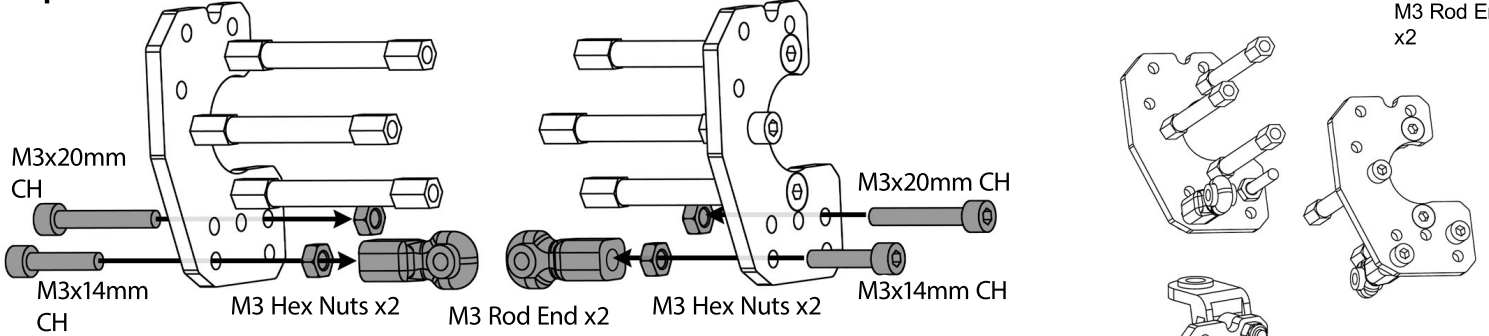

2

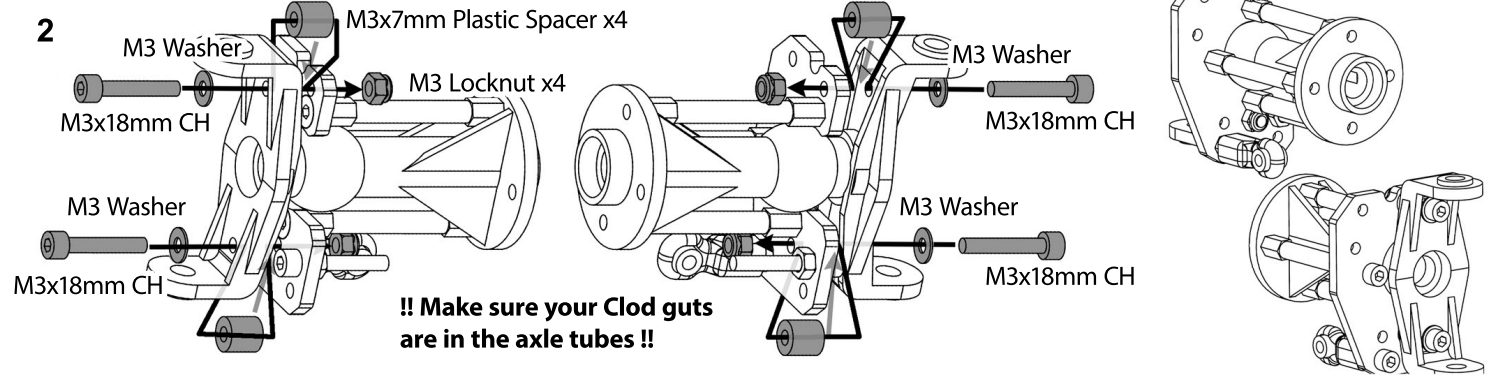

28

1. Attach Axle Tubes to Gear Box and assemble gear boxes as instructed by the Tamiya ClodBuster manual.



M3 Locknut x2



M3x16mm Button Head x6



M3x12mm Button Head x2

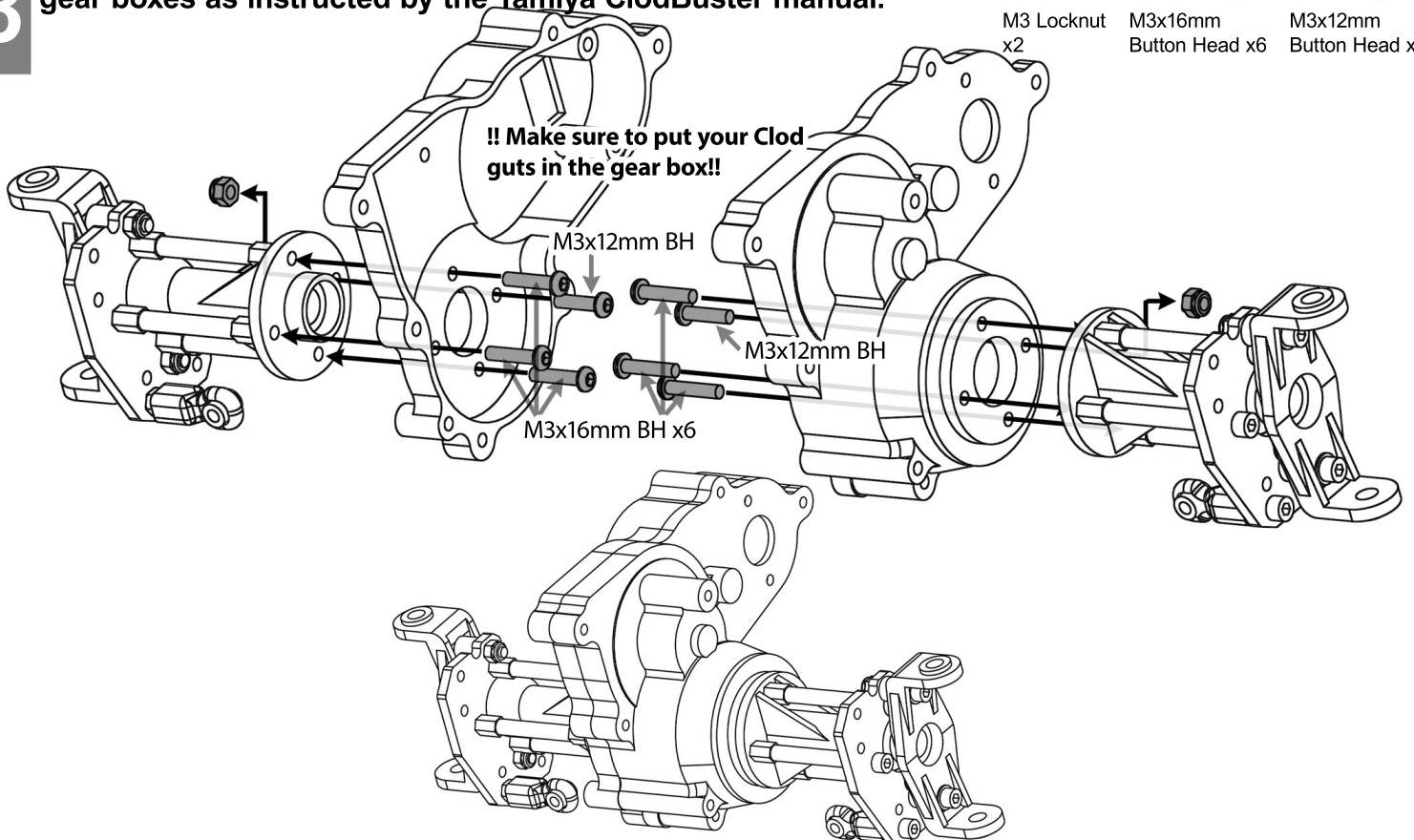

29

1. Install Inner Servo Mount.
2. Install Servo Spacer and Servo.

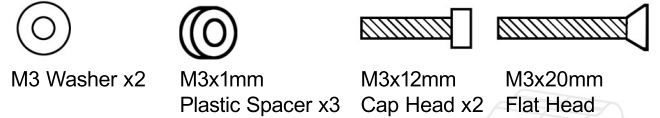

1

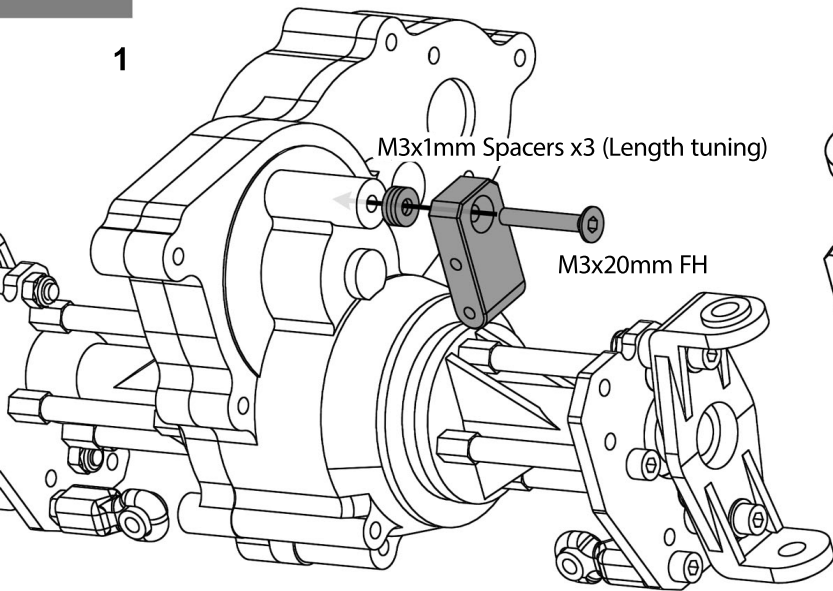

2

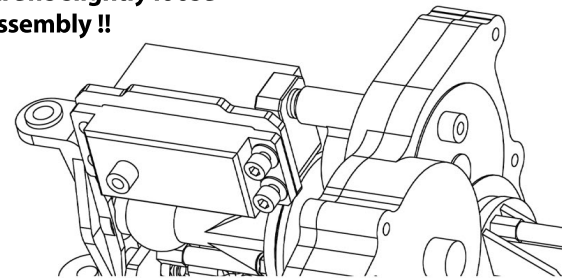
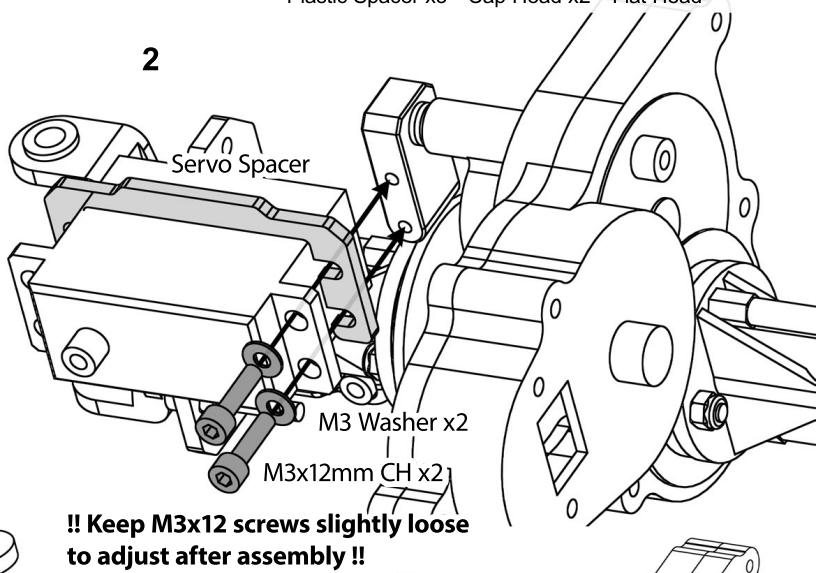

30

1. Assemble Outer Servo Mount.
2. Attach Servo to Outer Servo Mount.
3. Attach Servo Mount Arm to Axle Mount Plate.

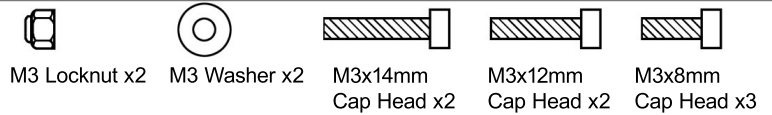

1

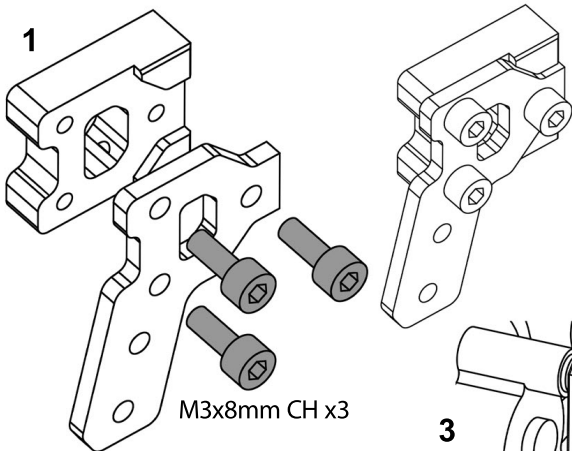

2

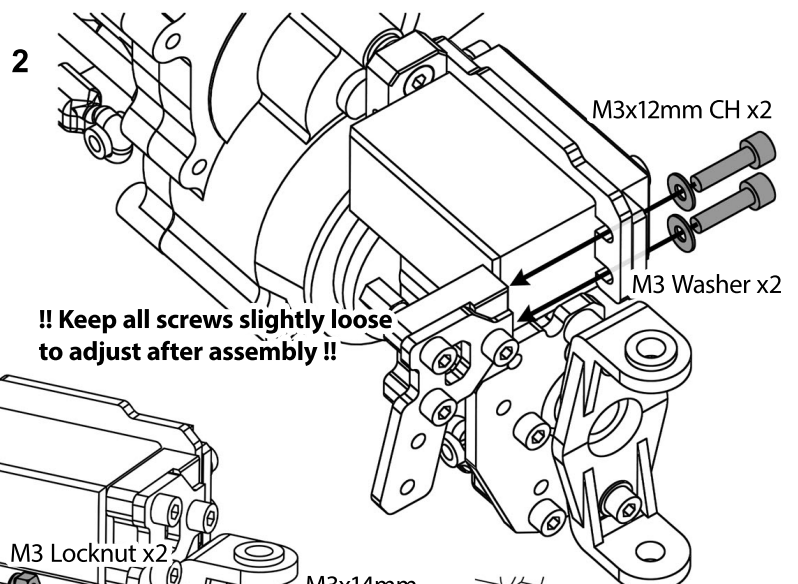

3

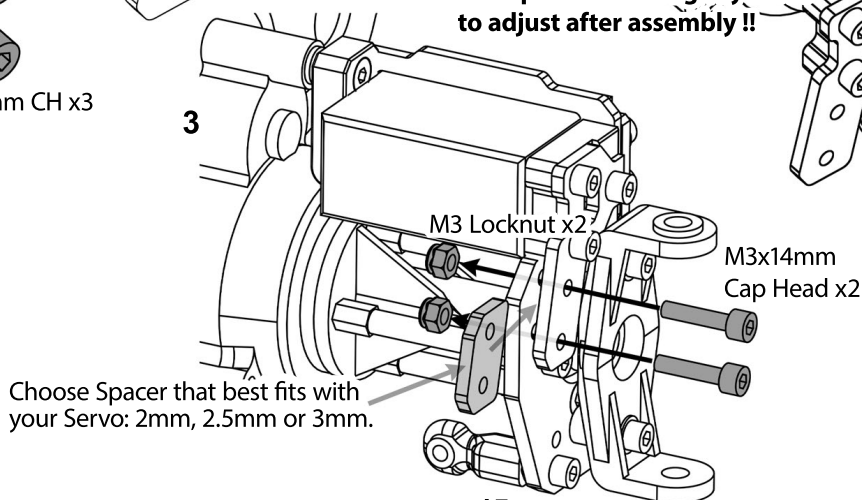

**Center up
and tighten
all screws**

31

Assemble and install Servo link and Drag Link. Attach your Servo Saver or arm of choice

-  M3 Locknut x3
-  M3x6mm Standoff
-  M4x25mm Set Screw
-  M3x9mm Silver Washer x2
-  M3x0.5mm Shim x2
-  M3x20mm Cap Head
-  M3x12mm Button Head

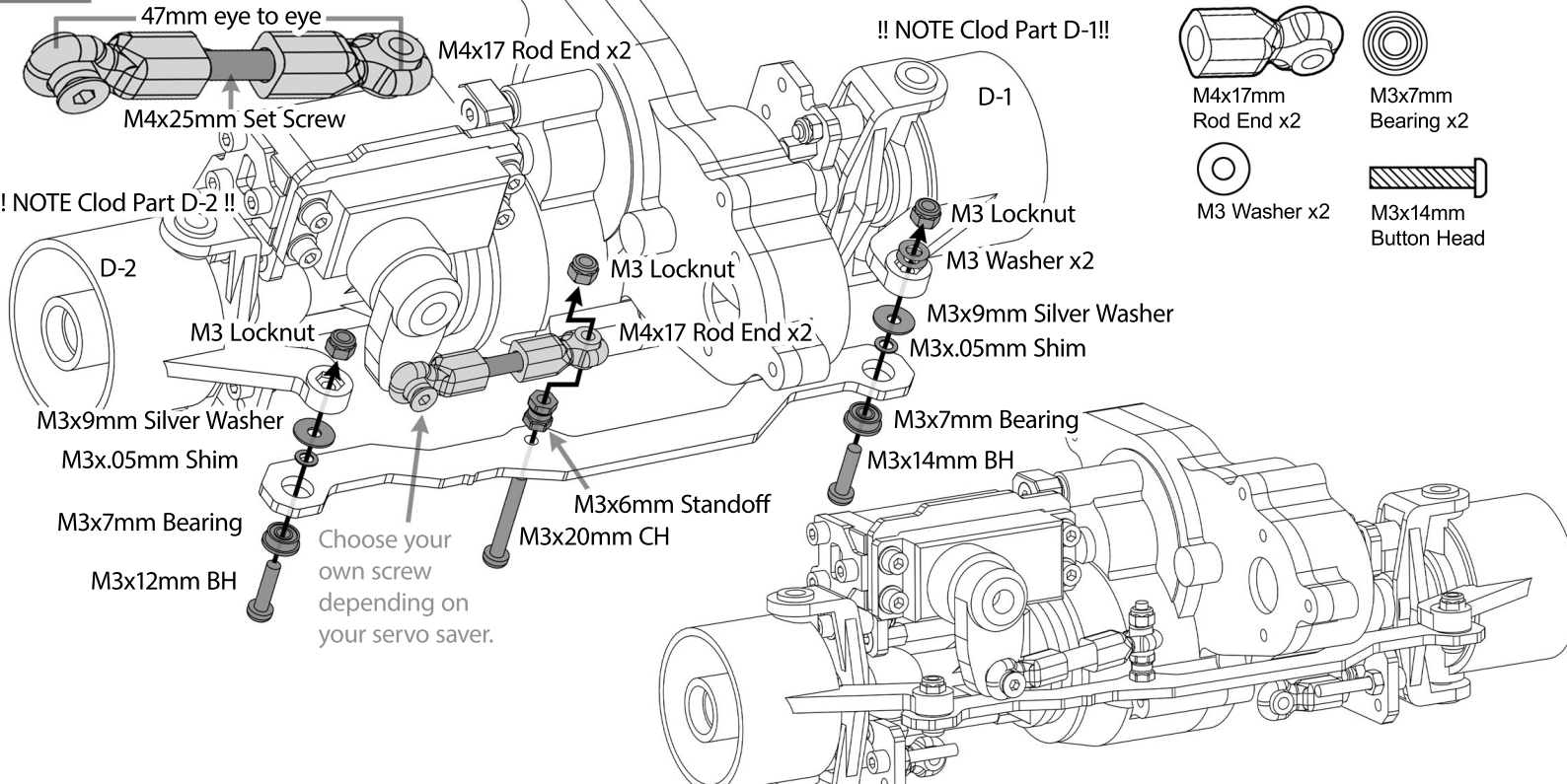

32

Begin assembling the FAST (Fireball Axle System Tech) Rear Axle System.

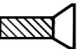
-  M3x10mm Cap Head x4
-  M3x10mm Flat Head x4

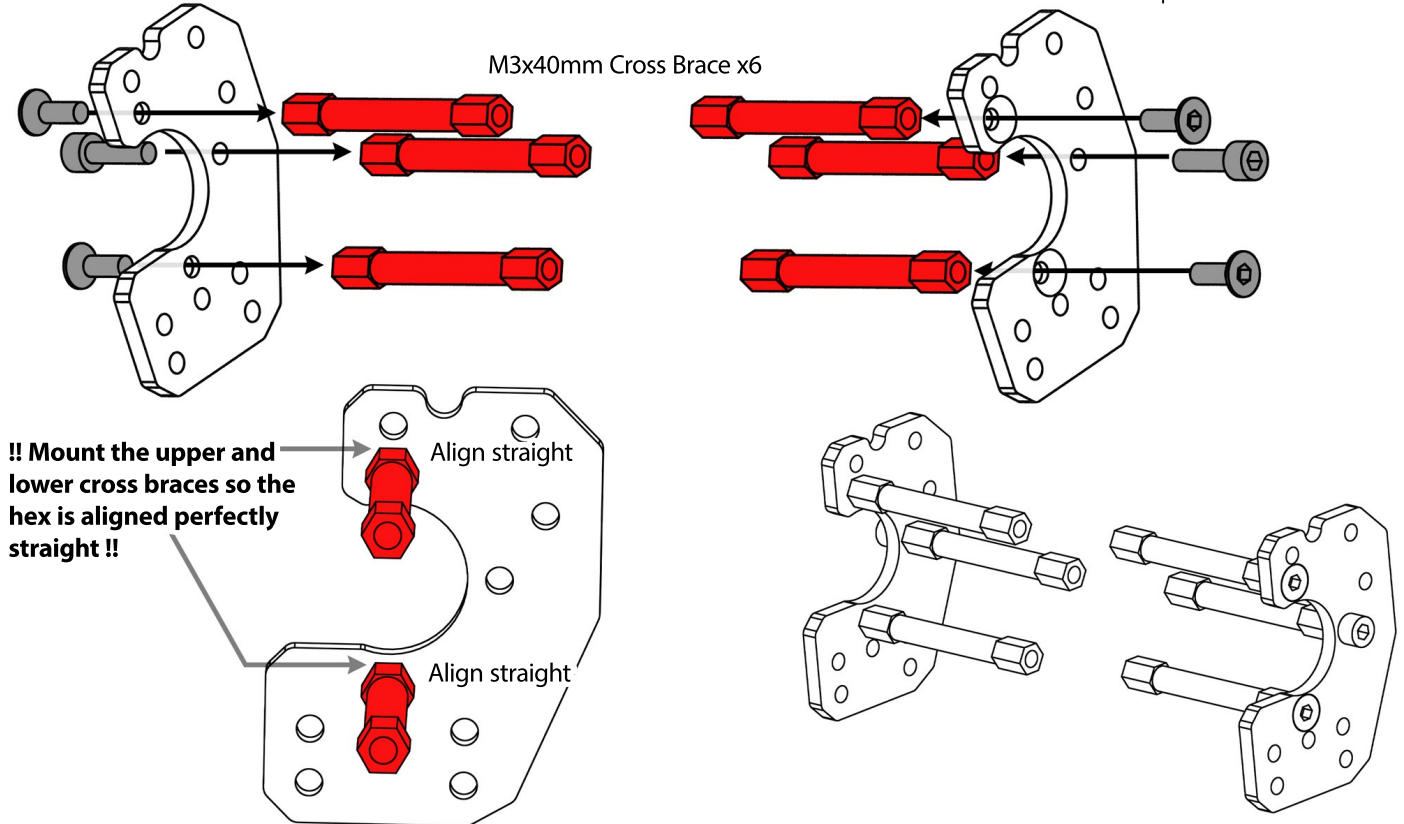

33

1. Attach Trailing Arm screws and M3 Rod Ends.
2. Install assemblies to Clod Axle Tubes.



M3x7mm Plastic Spacer x4



M3 Locknut x4



M3 Hex Nut x4



M3 Washer x4

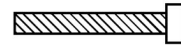

M3x20mm Cap Head x2



M3x18mm Cap Head x4



M3x14mm Cap Head x2

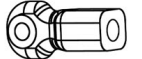

M3 Rod End x2

1

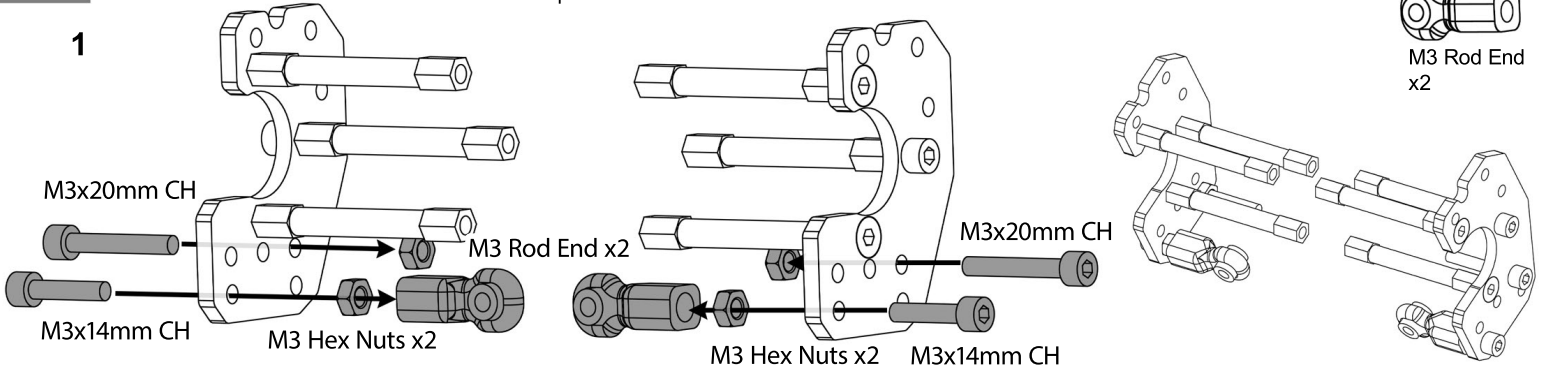

2

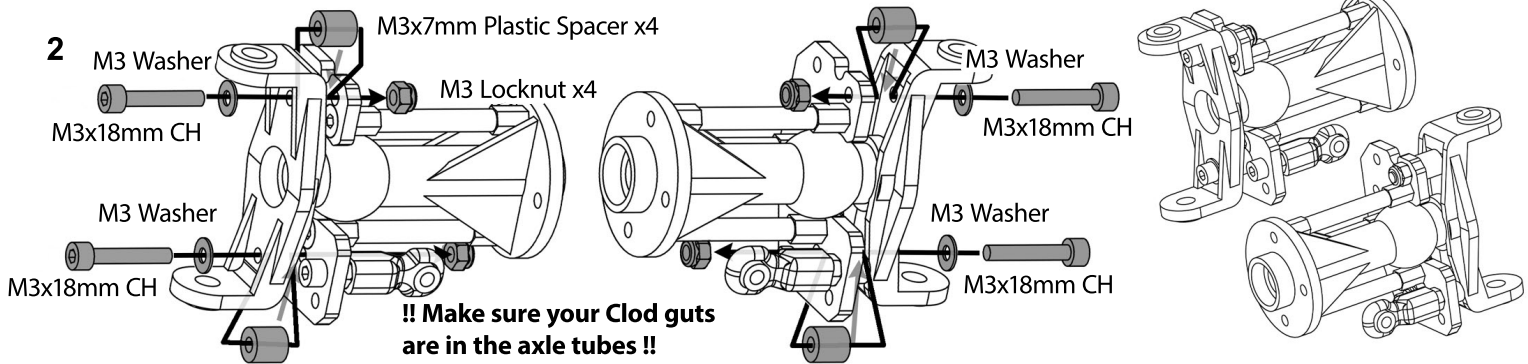

34

1. Attach Axle Tubes to Gear Box and assemble gear boxes as instructed by the Tamiya ClodBuster manual.



M3 Locknut x2



M3x16mm Button Head x6



M3x12mm Button Head x2

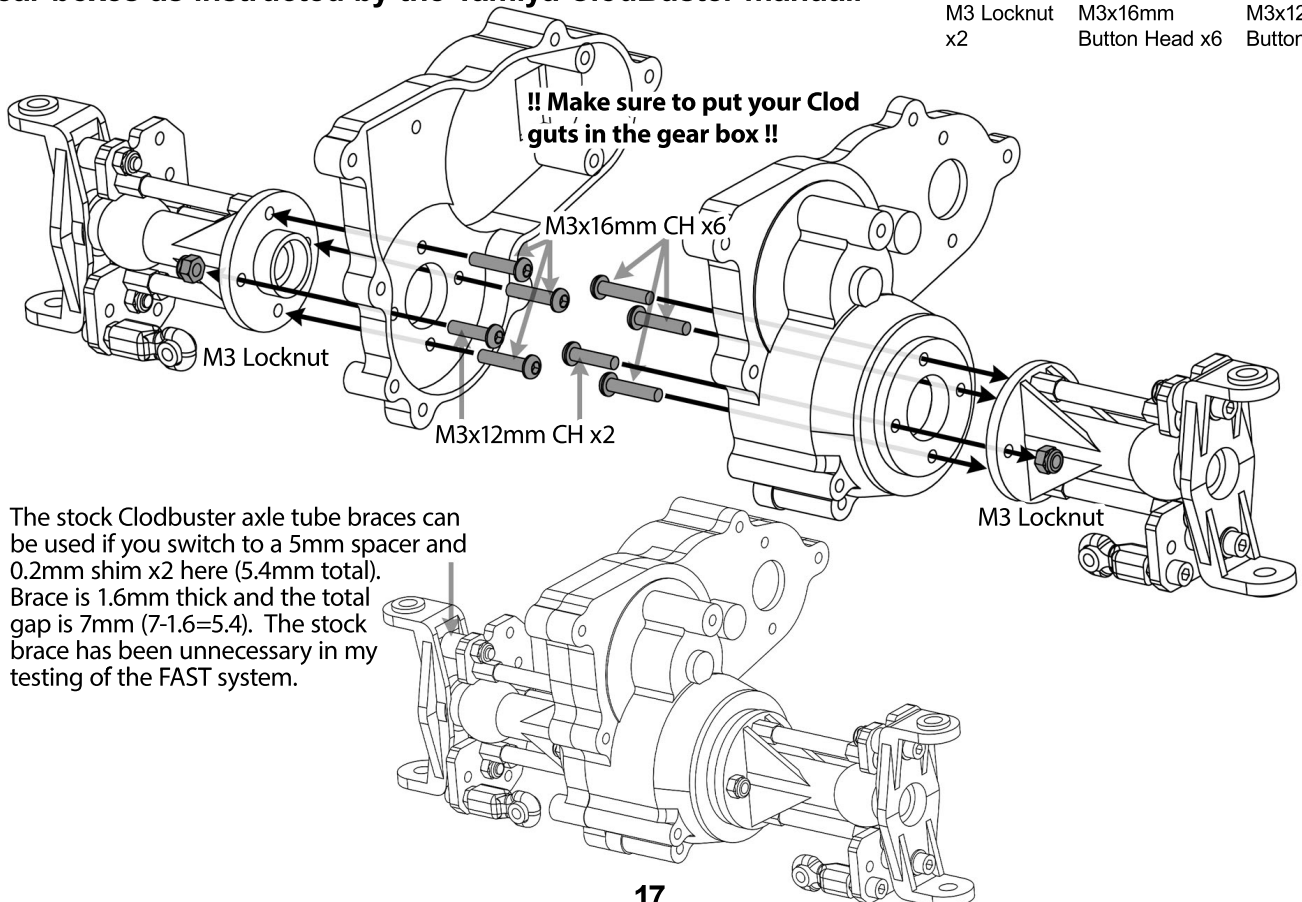

The stock Clodbuster axle tube braces can be used if you switch to a 5mm spacer and 0.2mm shim x2 here (5.4mm total). Brace is 1.6mm thick and the total gap is 7mm (7-1.6=5.4). The stock brace has been unnecessary in my testing of the FAST system.

35

- !! SKIP Step if installing the Rear Lockout !!**
1. Install Inner Servo Mount.
2. Attach Servo Spacer and Servo.

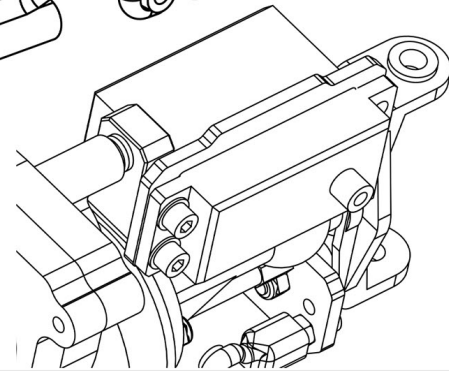
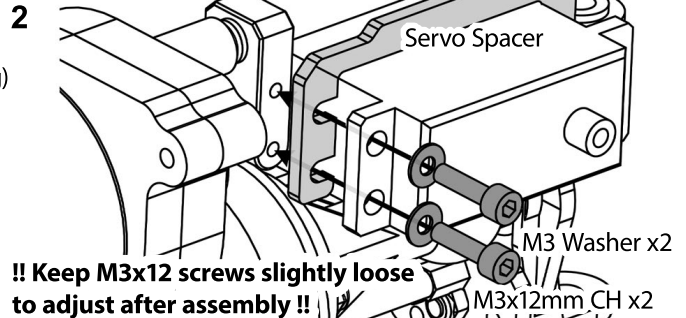
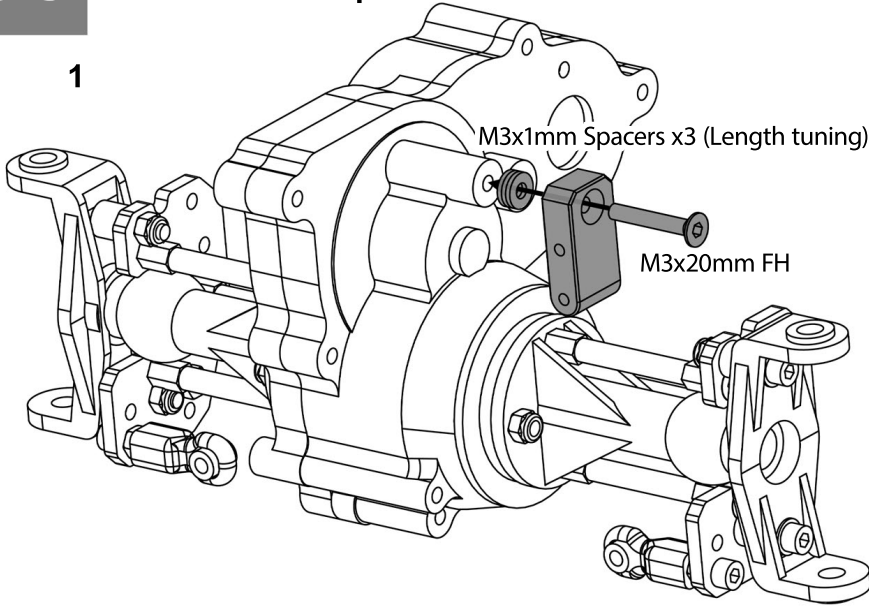
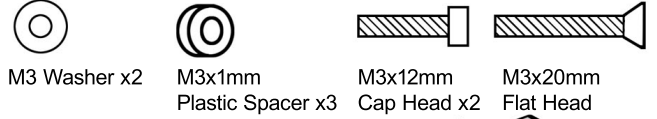

36

- !! SKIP Step if installing the Rear Lockout !!**
1. Assemble Outer Servo Mount.
2. Attach Servo to Outer Servo Mount and Servo Mount Arm to Axle Mount Plate.

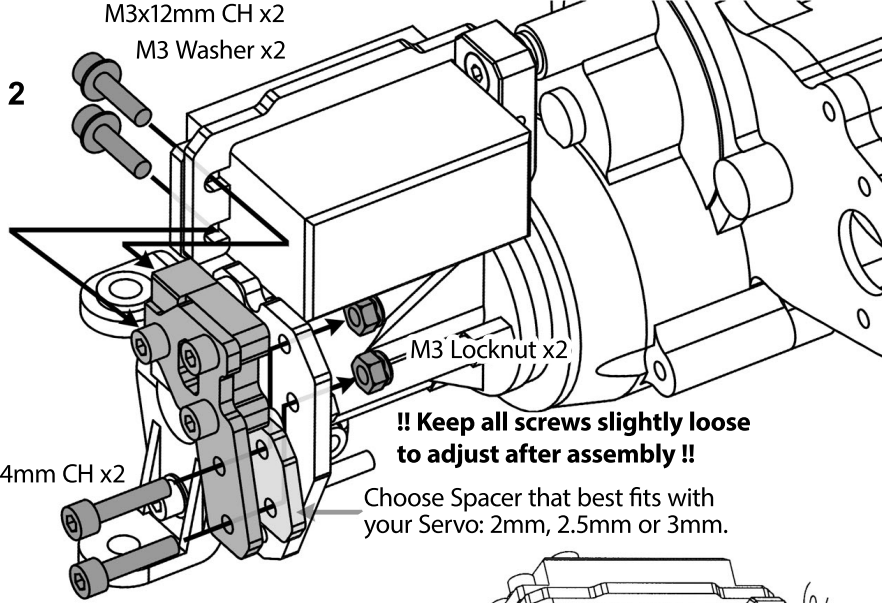
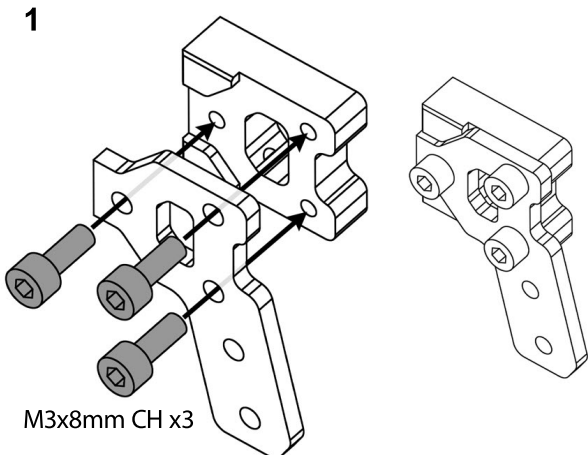
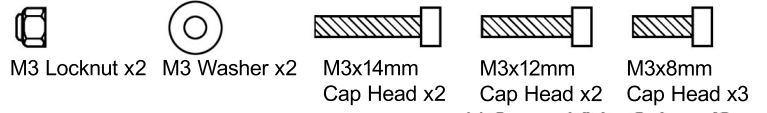

Center up and tighten all screws

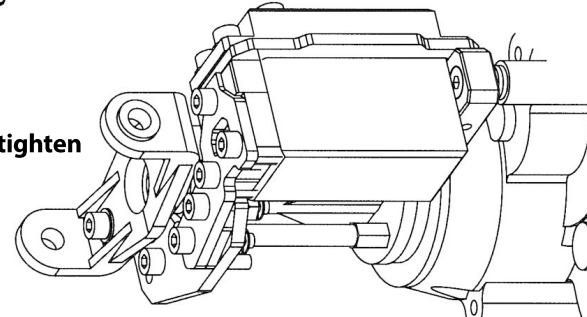

37

**!!SKIP step if you will be using the Rear Lockout!!
Assemble Rear Drag Link.**



M3x6mm Standoff



M2.5 Locknut x2



M3x22mm Cap Head

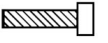

M2.5x10mm Cap Head x2

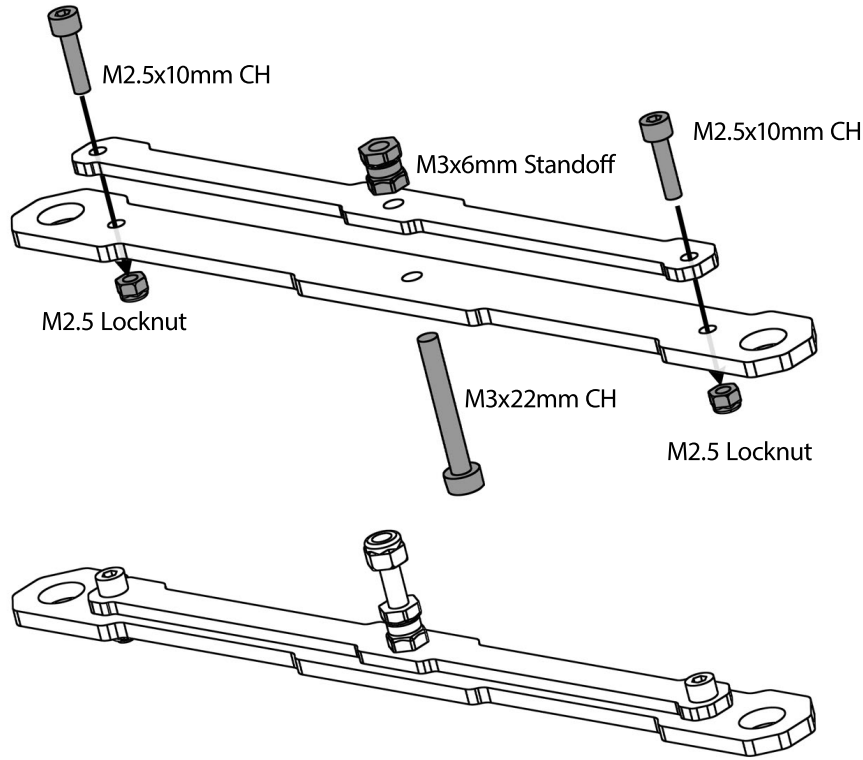

38

**!!SKIP step if you will be using the Rear Lockout!!
Attach Rear Drag Link.**

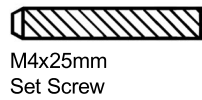

M4x25mm Set Screw



M3x9mm Silver Washer x2



M3x0.5mm Shim x2

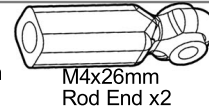

M4x26mm Rod End x2



M3x14mm Cap Head



M3x12mm Cap Head

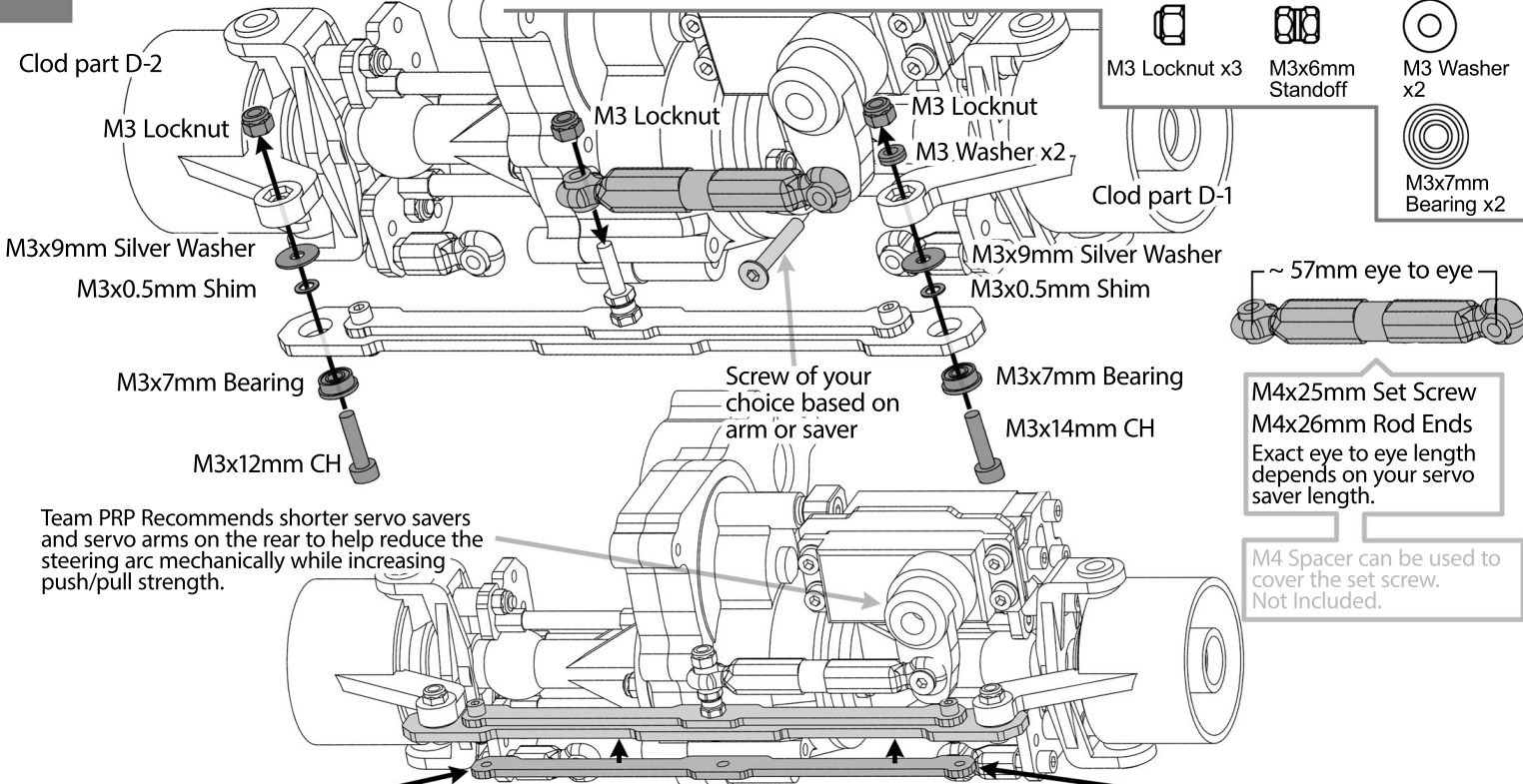

Team PRP Recommends shorter servo savers and servo arms on the rear to help reduce the steering arc mechanically while increasing push/pull strength.







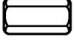

M4x25mm Set Screw
M4x26mm Rod Ends
Exact eye to eye length depends on your servo saver length.

M4 Spacer can be used to cover the set screw. Not included.

!! If your servo saver or arm is too long you may mount the Drag Link Brace on the bottom of the linkage !!

39

Install Front & Rear Fireball M5 Upper Link Mounts.

								
M3 Locknut x6	9mm Brass Hex x2	7mm Brass Hex x2	6mm Brass Hex x2	0.5mm Shim x4	0.2mm Shim x4	0.1mm Shim x2	M3x38mm Cap Head x2	M3x28mm Cap Head x4

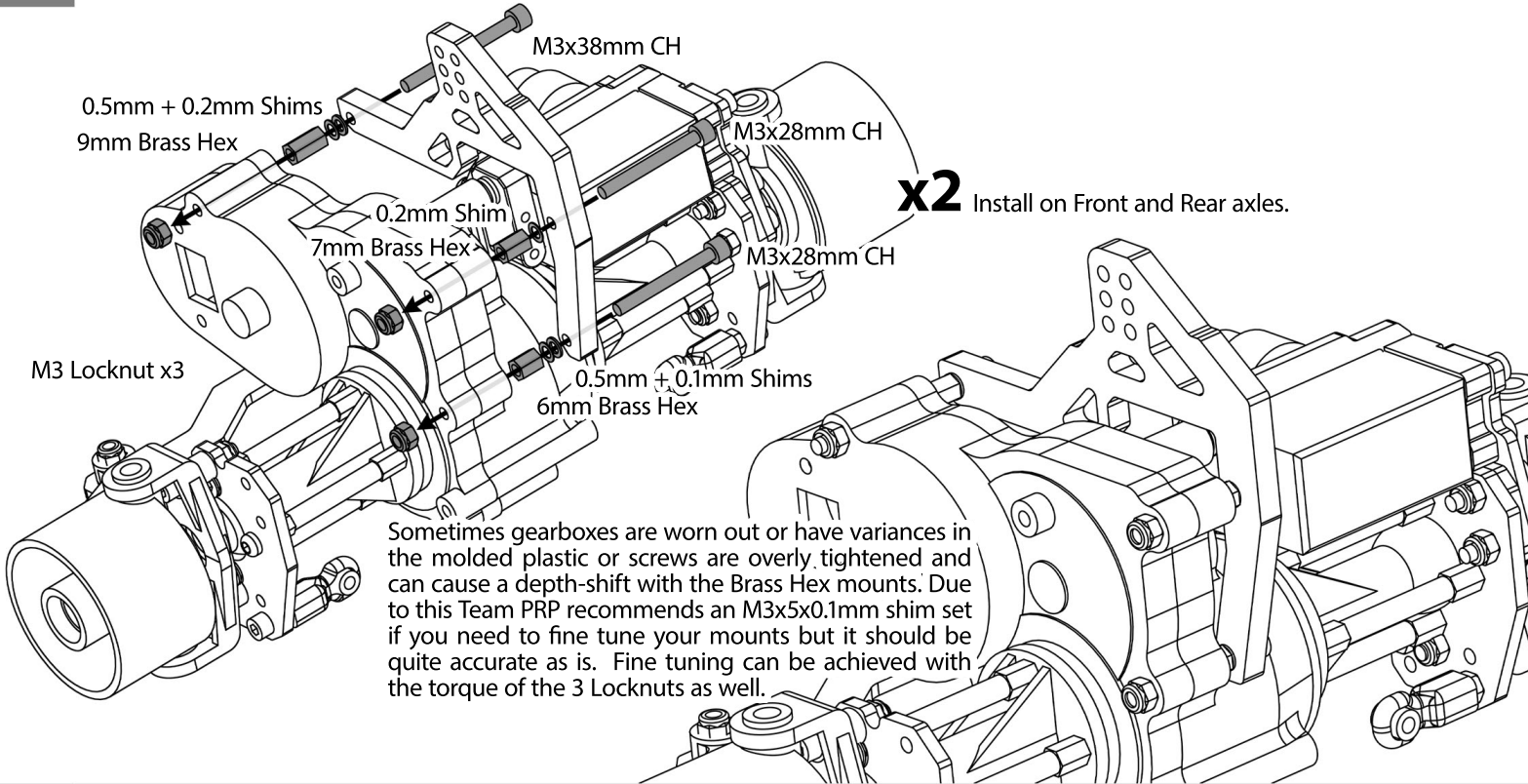

Sometimes gearboxes are worn out or have variances in the molded plastic or screws are overly tightened and can cause a depth-shift with the Brass Hex mounts. Due to this Team PRP recommends an M3x5x0.1mm shim set if you need to fine tune your mounts but it should be quite accurate as is. Fine tuning can be achieved with the torque of the 3 Locknuts as well.

40

Attach front and rear axles to chassis. Pay attention the front Upper Links have the short rod ends on each link and the Rear has 1 short and 1 long per link.

		
M3 Locknut x6	M3x3mm Plastic Spacer x4	M3x25mm Cap Head x2

1 Slide Sway Bars through M3 Rod Ends. Add the optional 3mm Spacer onto the mounting screw followed by the Trailing Arms and secure with the M3 Locknuts on both front and rear axles.

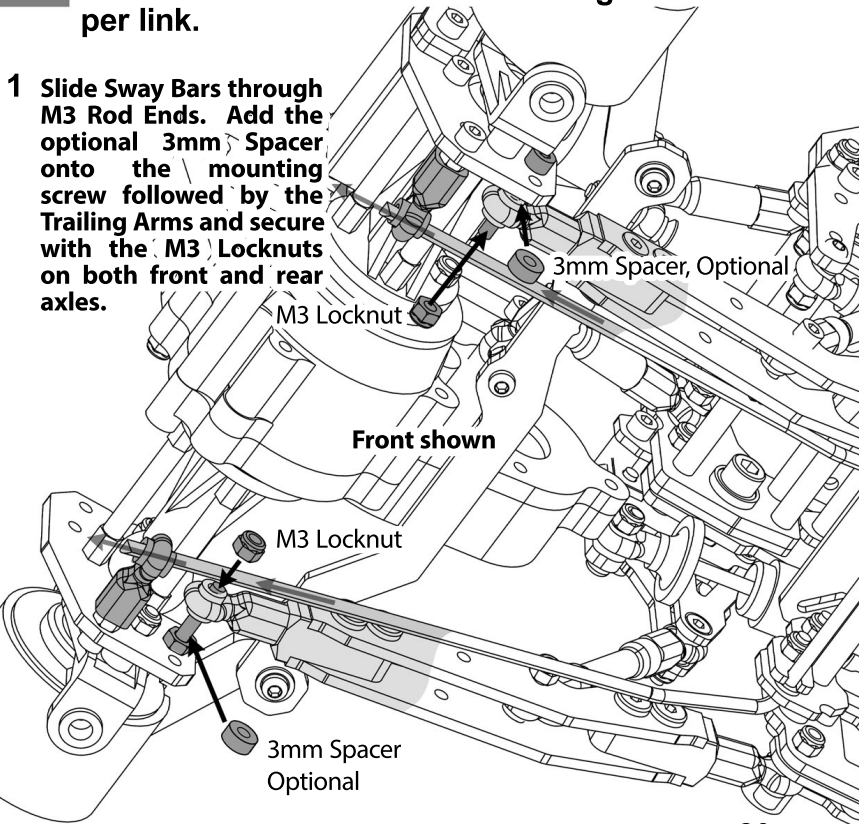

2 Mount Upper Links to inside column, middle hole on the Upper Link Mounts on both front and rear axles.

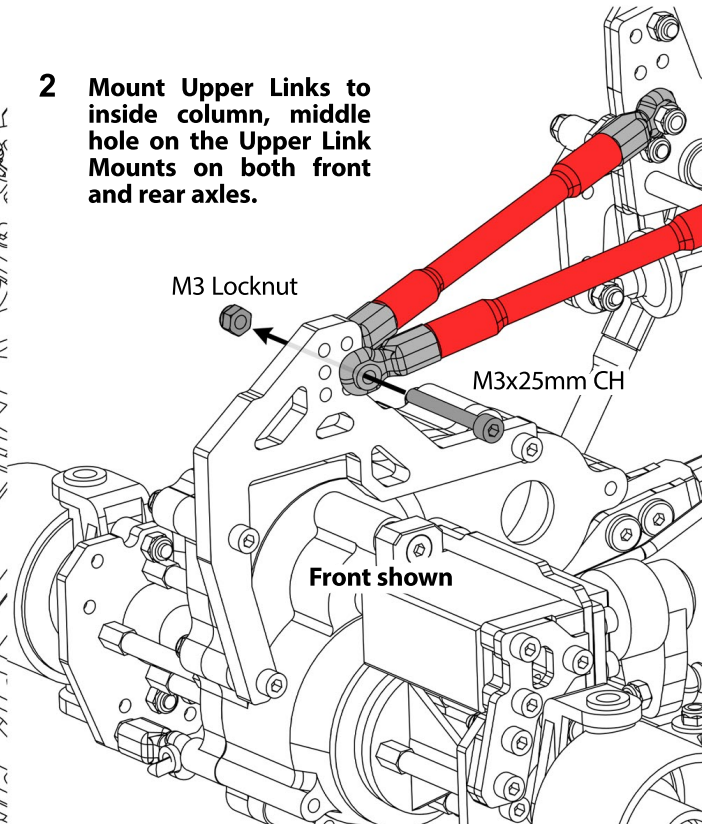

41

Rear Lockout Install

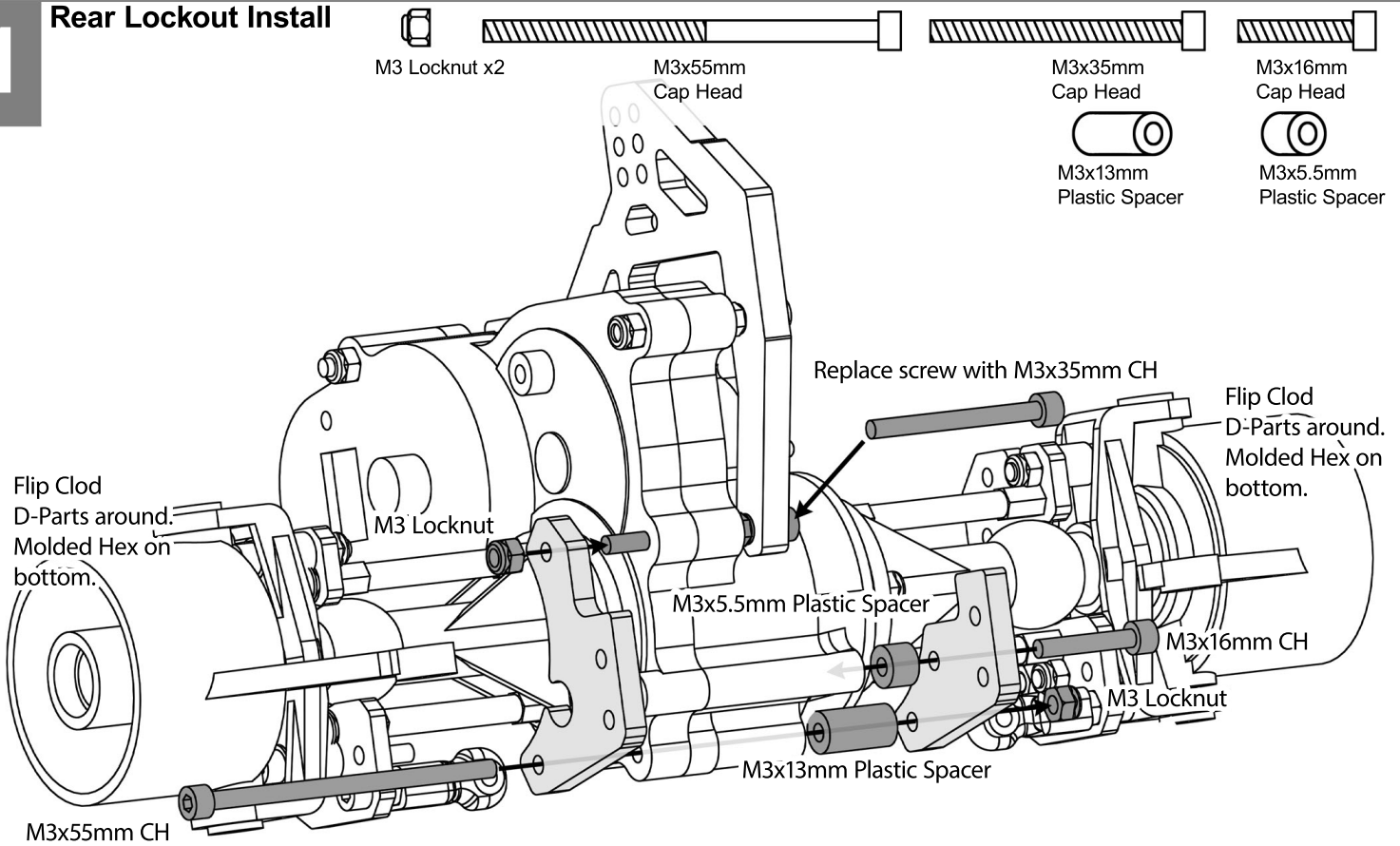

42

Rear Lockout Install

-  M4x20mm Set Screw x4
-  M3 Hex Nut x2
-  M3 Locknut x4
-  M3 Washer x4
-  M3x20mm Cap Head x2
-  M3x18mm Cap Head
-  M3x16mm Cap Head
-  M3x12mm Cap Head x4

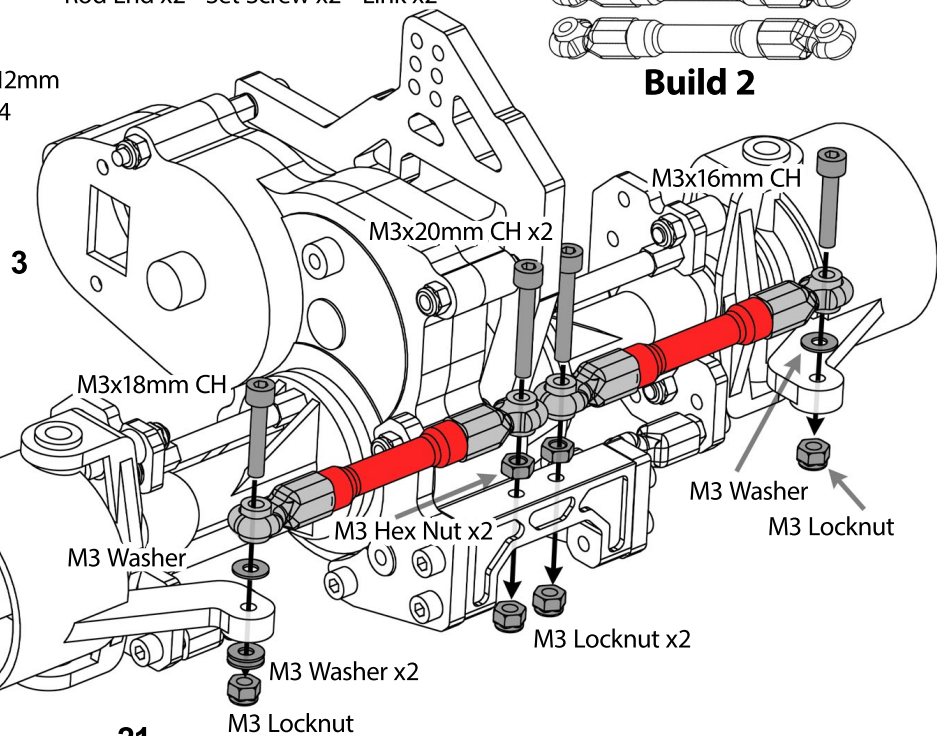
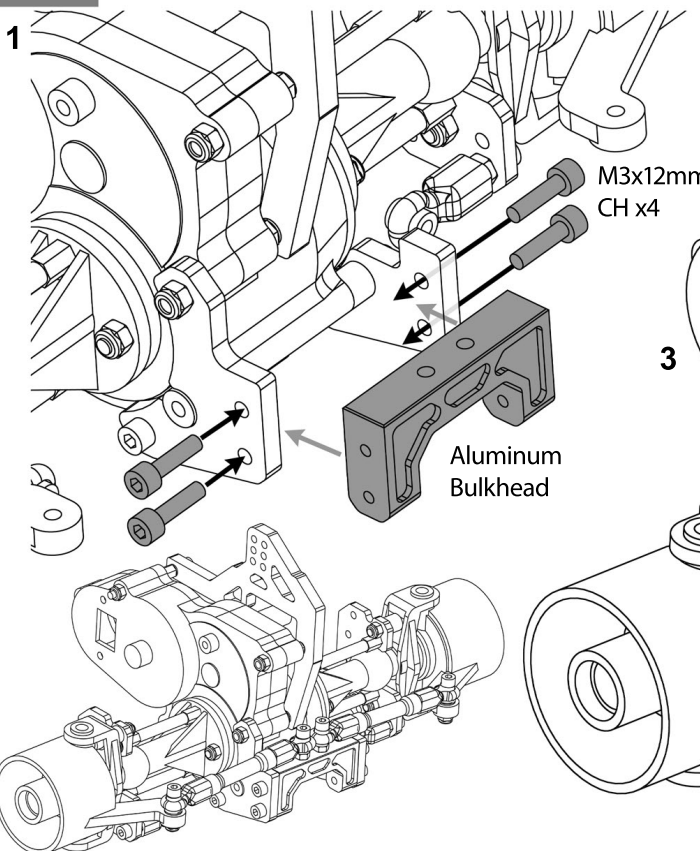

43

Options using Losi LMT parts.

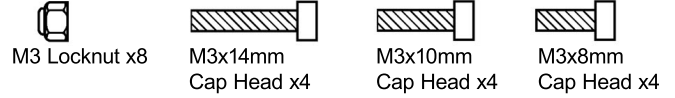

1 LMT Sway Bar Mounting Tabs x4

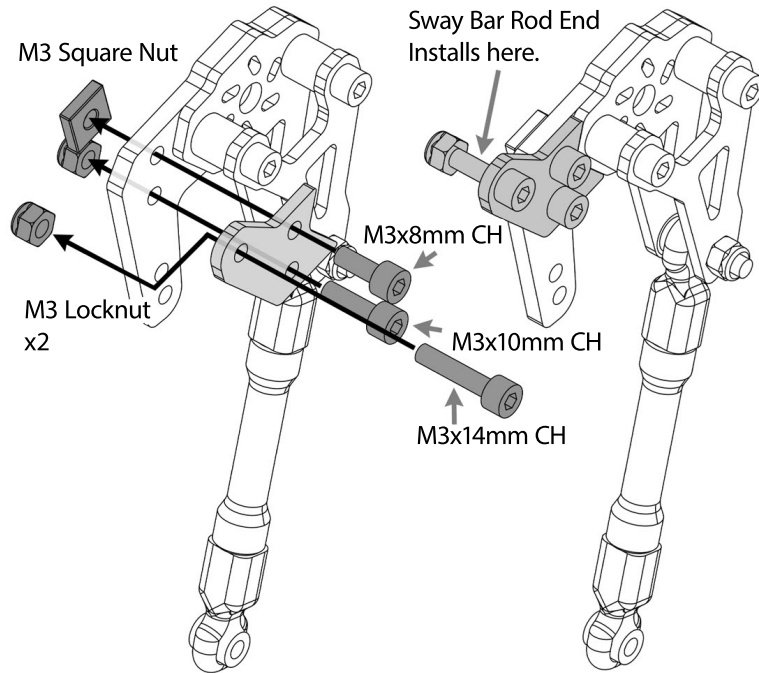

Build 4

2 Losi LMT 60x10mm Cross Braces can be used (or LMT aftermarket).
(Treal, Hot Racing, etc.)

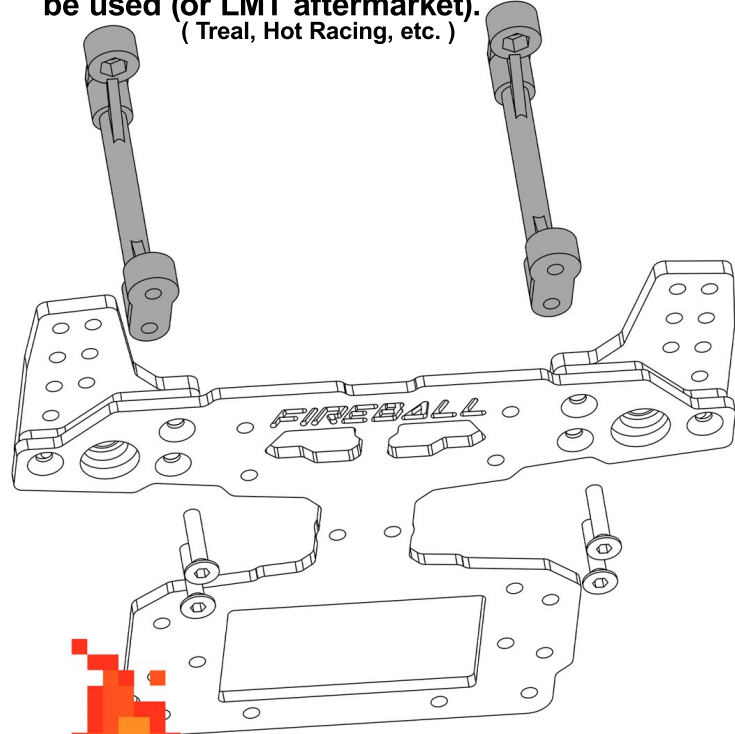

44

Gaze upon your build. . .

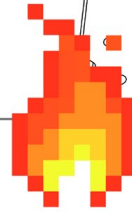

// Set up sheet coming soon

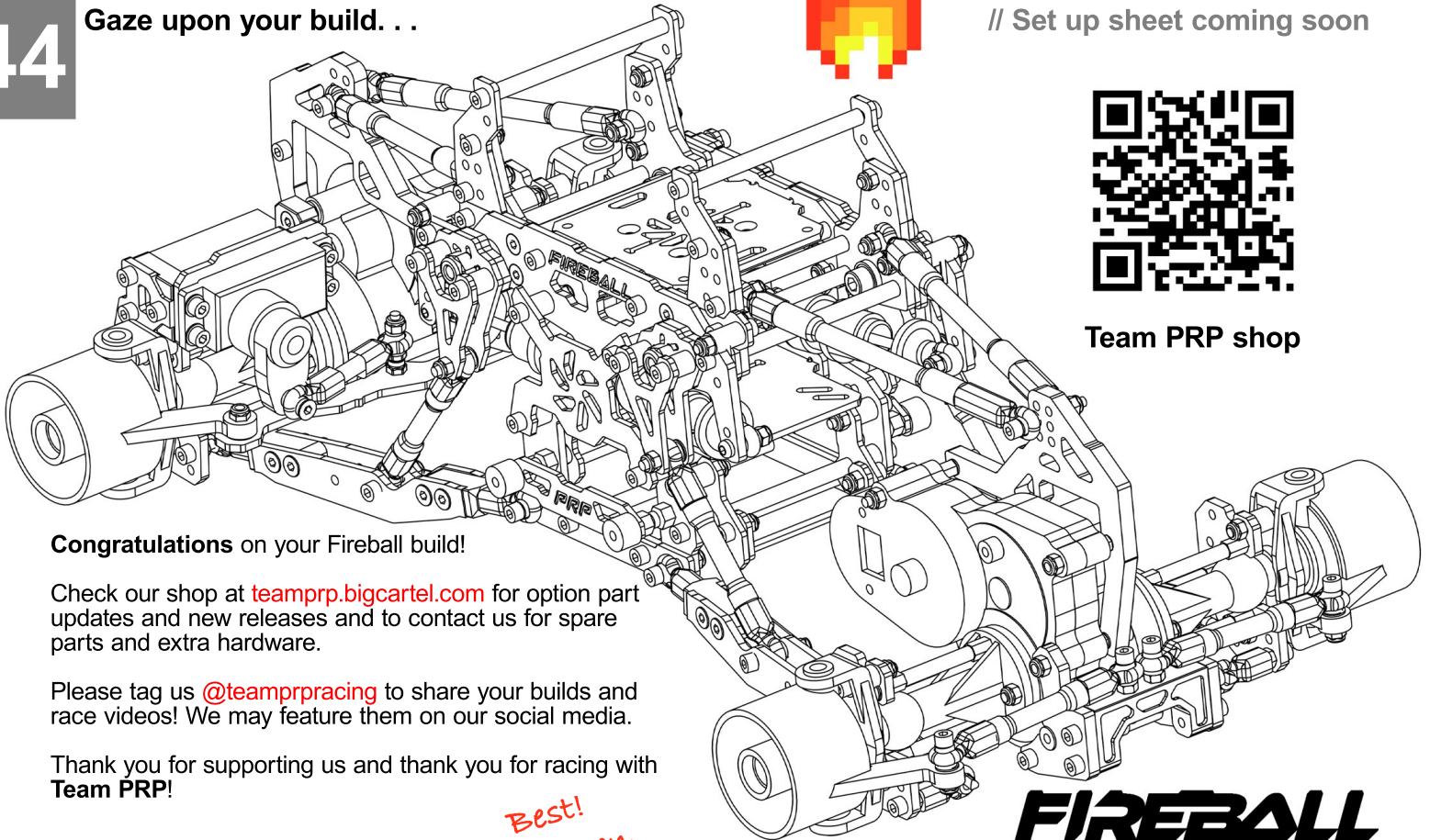

Team PRP shop

Congratulations on your Fireball build!

Check our shop at teamprp.bigcartel.com for option part updates and new releases and to contact us for spare parts and extra hardware.

Please tag us [@teamprpracing](https://twitter.com/teamprpracing) to share your builds and race videos! We may feature them on our social media.

Thank you for supporting us and thank you for racing with Team PRP!

*Best!
Ben*