

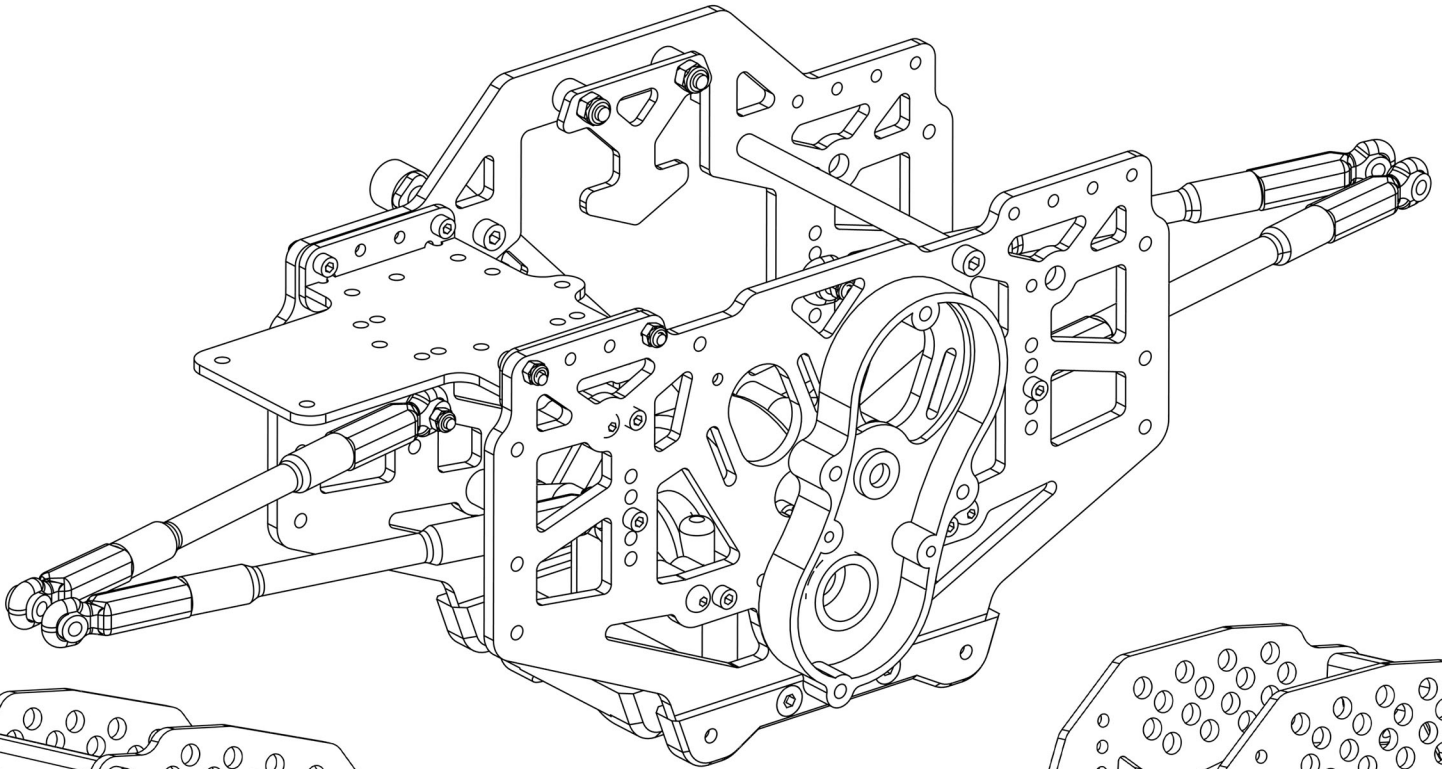

Goblin UNUM LMT Conversion kit

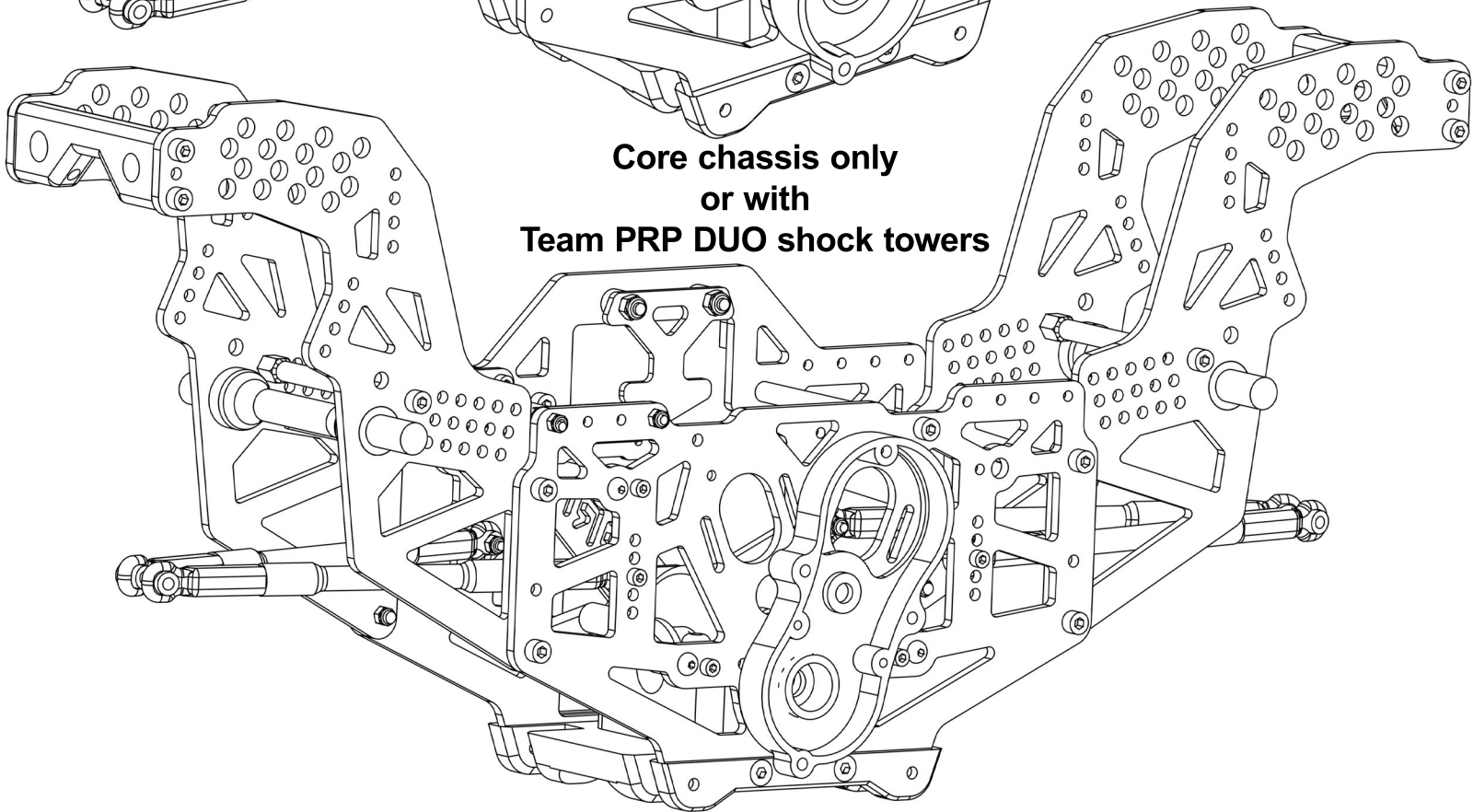

**Core chassis only
or with
Team PRP DUO shock towers**



Chassis conversion for the Team Losi LMT RTR, Roller, or TLR Tuned trucks. Single motor, lower center of gravity 2S shorty side mounted battery and fore or aft weight bias tuning with motor and electronics position options.

1

Gearbox Housing preparation. Due to the gearbox housing rotated further forward or backward on the Goblin Unum you must mod the housing to fit over the center gearbox diff housing / skid plate.

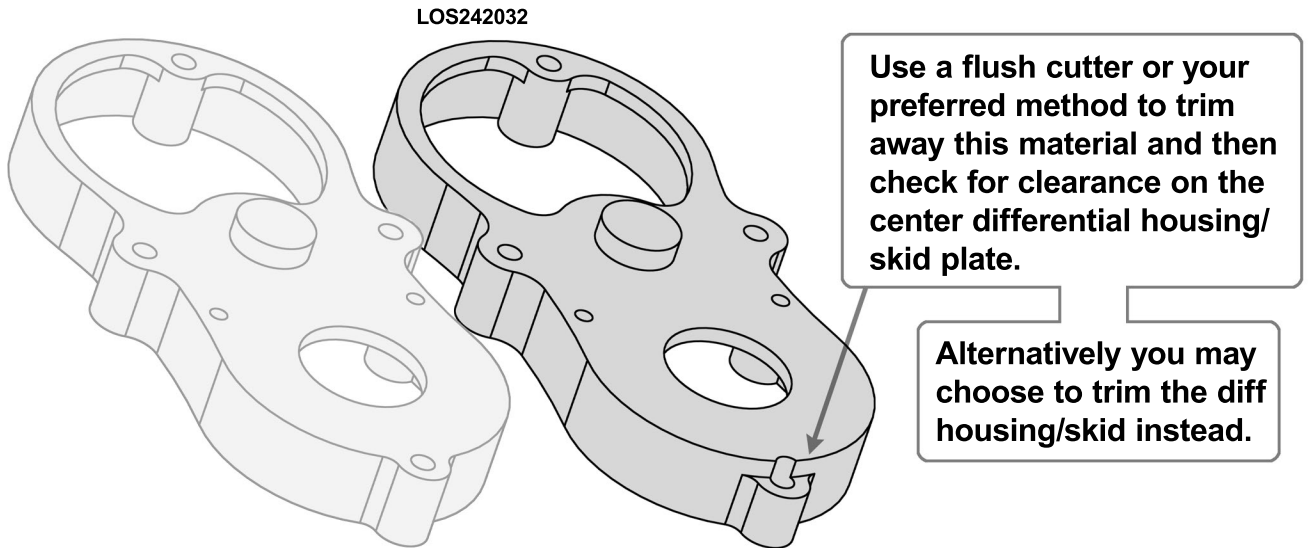

2

Install Gearbox Housing to right side chassis plate. Choose fore or aft motor weight bias position.

M2.5x10mm
Cap Head x2

M2.5x10mm
Flat Head

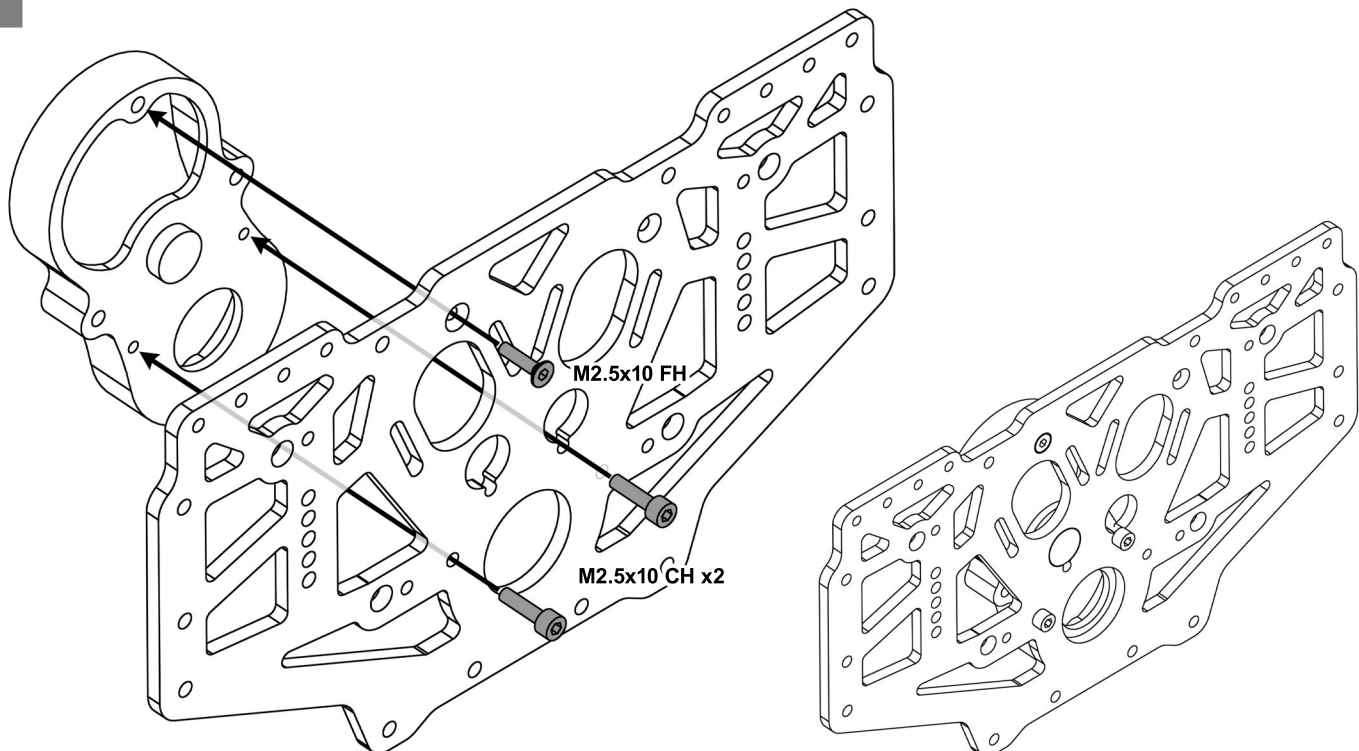

3

Assemble battery retaining system.



M3
Locknut x3

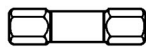

18mm Standoff
x2



M3x5mm
Spacer x4



M3x18mm
Cap Head x3



M3x14mm
Cap Head x1

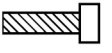

M3x10mm
Cap Head x1

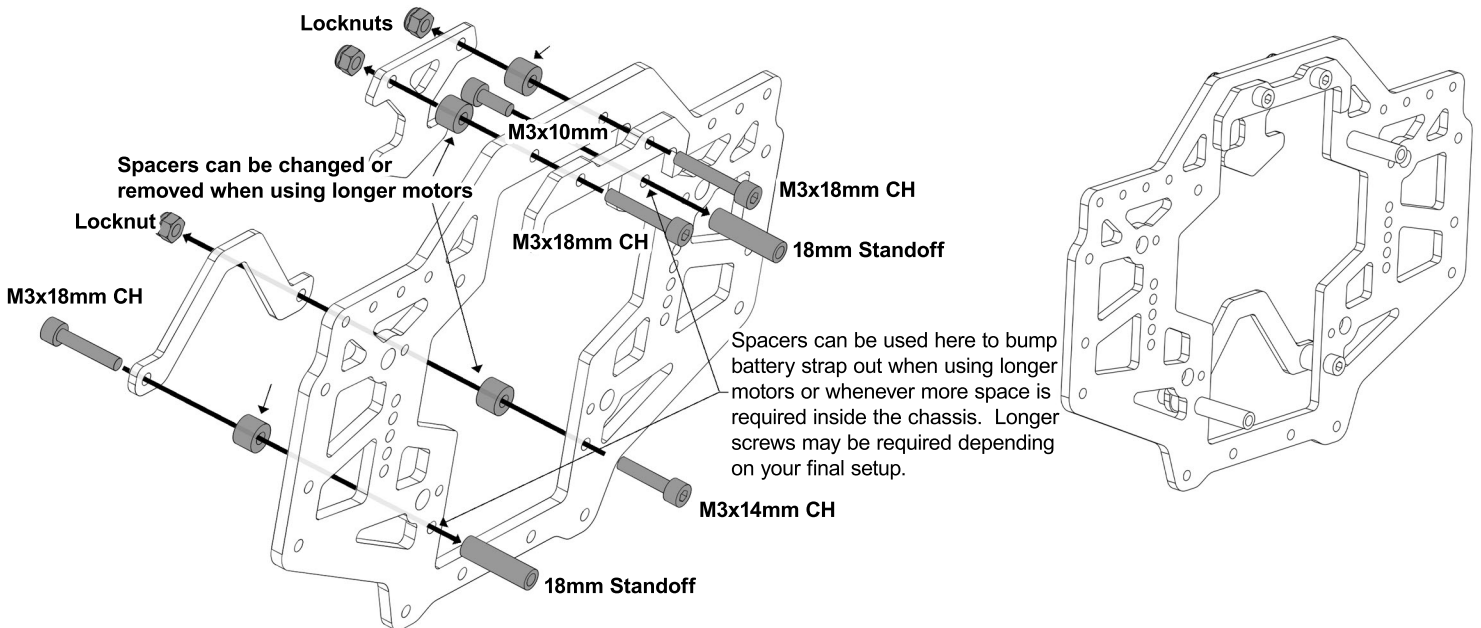

4

Attach the included 66mm black standoff and the stock Losi LMT cross braces or aftermarket cross braces to the battery side chassis plate.



M3 Washer
x3



M3x10mm
Cap Head x4



M2.5x10mm
Cap Head x3

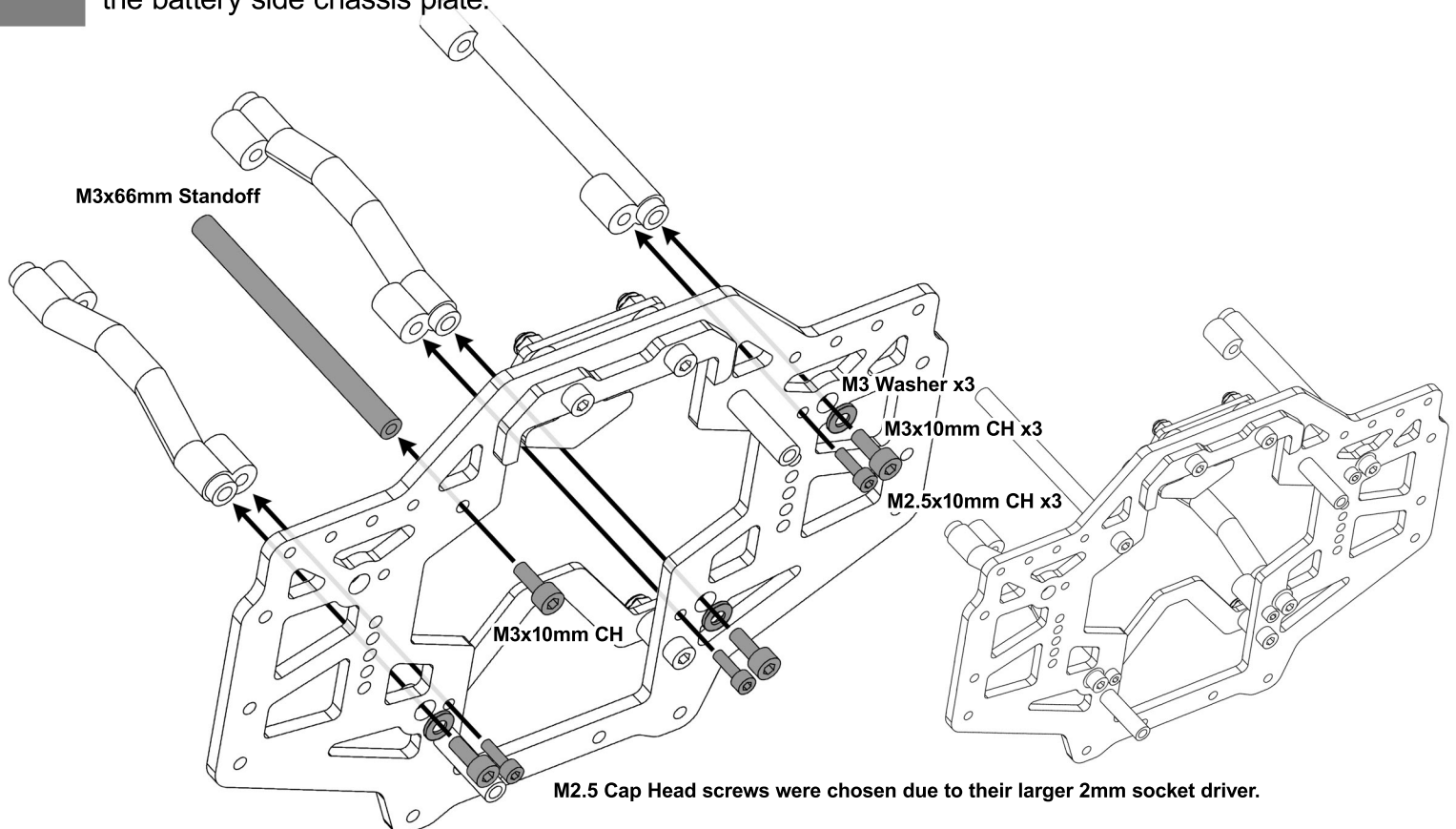

5

Gearbox Housing installation

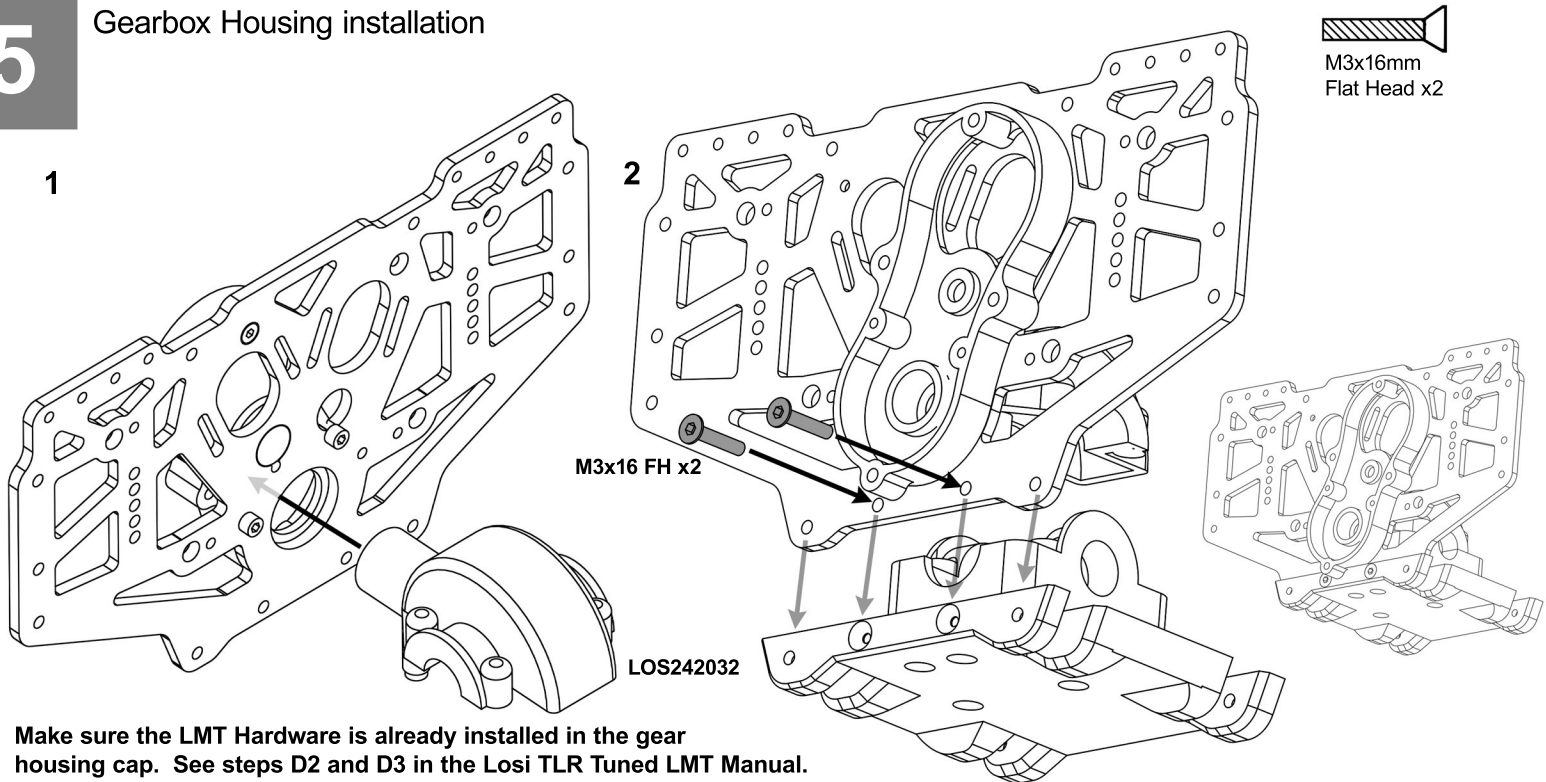

6

Install battery side plate into Gearbox Housing / skid plate and attach lower battery support.

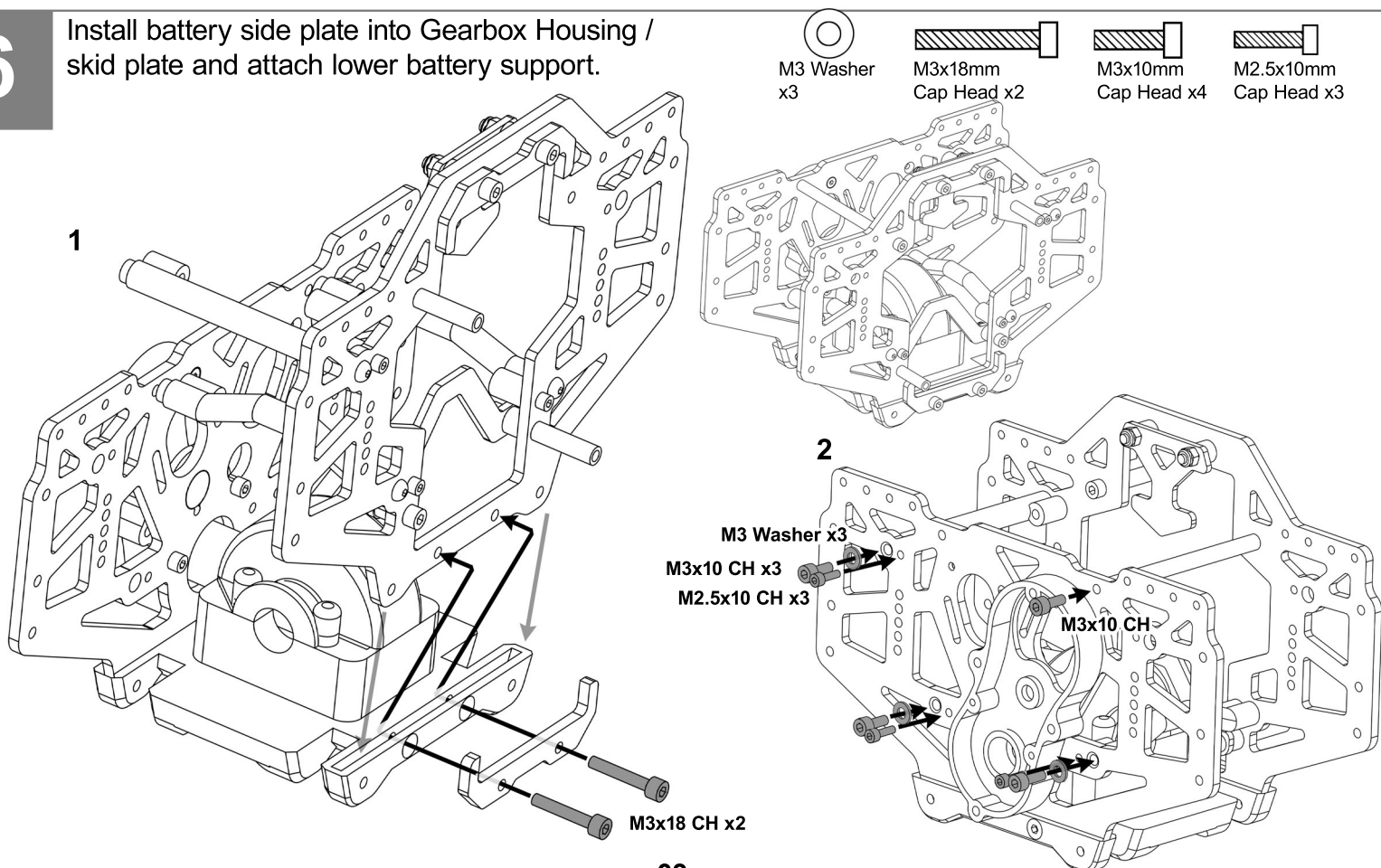

7

Electronics Tray assembly

1 Push mounts onto tray then place into chassis.

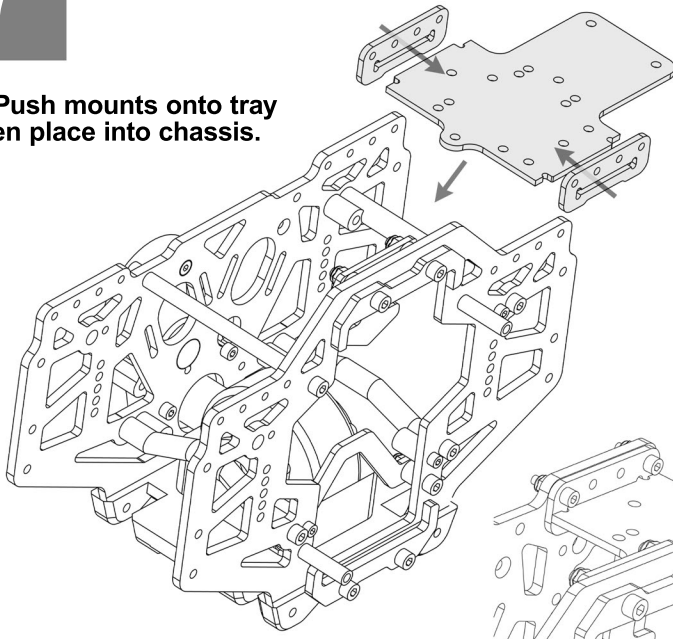

2

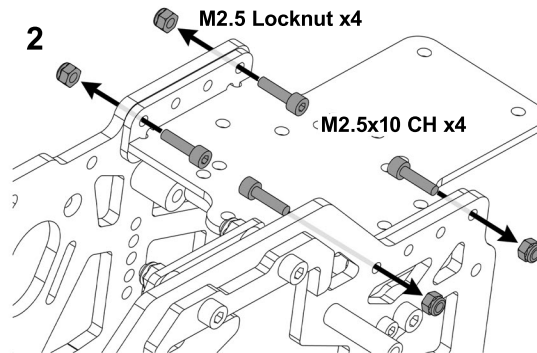

M2.5x10mm
Cap Head x4

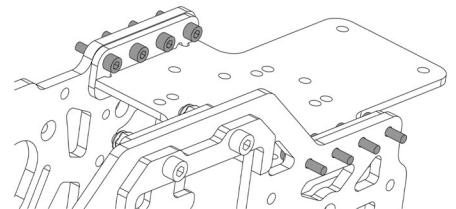

The Electronics tray can be raised, rotated fore or aft and moved to the front or rear of the chassis. Mounting holes for some Tekin and Spektrum ESCs.

OPTION: Use M2.5x10mm CH x8 to mount the LMT Headers LOS41035.

8

Install battery strap



Thumbnut x2



M3x16mm
Set Screw x2

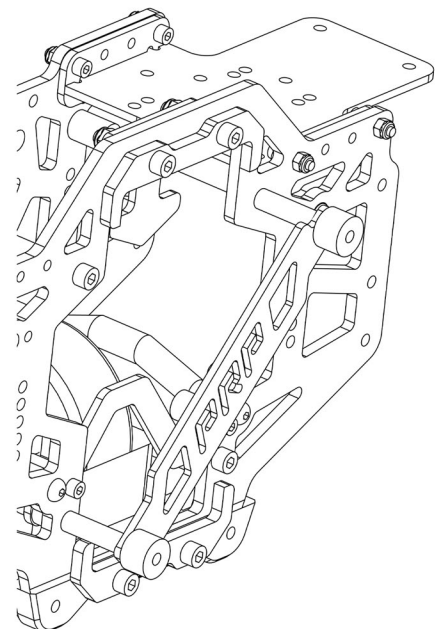
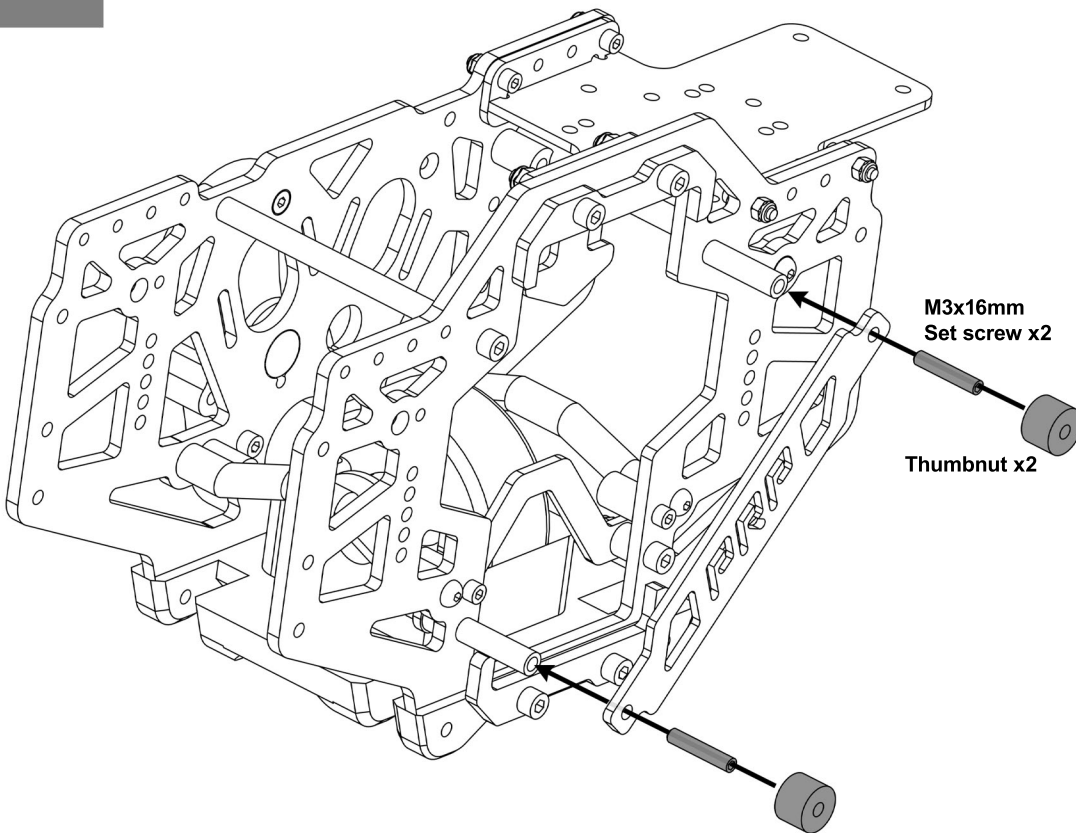

9

Build 4 Upper Links and attach them to the chassis using stock Losi LMT Rod Ends.

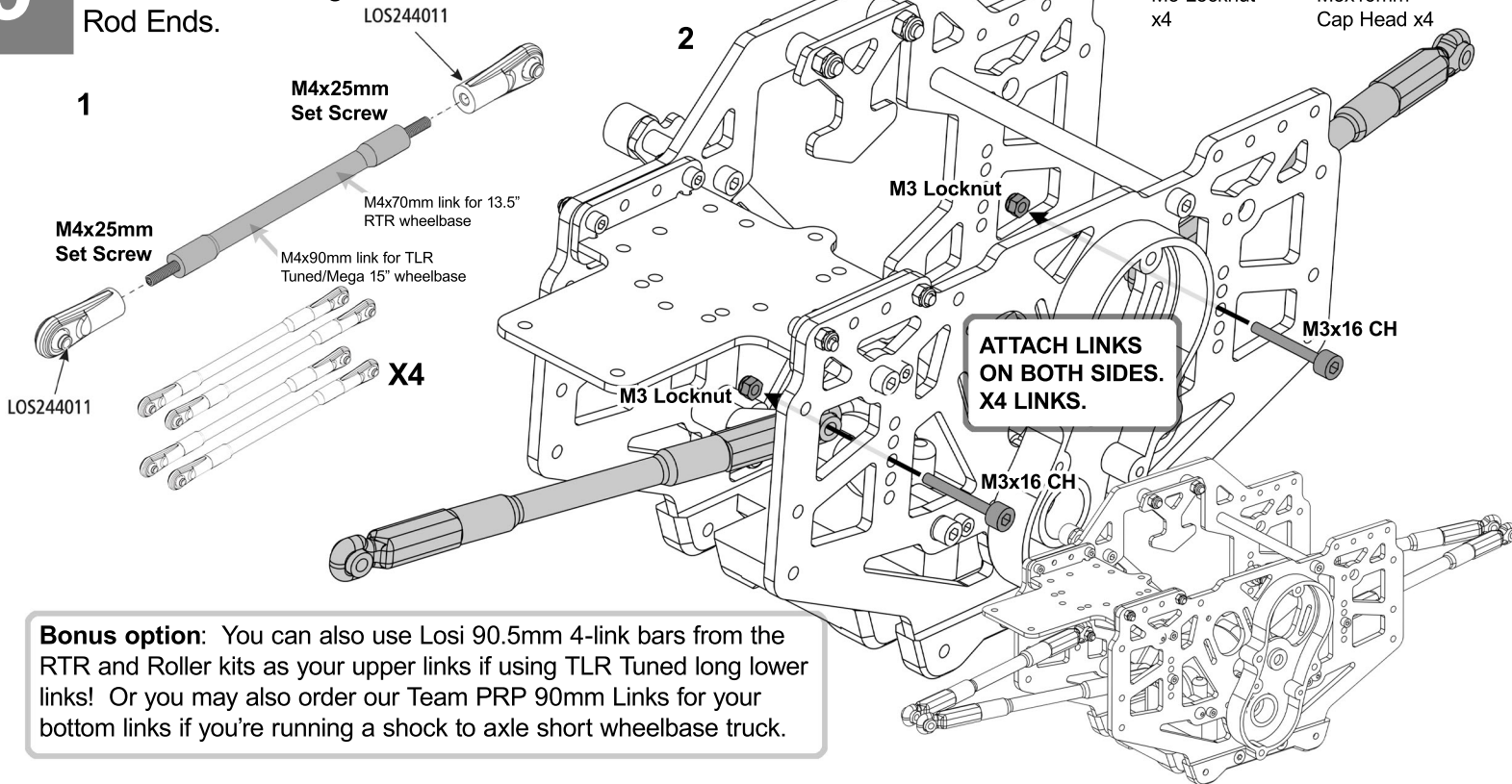

10

Mount your LMT kit shock towers or the Team PRP Duo shock towers shown here. Install Sway Bars LOS244006 then install the shock towers on the other side.

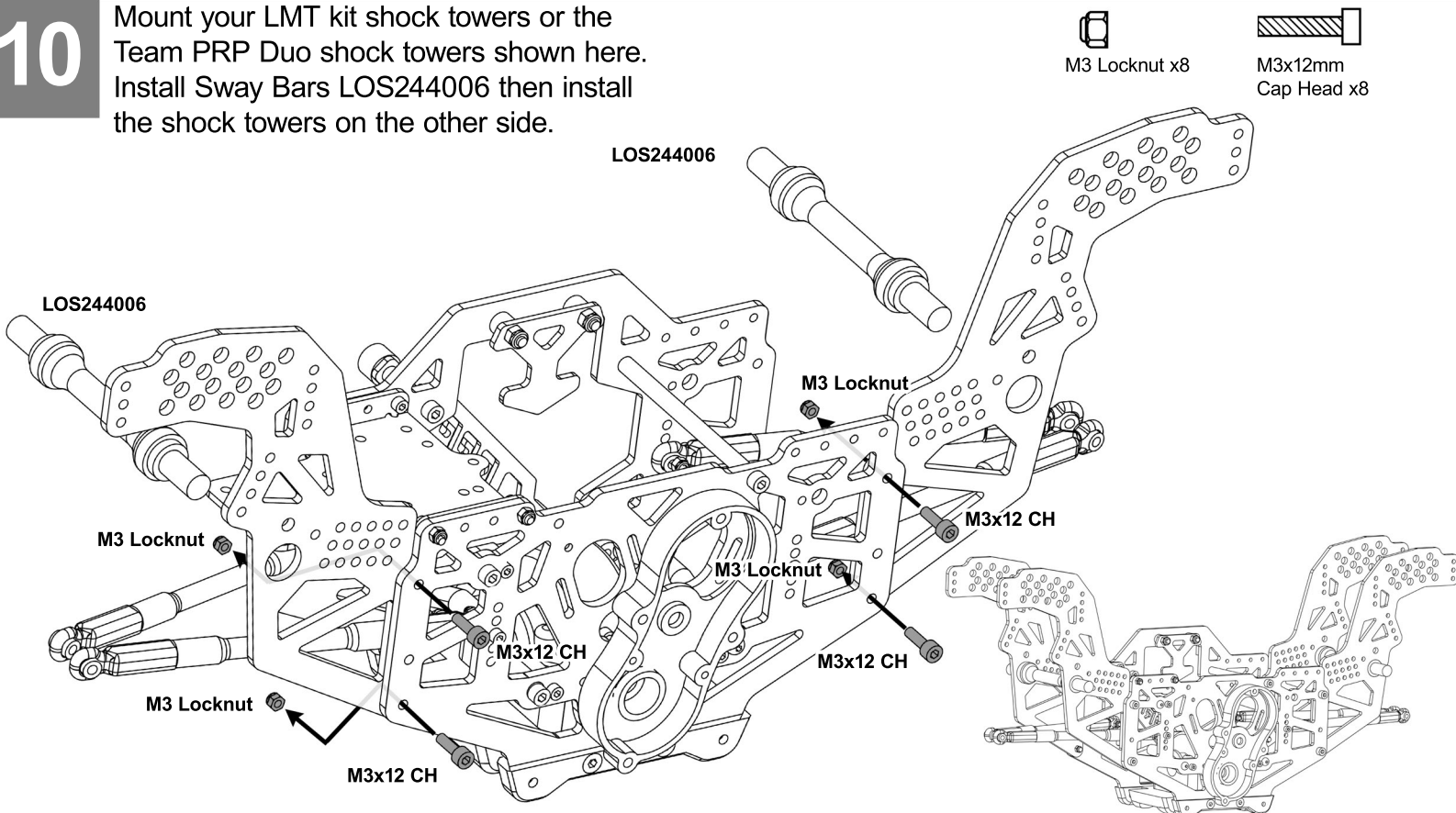

11

Attach 60mm cross braces to shock towers.

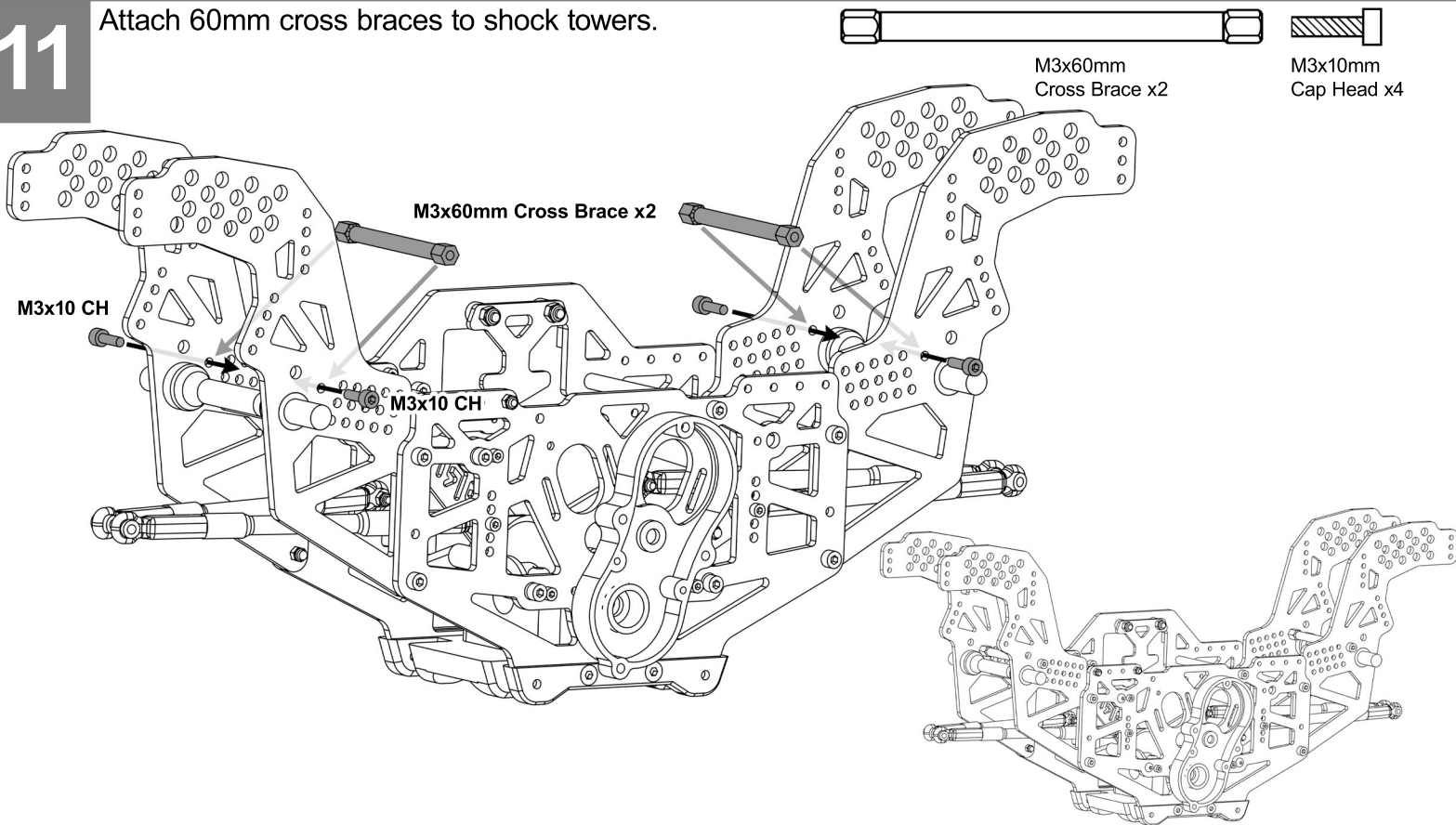

12

Install LOS241032 Cross Braces to front and rear of chassis. If using Team PRP Duo towers you can attach Losi LMT body posts in either location shown using the body post hardware from your LMT kit.

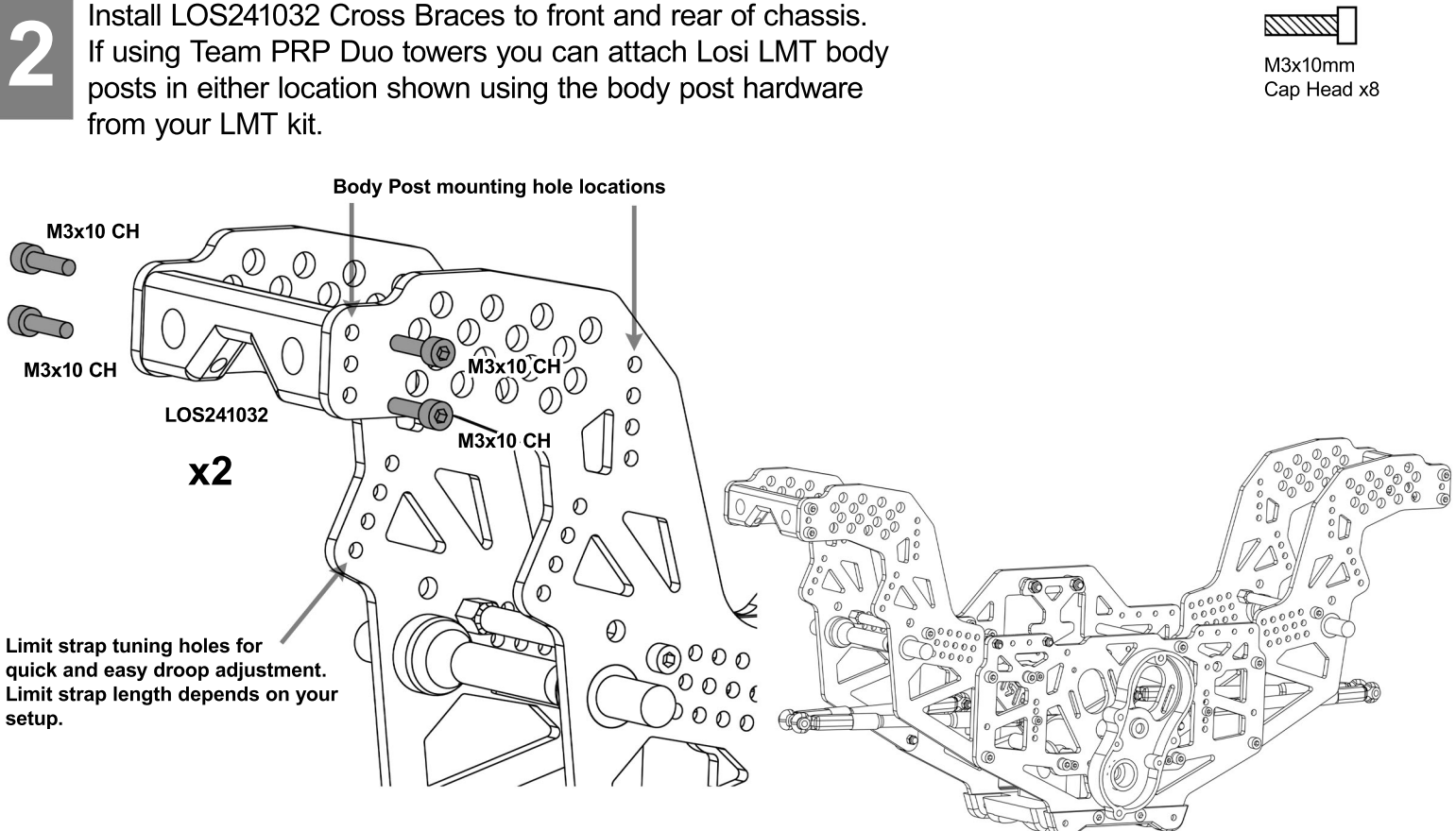

13

Battery Positioning: You can make adjustments to the battery retaining system as required.
Motor Positioning: Long sensed motors may require the sensor wire to be positioned away from the battery for optimal clearance. Motor mount hardware included:

M3 Washer
x2

M3x8mm
Cap Head x2

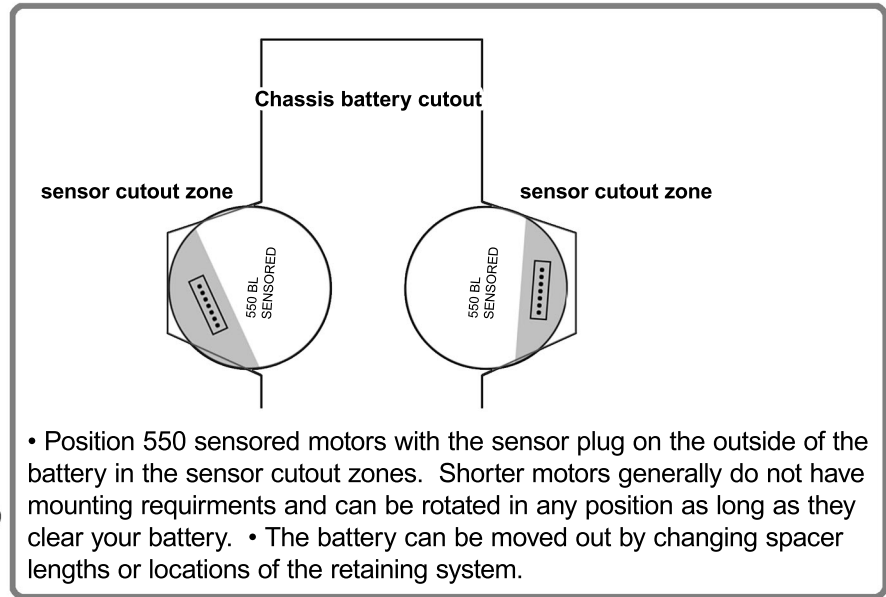
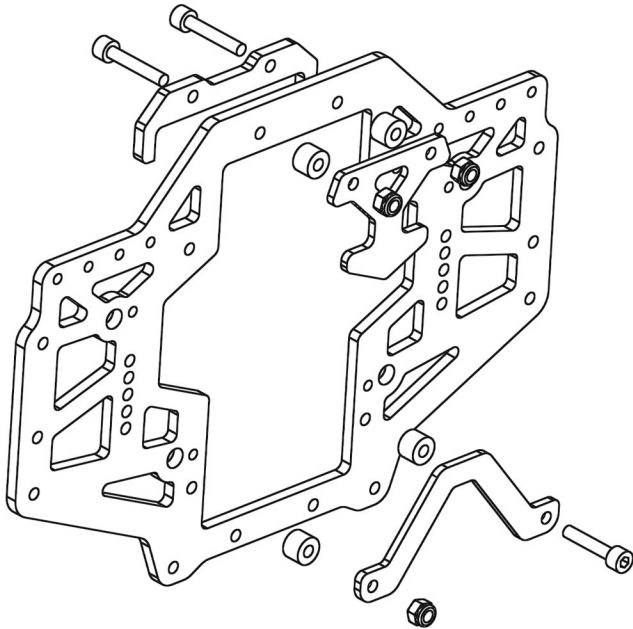

14

Now simply refer to the Team Losi LMT manual for instructions on how to mount the outer shock towers, shocks, lower links, axles, etc., to the chassis using the parts and hardware from your Losi LMT kit and prepare to rip up the track with your new Team PRP Goblin Unum!

If you are installing Team PRP option parts please download their instruction sheets from our support page:
teamprp.bigcartel.com/support

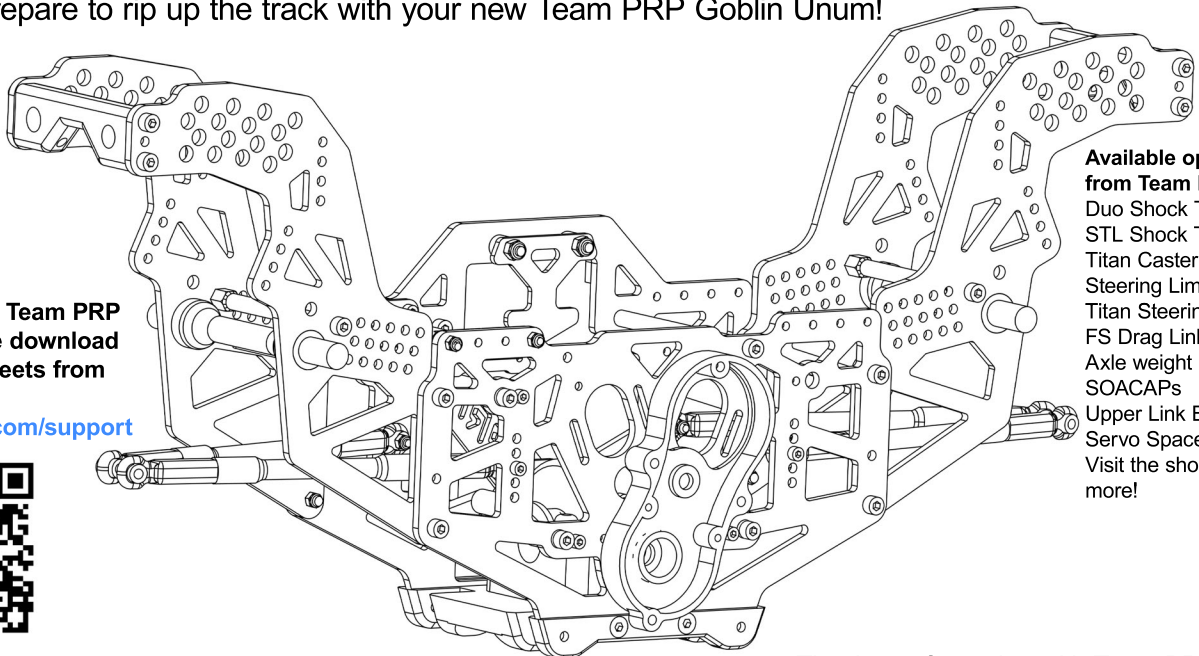

Available options from Team PRP:
 Duo Shock Towers
 STL Shock Towers
 Titan Caster Blocks
 Steering Limiters
 Titan Steering Link
 FS Drag Link
 Axle weight Mounts
 SOACAPs
 Upper Link Braces
 Servo Spacer
 Visit the shop for more!

Thank you for racing with Team PRP.
 The art of R/C!



DRIVER: _____ BODY: _____
EVENT: _____ FINISH: _____
DATE: _____ QUAL: _____
SURFACE TYPE: _____ Size: Small / Med / Large / Very Large
TRACK: _____ Traction: Low / Med / High / Very High Dry / Damp / Wet / Dusty / Hard Pack / Bumpy
TEMPERATURE: _____ ° WEATHER: _____ Smooth / Loamy / Other: _____

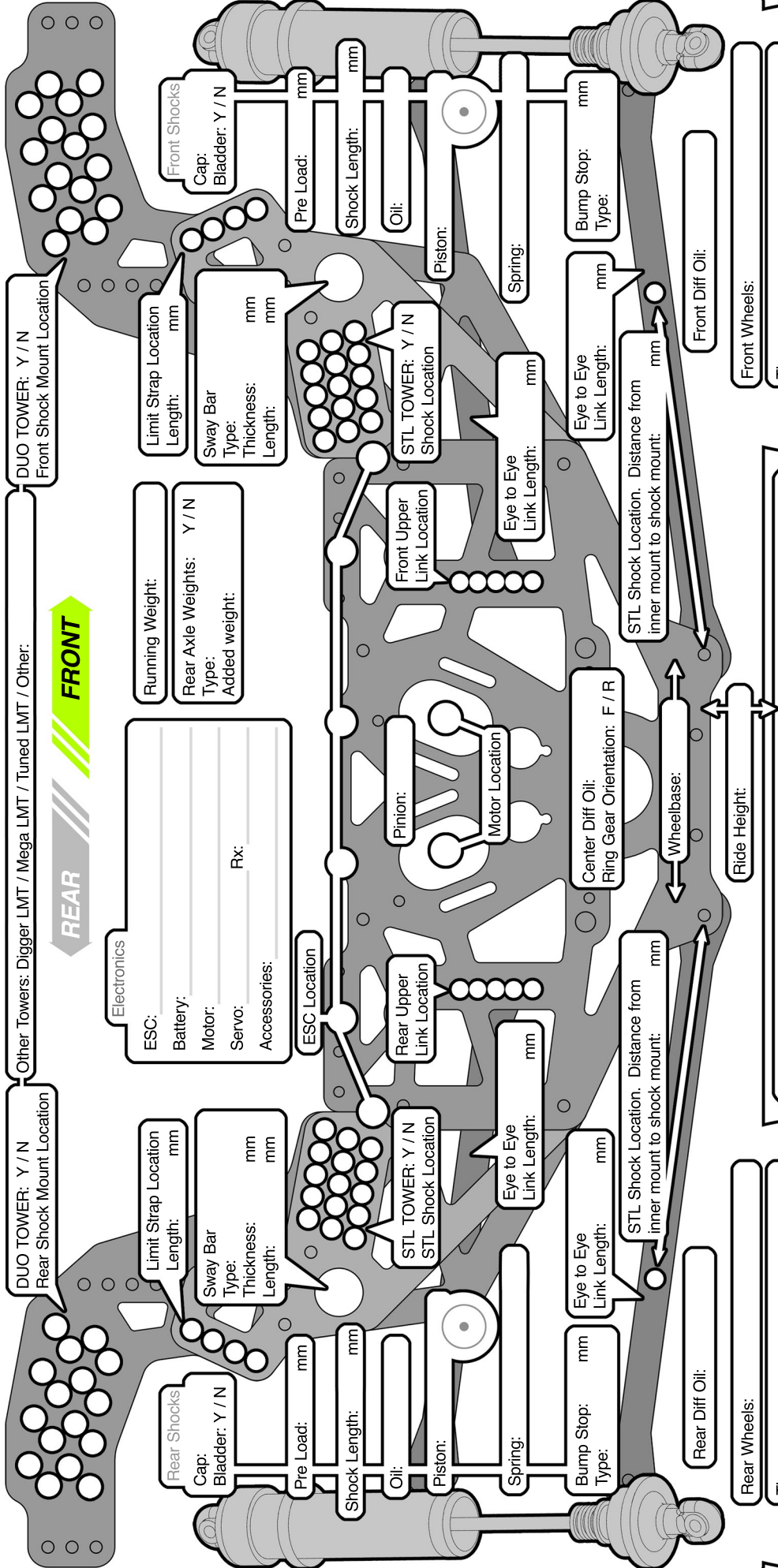

Front Wheels: _____
Tire: _____
Insert: _____
Tire Mods: _____
Wheel Mods: _____
Track Width: _____
Front Toe: _____ °
Caster: _____ °

Notes: _____

Rear Wheels: _____
Tire: _____
Insert: _____
Tire Mods: _____
Wheel Mods: _____
Track Width: _____
Rear Toe: _____ °