

# TEAMPRP

## Goblin LMT Conversion kit

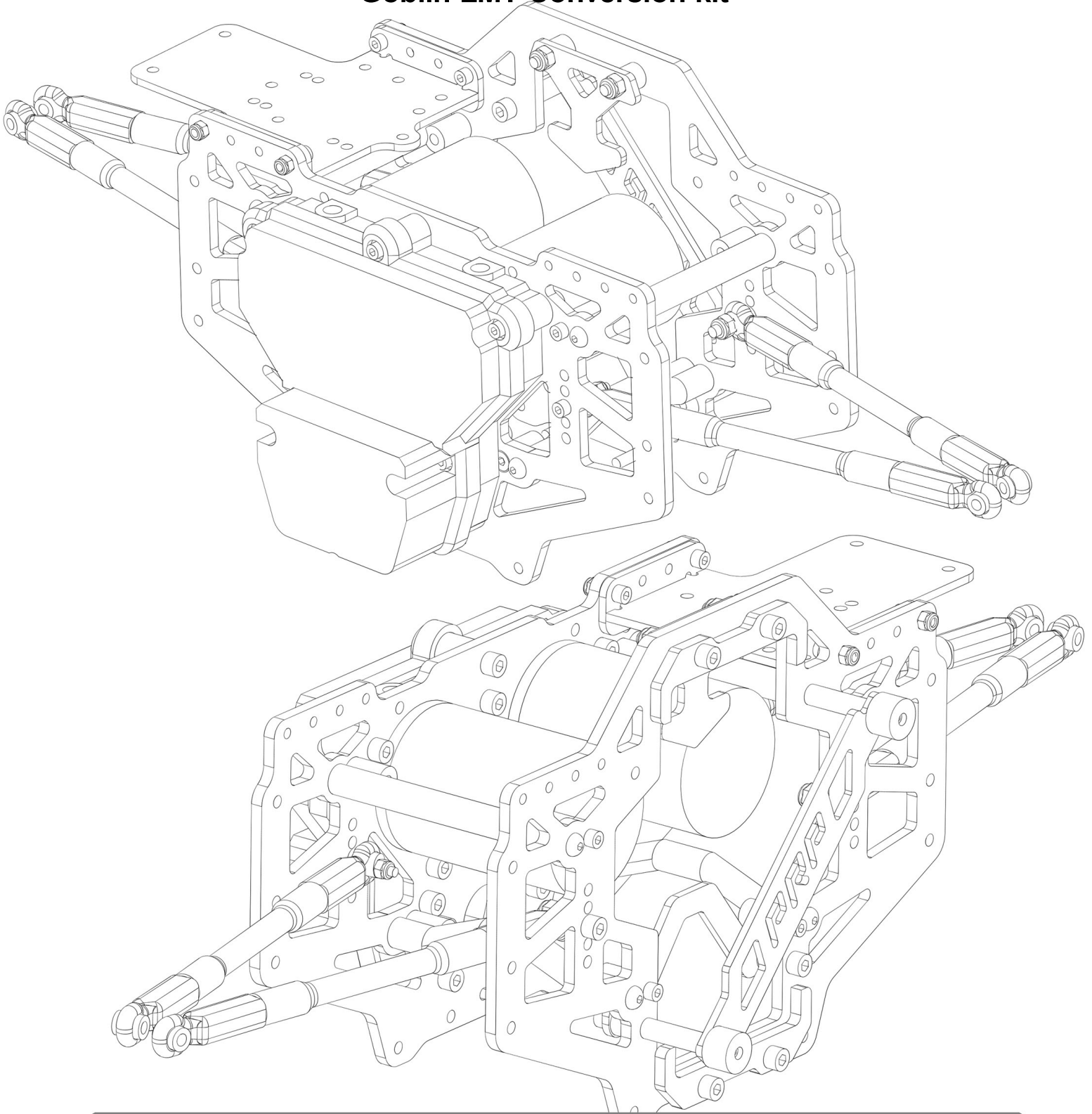

Center chassis conversion for the Team Losi LMT RTR, Roller, TLR Tuned or Mega trucks. Dual or single motors, lower center of gravity 2S shorty side mounted battery and fore or aft weight bias tuning with motor and electronics position options.

**!! Requires Hot Racing Mod 1 34t Pinion 5mm Bore part #HRANS34M1**

1

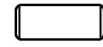
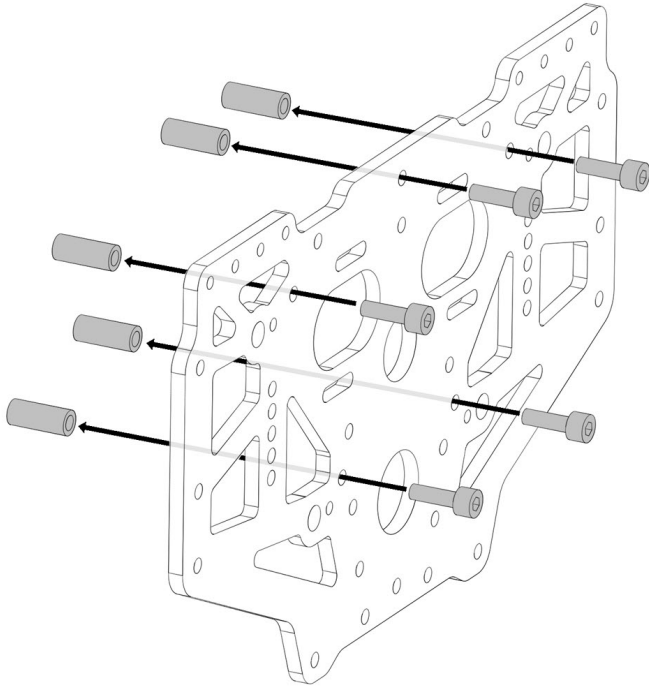

12mm Round Standoff x5



M3x8mm Cap Head x5

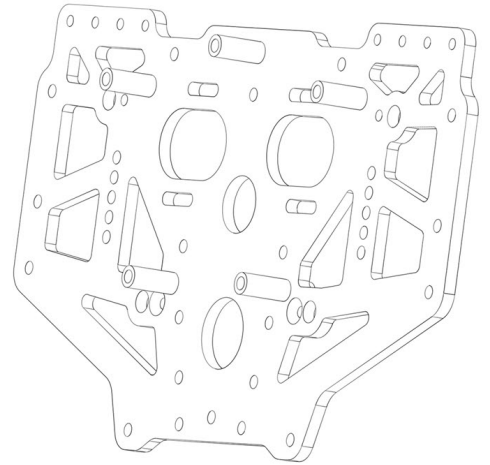

2

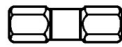

15mm Standoff x3

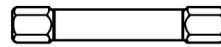

28mm Standoff x4



M3x8mm Cap Head x7

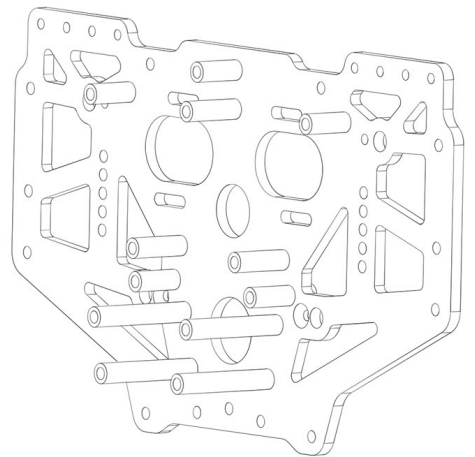
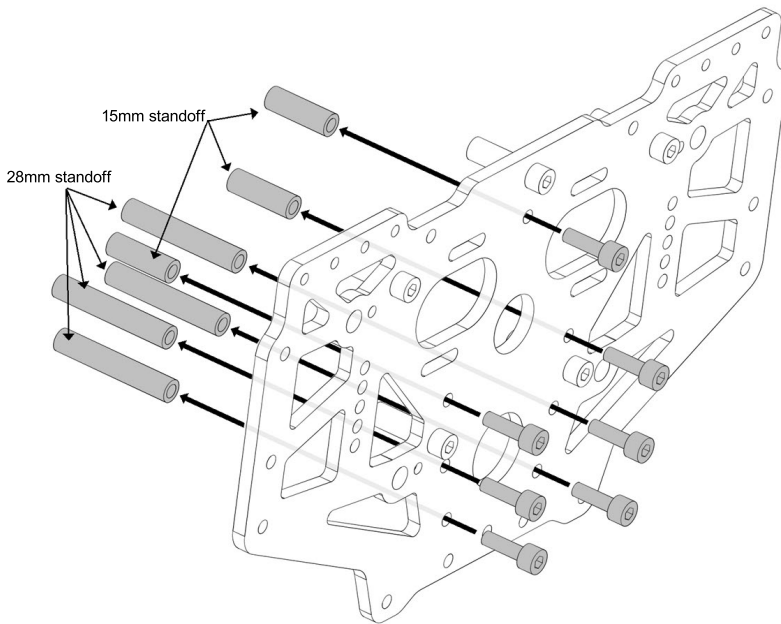

### 3



M3 Locknut x3

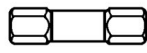

18mm Standoff x2



M3x5mm Spacer x4



M3x18mm Cap Head x3



M3x16mm Cap Head x1



M3x14mm Cap Head x1

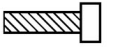

M3x10mm Cap Head x1

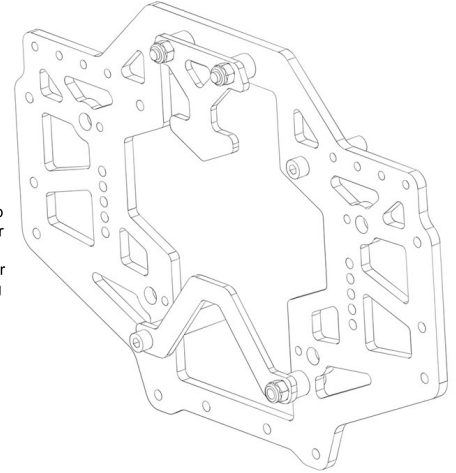
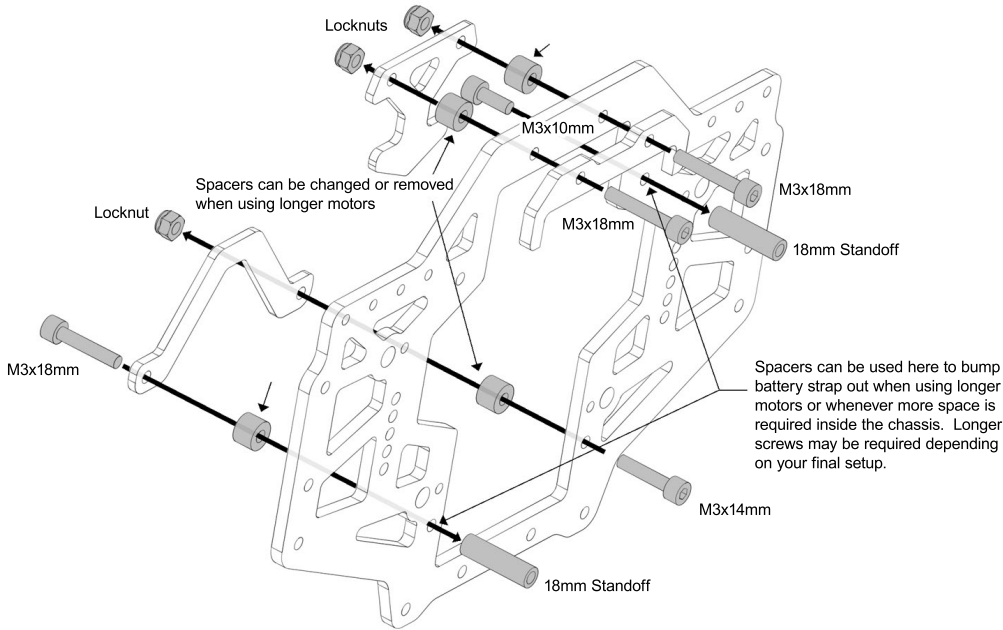

### 4

Attach stock Losi LMT crossmembers or aftermarket crossmembers to the top of the motor side plate. Install the lower crossmembers to the battery side plate.



M3x12mm Button Head x4



M2.5x12mm Cap Head x4

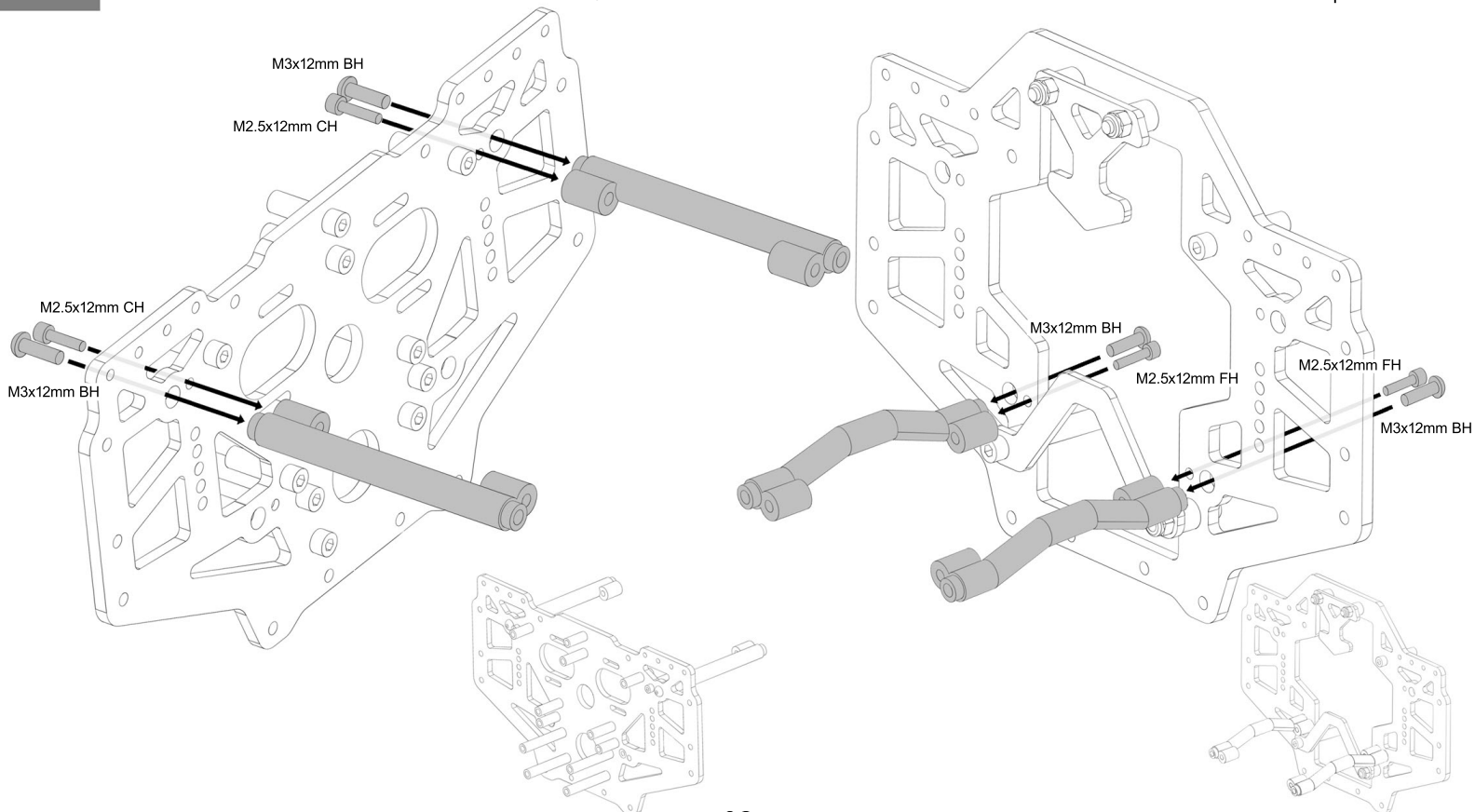

### 5

Refer to the Team Losi TLR Tuned LMT manual step D3 to attach motor side plate to the gear box housing set using the housing screws from your Losi LMT.

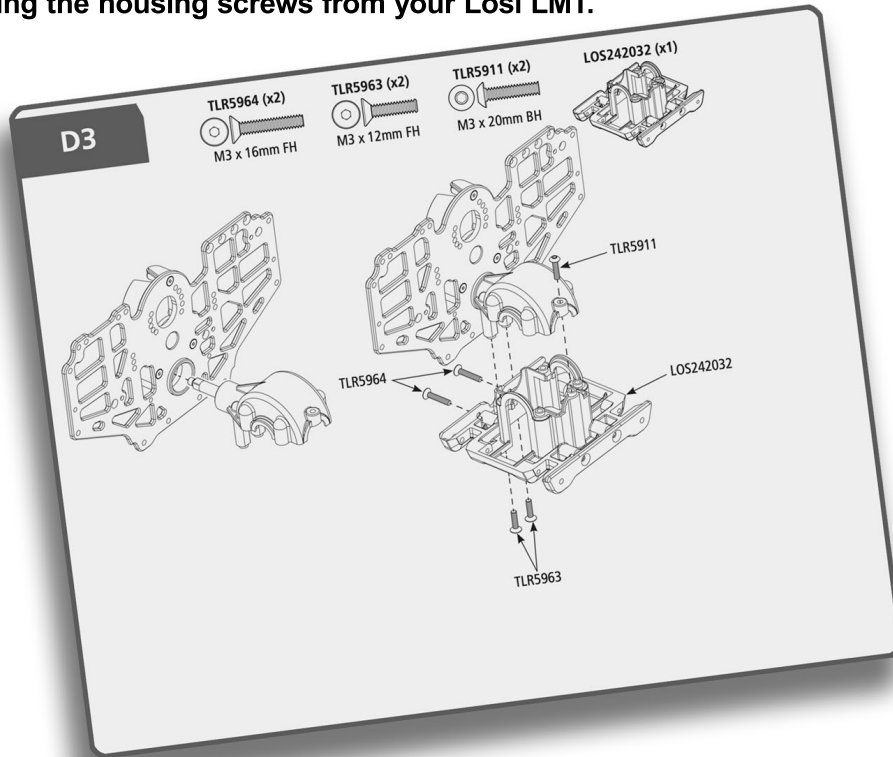

### 6

Once the Motor side plate is mounted inside of the LMT gear box housing set from step D3 of the TLR Tuned LMT kit manual, install the Goblin battery side chassis plate into place.

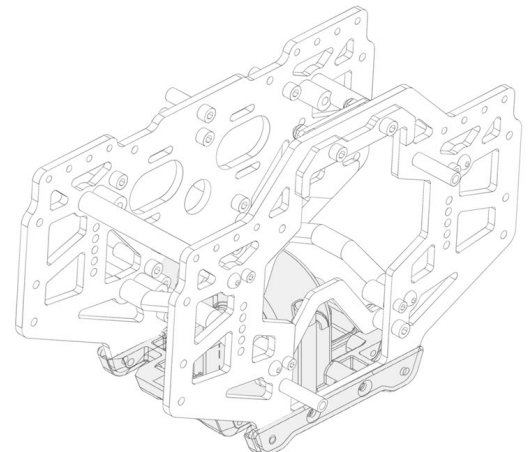
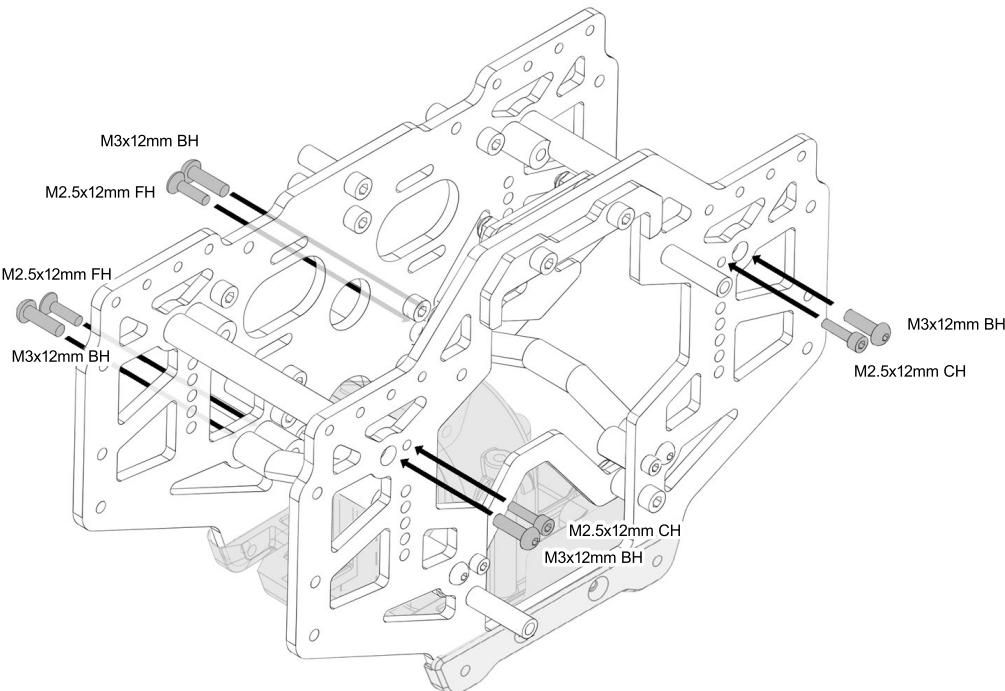
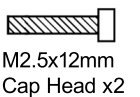

7

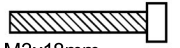
  
M3x18mm  
Cap Head x2

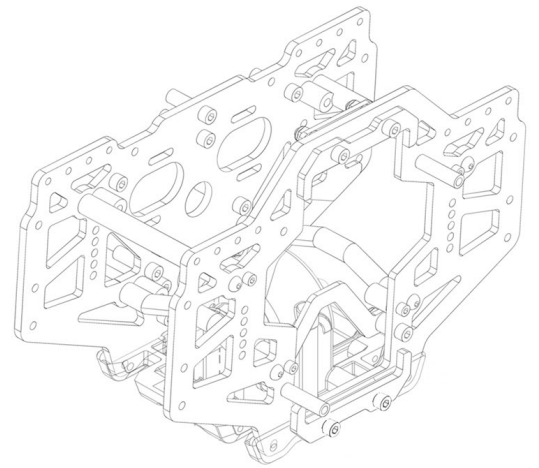
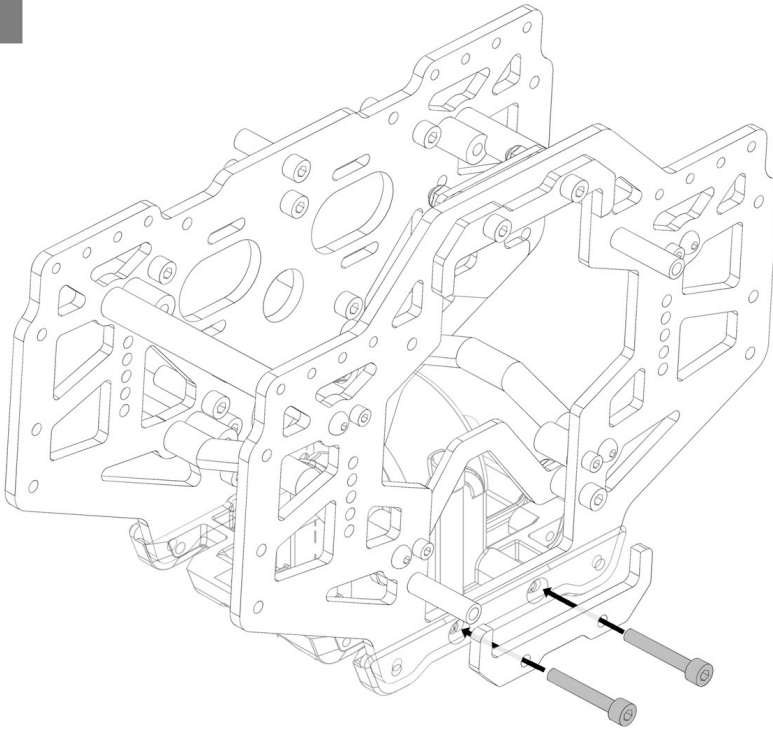

8

The electronics tray can be mounted at the front or the rear and can be rotated fore or aft or flipped and raised. You may also attach Losi headers #LOS241035 in this location by omitting the locknuts & using 8x M2.5x10mm Cap Head screws mounted inside the chassis facing out.

  
M2.5 Locknut x4

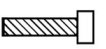
  
M2.5x10mm  
Cap Head x4

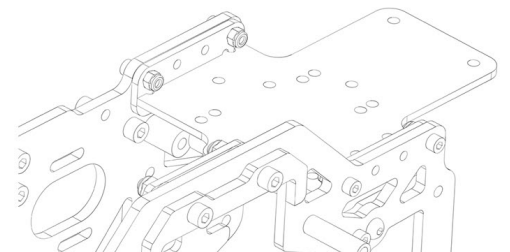
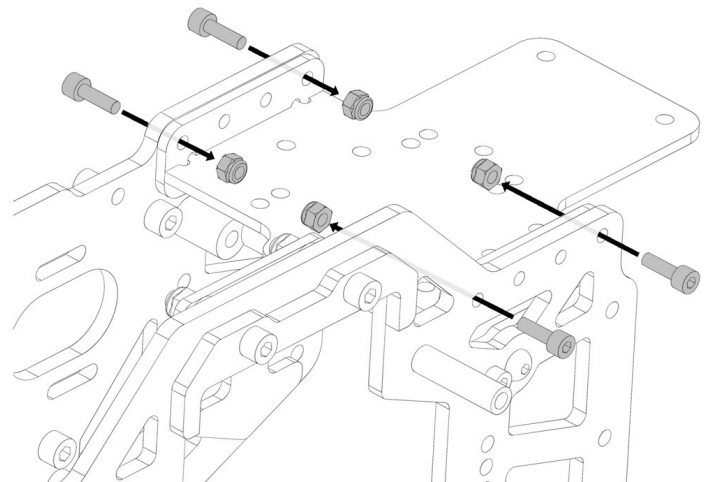
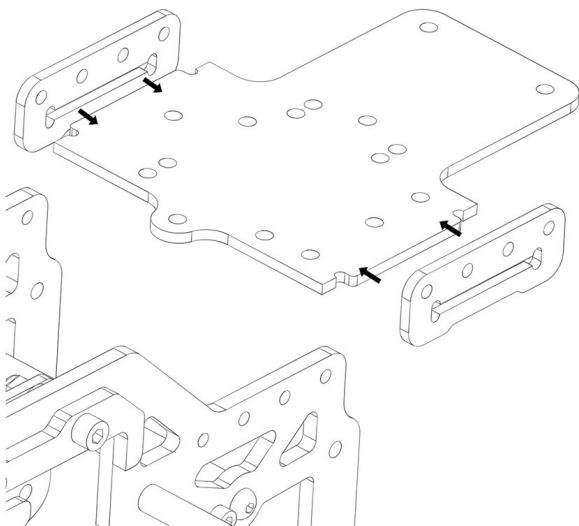

### 9

Refer to Team LOSI TLR Tuned kit Manual step D14 2 and 3 to install Cush Gear onto input shaft and omit the small M4x8 bearing. It will be replaced in the next step with a 12mm bearing.

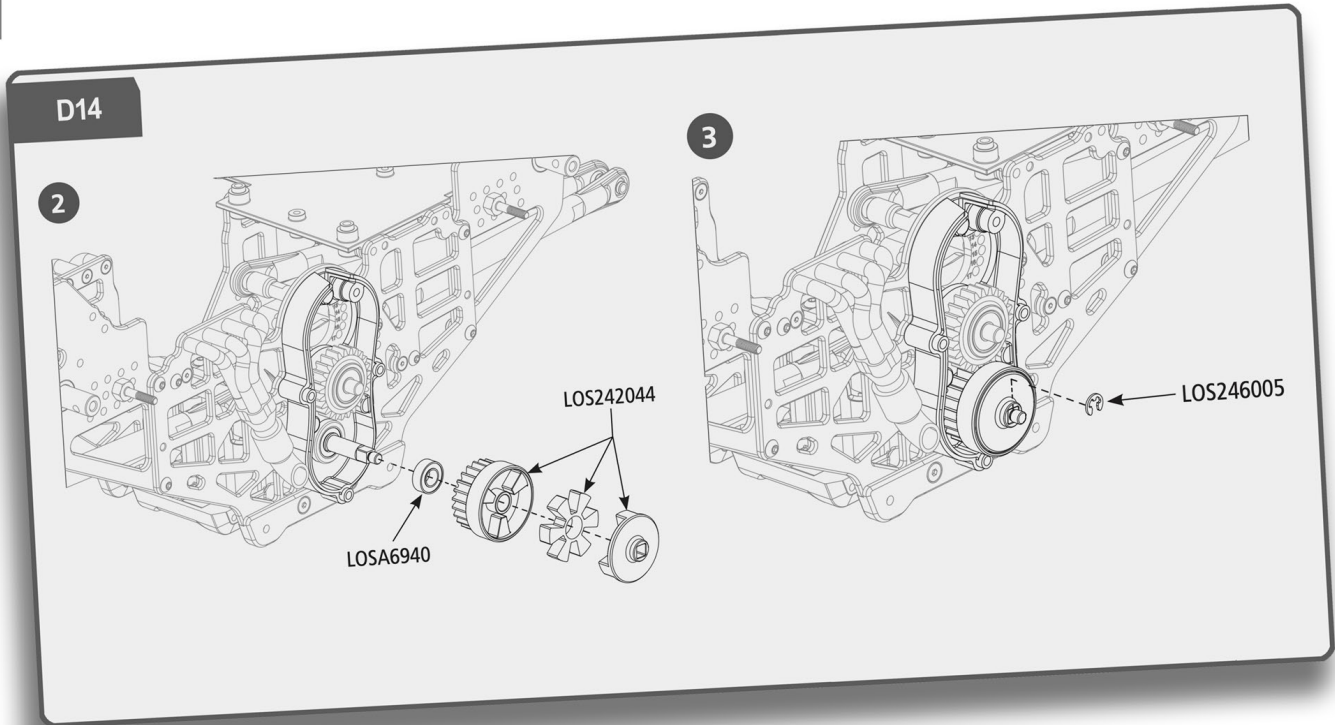

### 10

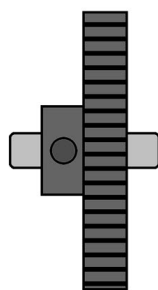
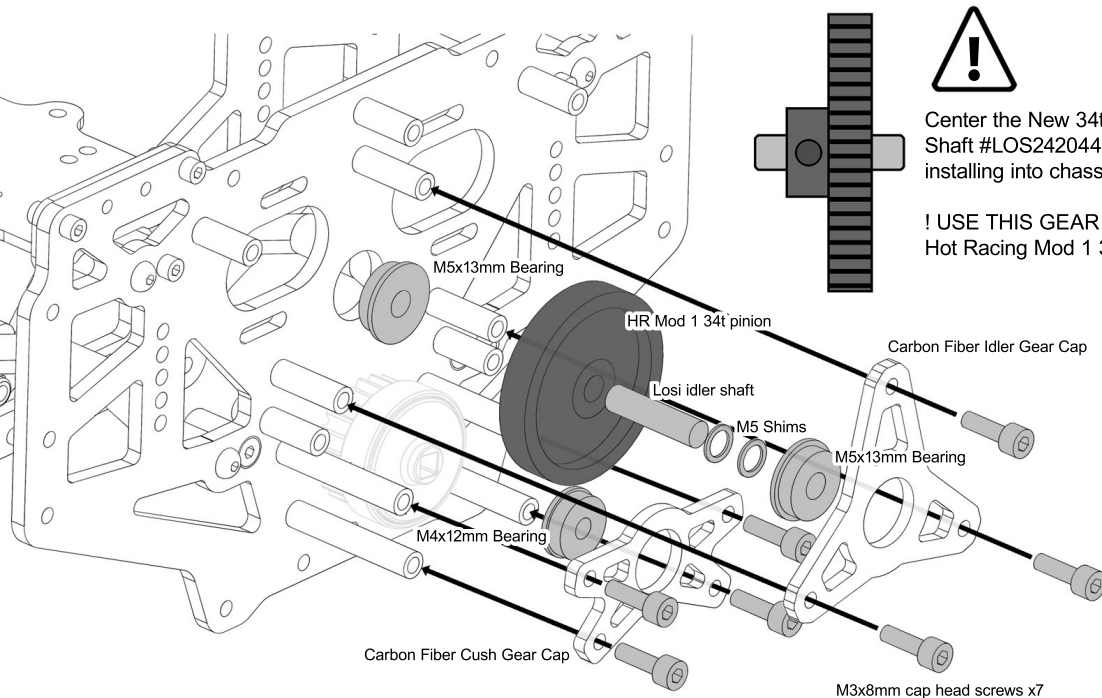
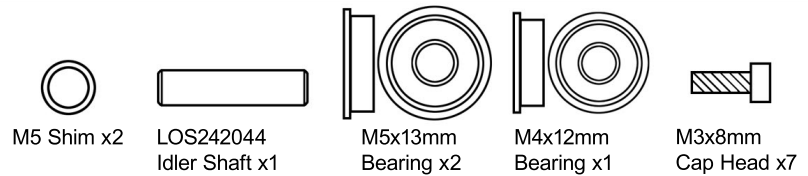

Center the New 34t Pinion on Losi Idler Shaft #LOS242044 and secure before installing into chassis.

**! USE THIS GEAR ONLY !**  
Hot Racing Mod 1 34t Pinion 5mm Bore #HRANS34M1

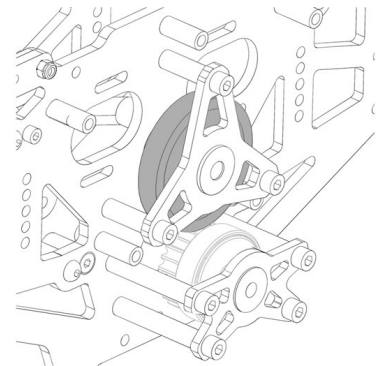

# 11

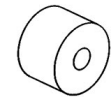
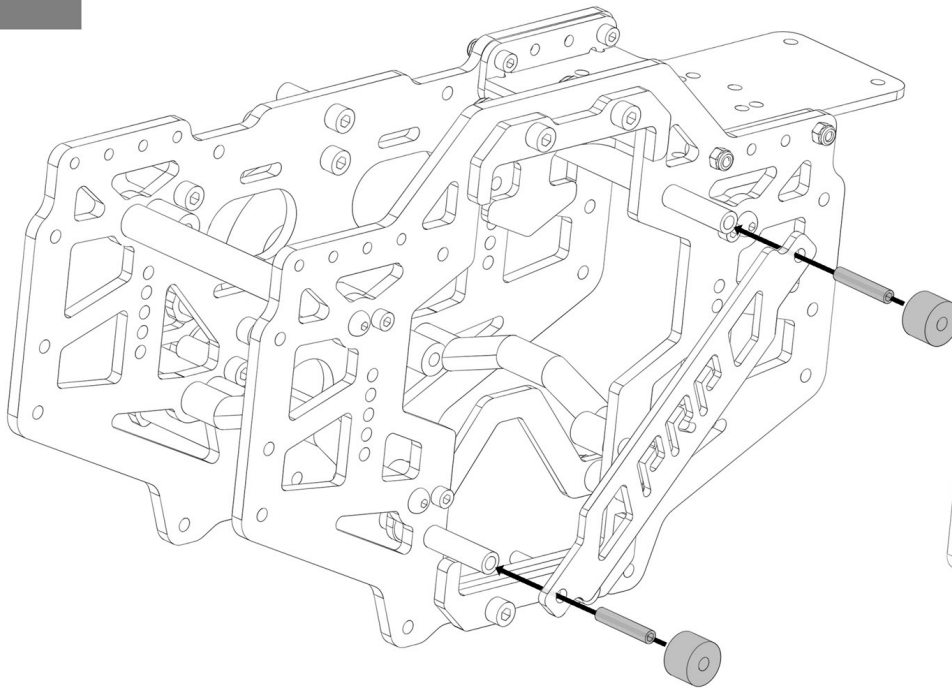

M3 Thumb Nut x2



M3x16mm Set Screw x2

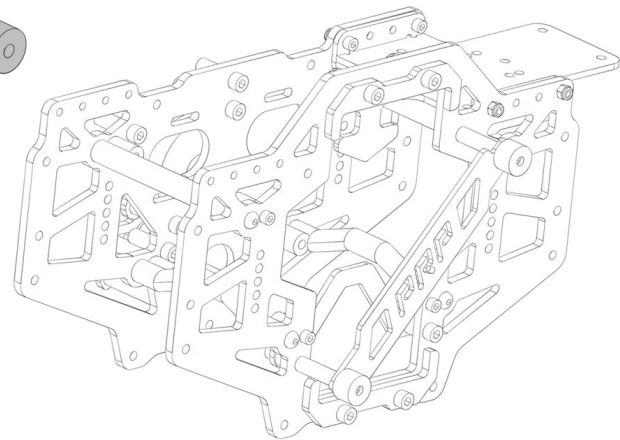

# 12

Brushed motors may require the Carbon Motor Spacers included in kit. Brushless motors DO NOT use the spacers.



Washer x4



M3x8mm Cap Head x4



M3x12mm Cap Head x4

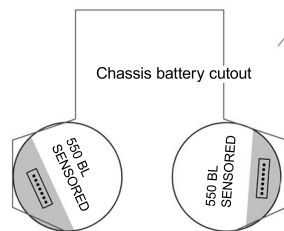
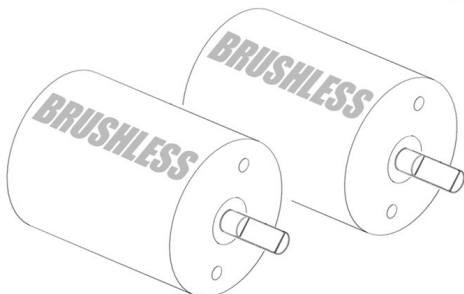
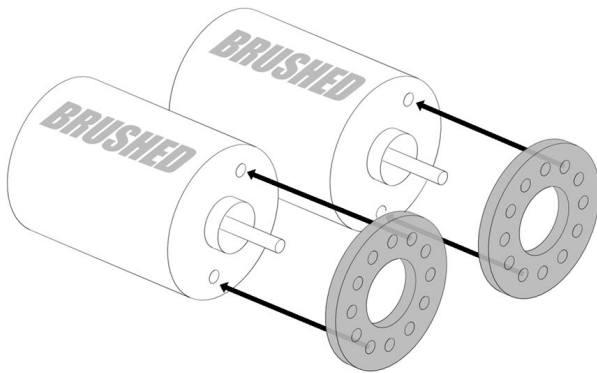

Chassis battery cutout

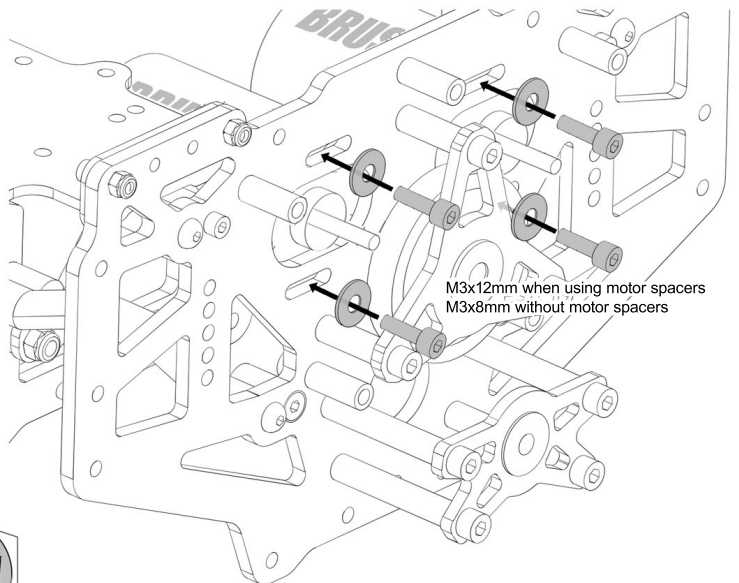
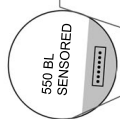

M3x12mm when using motor spacers  
M3x8mm without motor spacers

The Goblin accommodates single or dual motor setups with 540 and some 550 size motors.

Position 550 sensed motors with the sensor plug on the outside of the battery in the sensor cutout zones. Dual 550 Sensed motors might not fit depending on gearing, position and solder tab height. Shorter motors generally do not have mounting requirements.

13

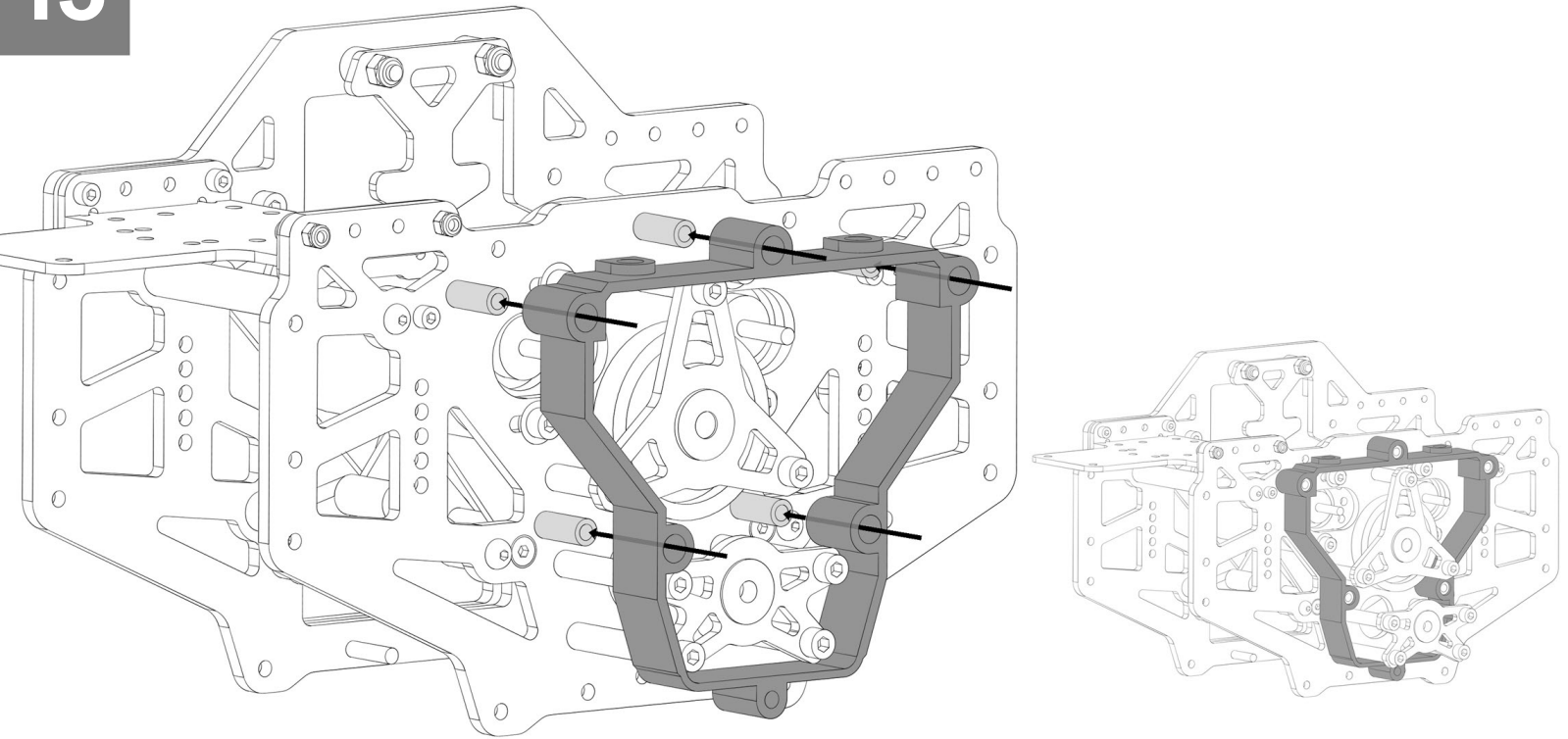

14

Gear cover set can also be purchased at our shapeways shop in other materials and colors:  
<https://www.shapeways.com/shops/teamprp>

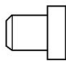
  
Rubber Plug x2

  
M3x20mm  
Cap Head x1

  
M3x8mm  
Cap Head x5

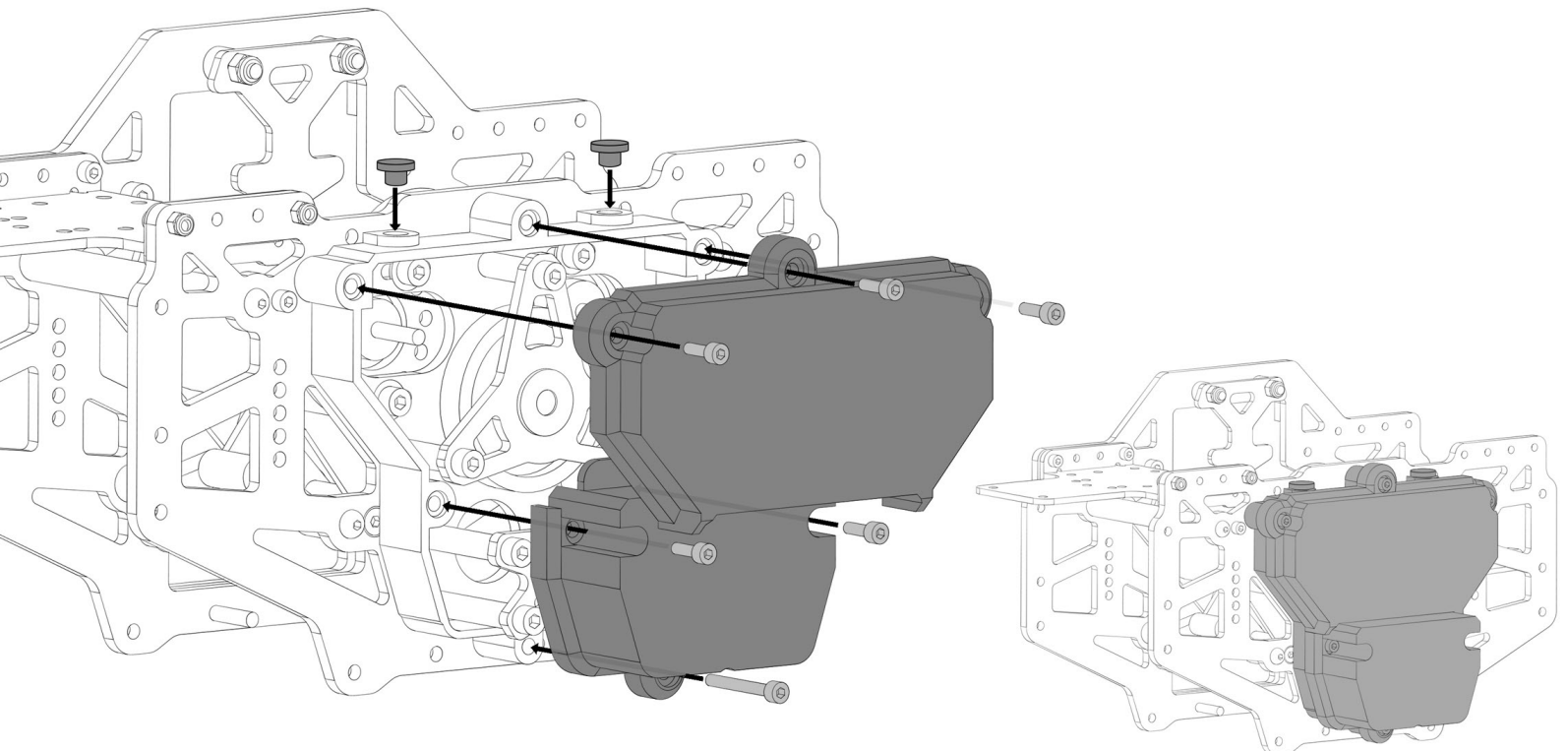



### 15

Build upper links x4 using stock Losi rod ends



M4x25mm  
Set Screw x8

**Variations:** Your kit may have included 4-links with a short set screw pre-installed. In this case, you may choose to replace it with the included M4x25mm set screw.

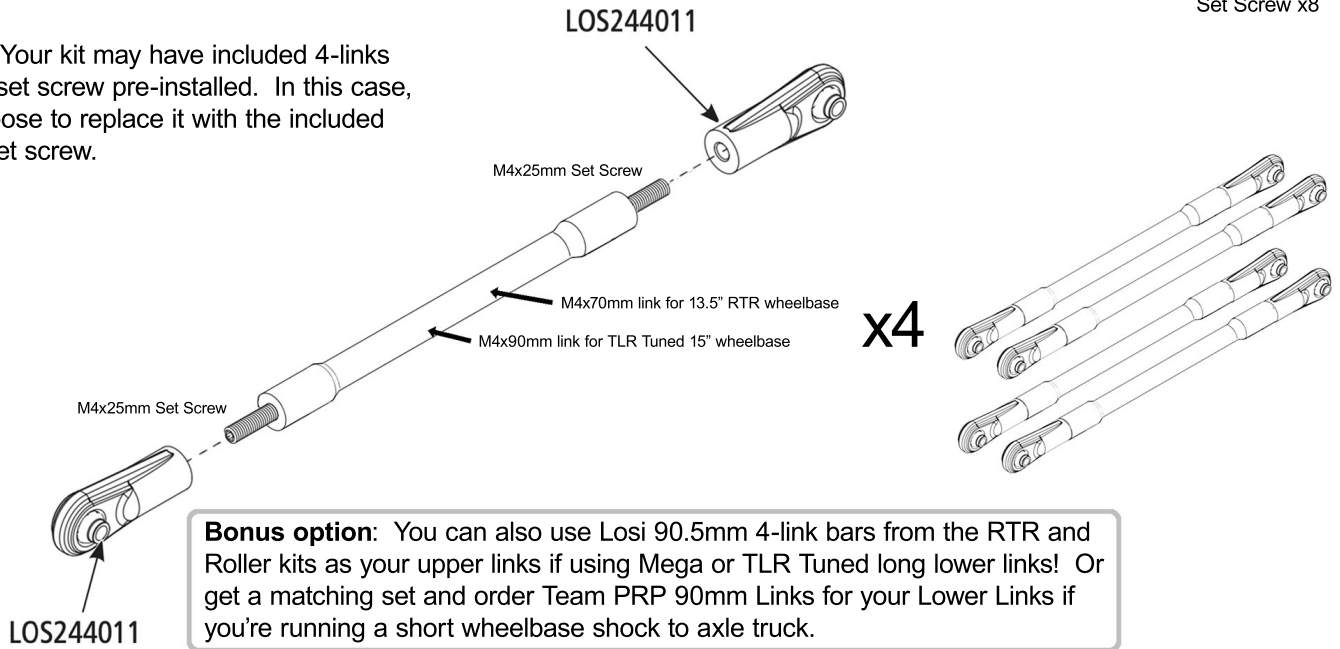

**Bonus option:** You can also use Losi 90.5mm 4-link bars from the RTR and Roller kits as your upper links if using Mega or TLR Tuned long lower links! Or get a matching set and order Team PRP 90mm Links for your Lower Links if you're running a short wheelbase shock to axle truck.

### 16

Attach 4-links to the Goblin center chassis core on both sides of the chassis. Use 70mm length for 13.5" wheelbase parts (RTR Grave/Son Uva Digger/Roller) and 90mm length for 15" wheelbase parts (TLR Tuned/Mega Truck).



M3  
Locknut x4

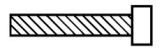

M3x16mm  
Cap Head x4

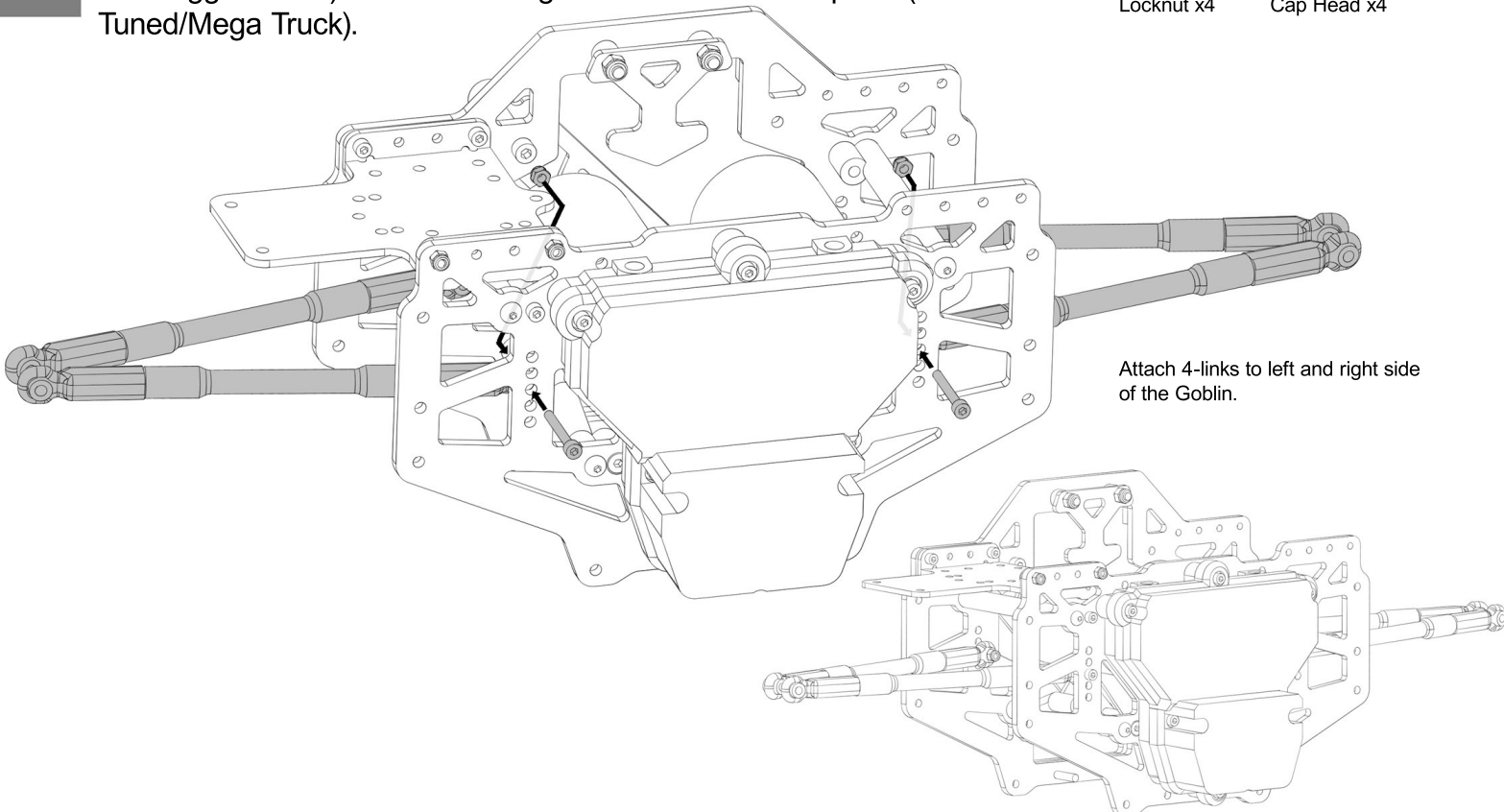

Attach 4-links to left and right side of the Goblin.

17

Now simply refer to the Team Losi LMT manual for instructions on how to mount the outer chassis plates, shocks and axles to the center chassis using the parts and hardware from your LMT kit and prepare to rip up the track with your new Team PRP Goblin!

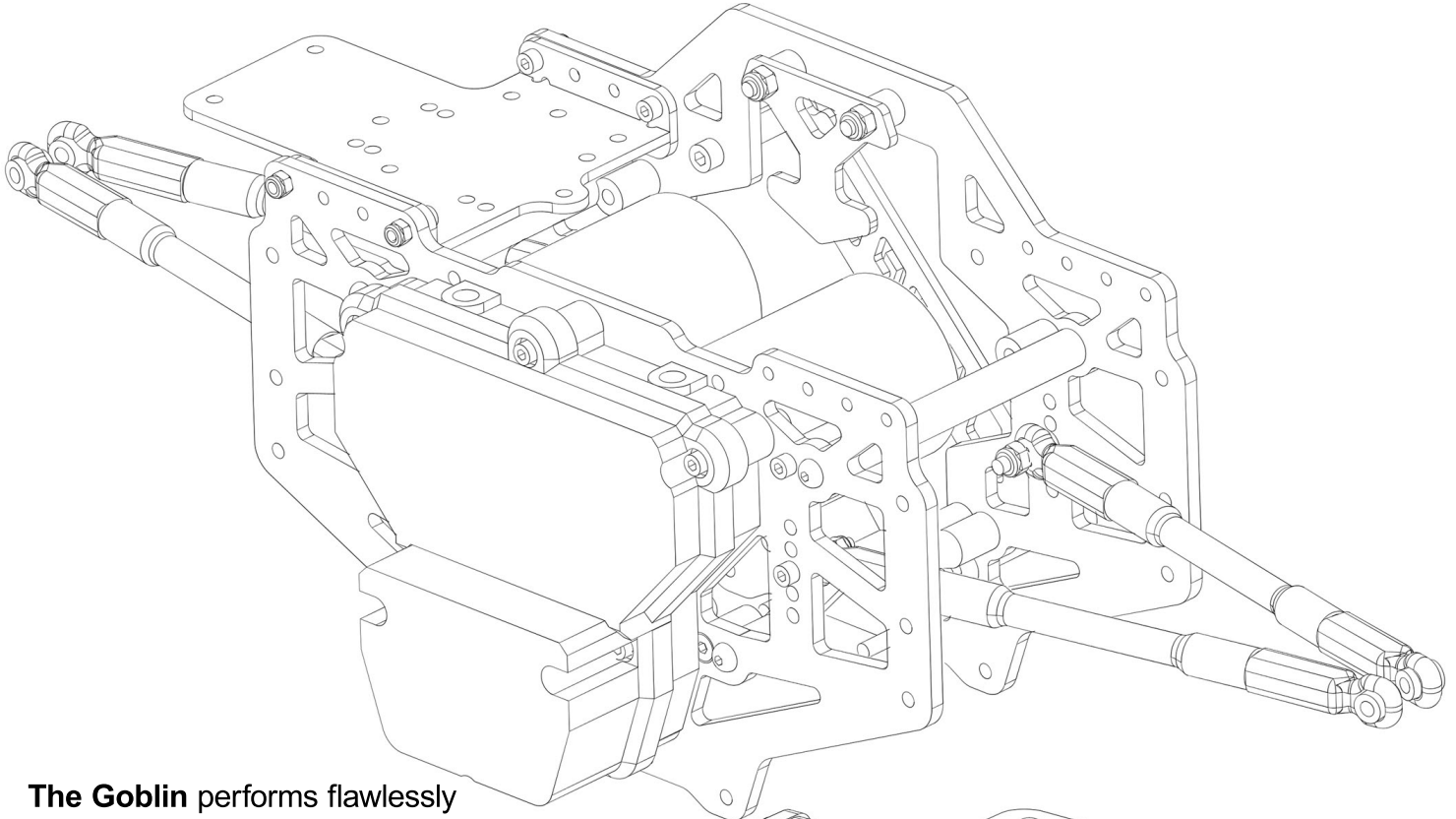

**The Goblin** performs flawlessly in dual motor Sport Mod, single motor 2.2 class or Pro Mod setups!\*

\*Check your club's rules! :)

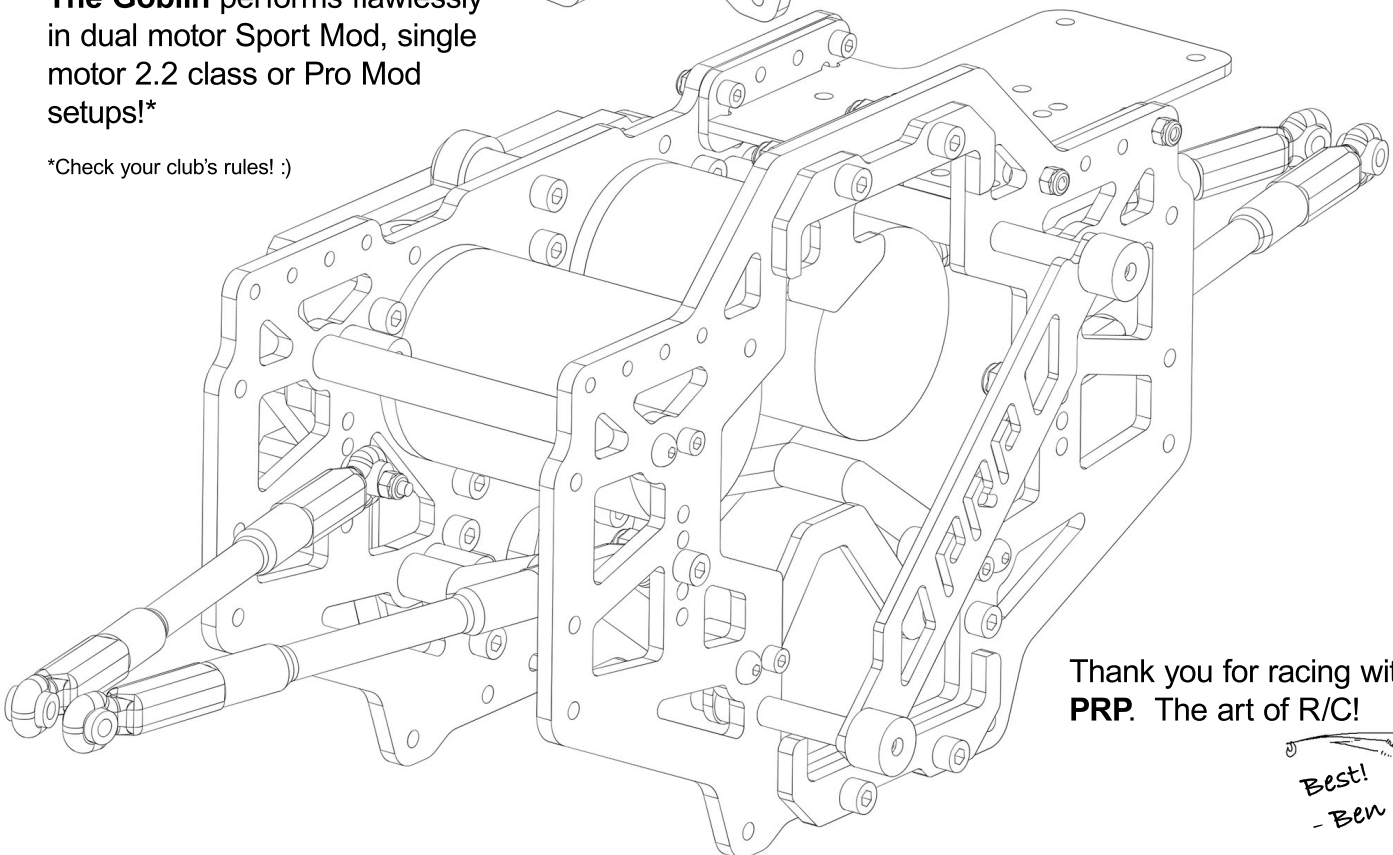

Thank you for racing with Team PRP. The art of R/C!

