

5

Test motor fit and positions. Most 540 and 550 motors should fit. You may rotate your motor mount endbell if your motor allows it (Tekin motors do) but it shouldn't be necessary. Begin planning your wiring as well. Fully mounting your motor isn't necessary at this point. **NOTE:** Remember, the Ogre 1.5 makes it easy to change your motor position by flipping the chassis plates or swapping them to either side. The motor can be mounted on front right, rear right, front left or rear left. When the motor is mounted on the LEFT side of the truck you must also rotate your center differential so the ring gear is toward the rear of the truck.

For Right Rear or Left Front motor position you must trim this area of the gearbox housing.

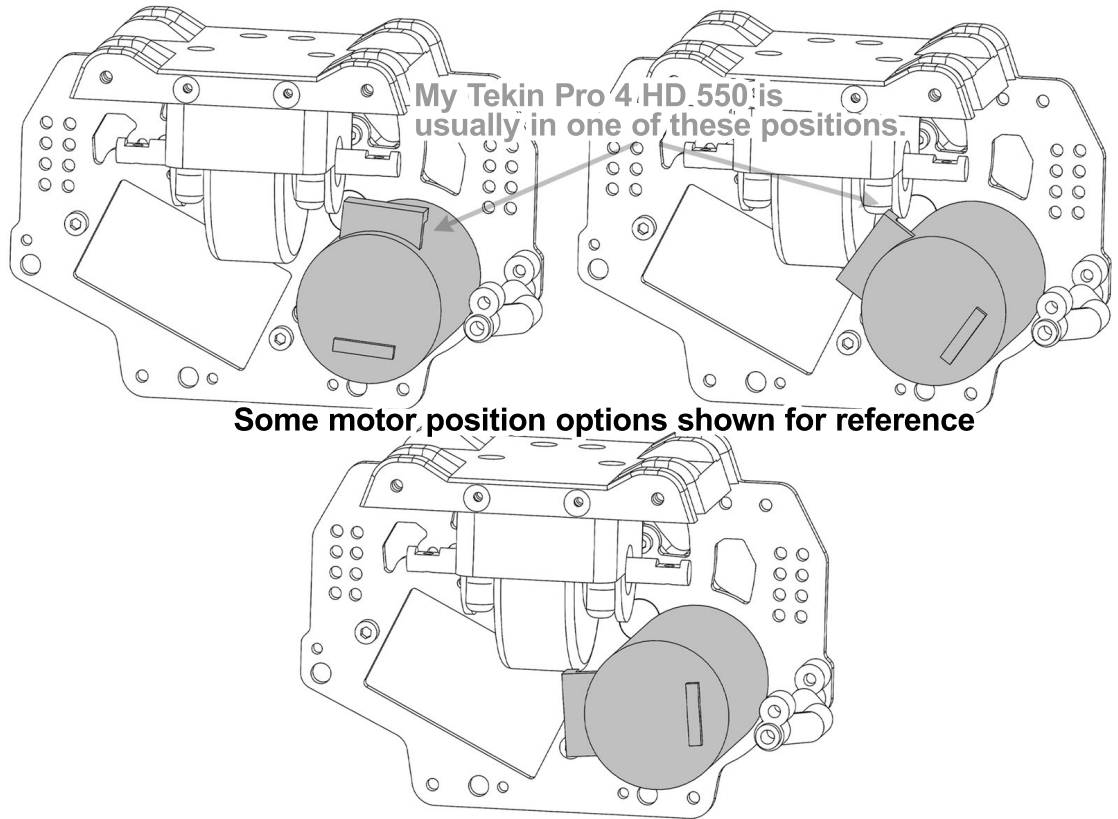
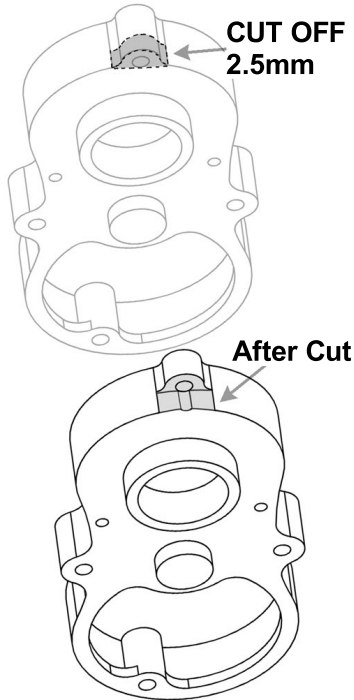

6

1. Press skid plate/diff housing into place.
2. Attach the new Ogre 1.5 upper tower brace to the chassis.

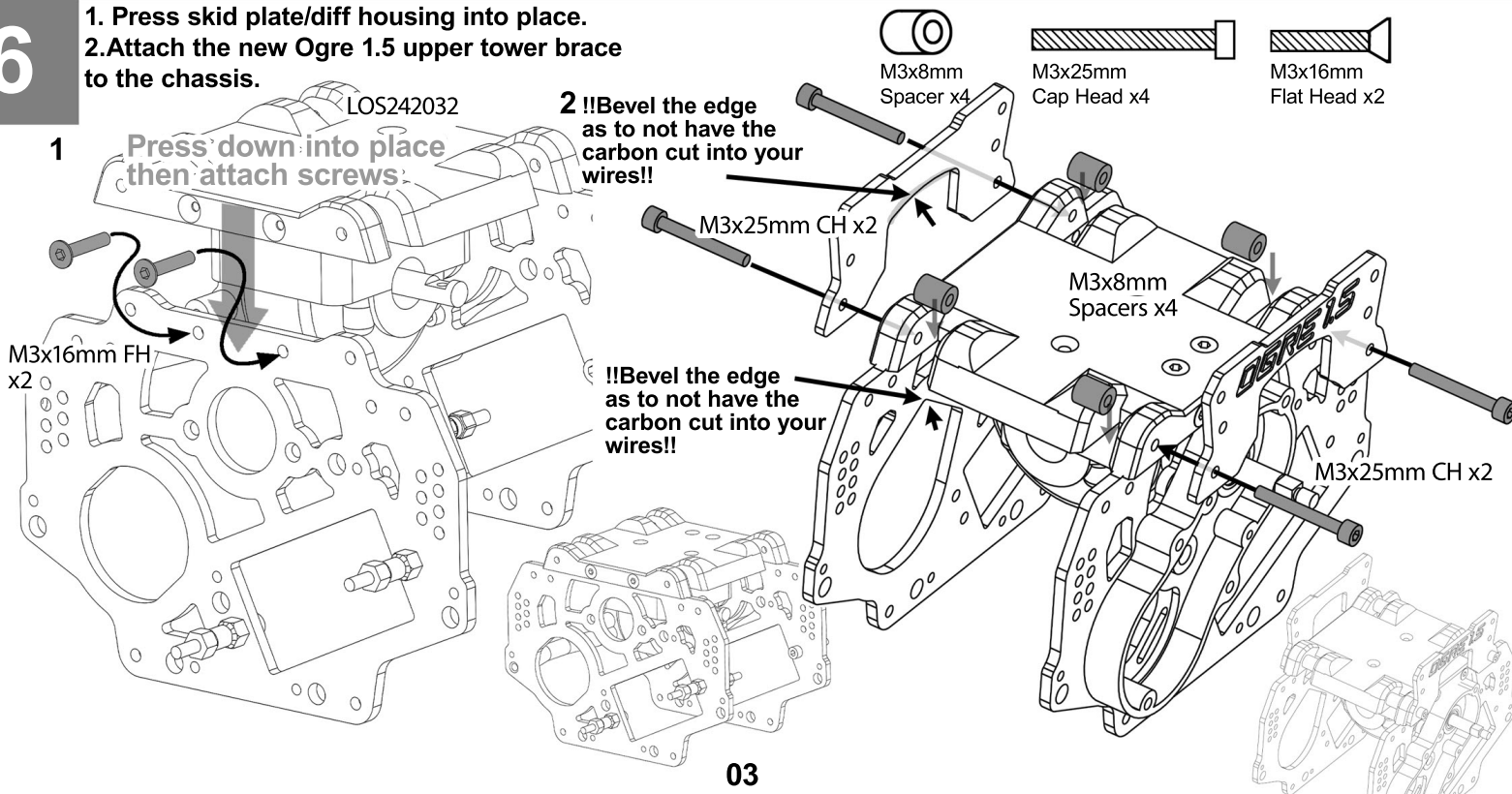

7

1. Build Ogrë 1.5 rear shock tower assembly.
2. Build Ogrë 1.5 front shock tower assembly.



M3 Locknut
x8



M3x18mm
Cap Head 8



M3x10mm
Cap Head x4

Losi Cross
Brace options

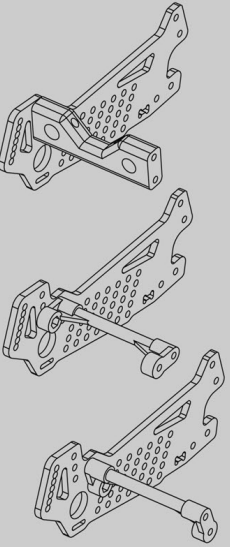

1. Rear tower assembly

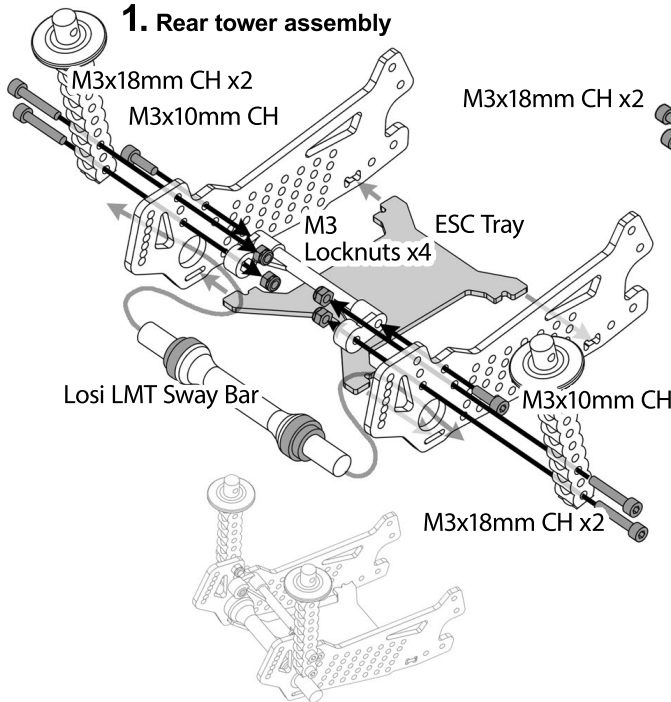

2. Front tower assembly

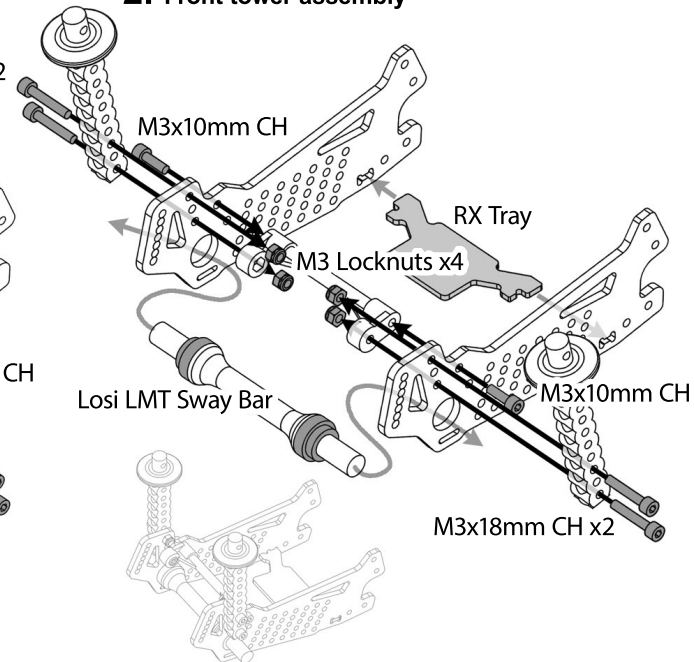

8

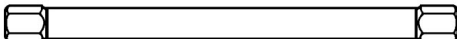

M3x60mm
cross brace x2



5.5mm
Plastic
Spacer x8



M3 Locknut
x12



M3x18mm
Cap Head x4



M3x16mm
Cap Head x4



M3x10mm
Cap Head x8

1. Attach front and rear shock tower assemblies (x2 both sides)

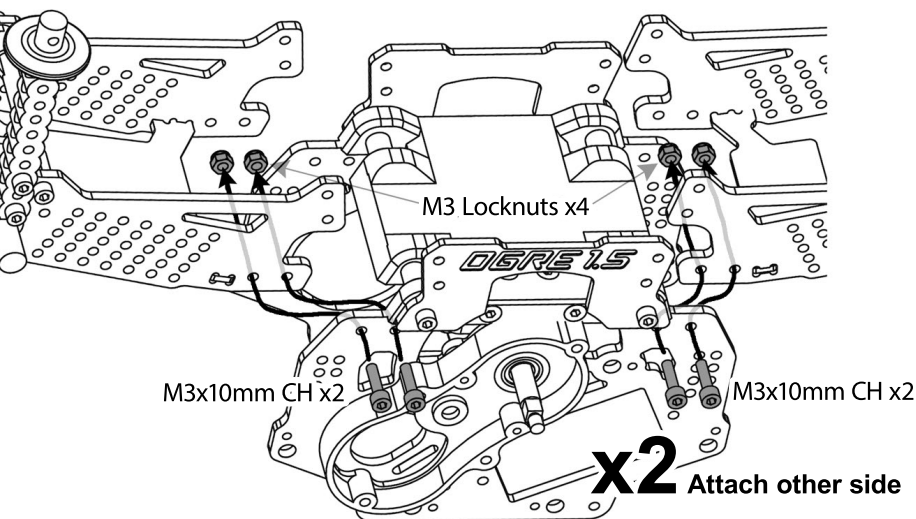

2. Affix upper bracing (x2 both sides)

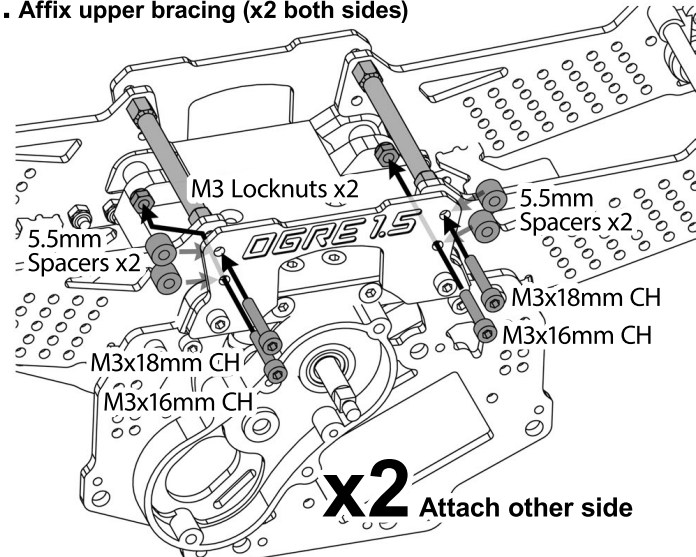

3. Cut the Losi LMT Mega center drive shafts #LOS242057 to fit your setup. These measurements are a guide. Check your setup carefully and cut more off if the shafts bottom out before the suspension bottoms out.

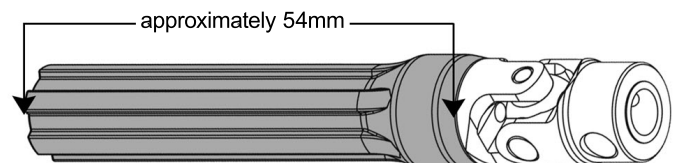
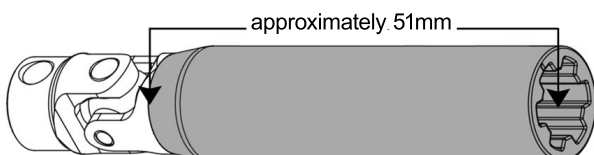

opt

OPTION: Body Post Extension Mounts.
These extensions mount to the limit strap holes on the *inside* of the shock towers and can be raised or lowered as needed.



M3 Locknut
x4



M3x18mm
Cap Head x2



M3x16mm
Cap Head x2

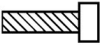

M3x10mm
Cap Head x2

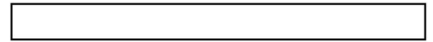

M3x55mm Cross Brace

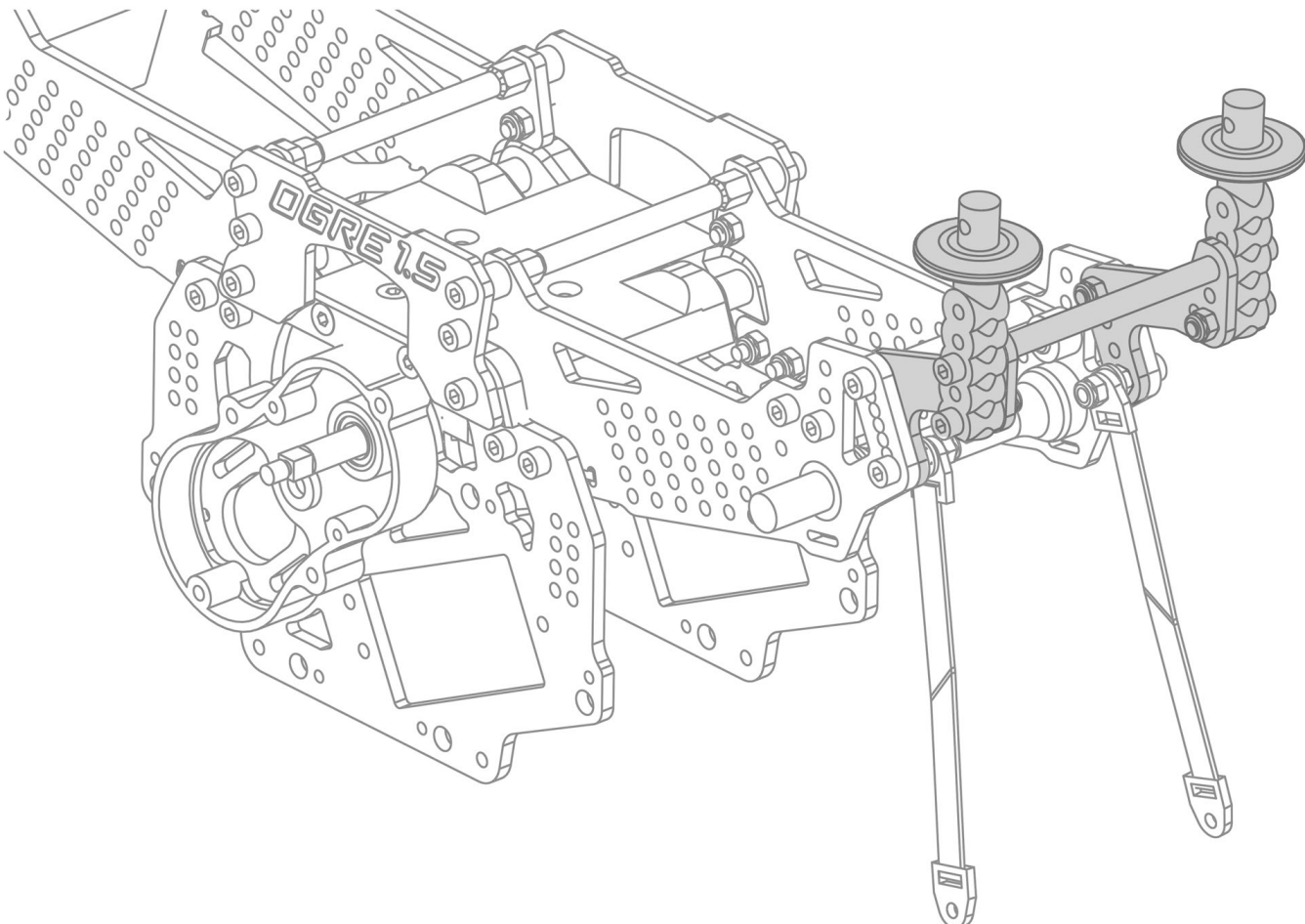
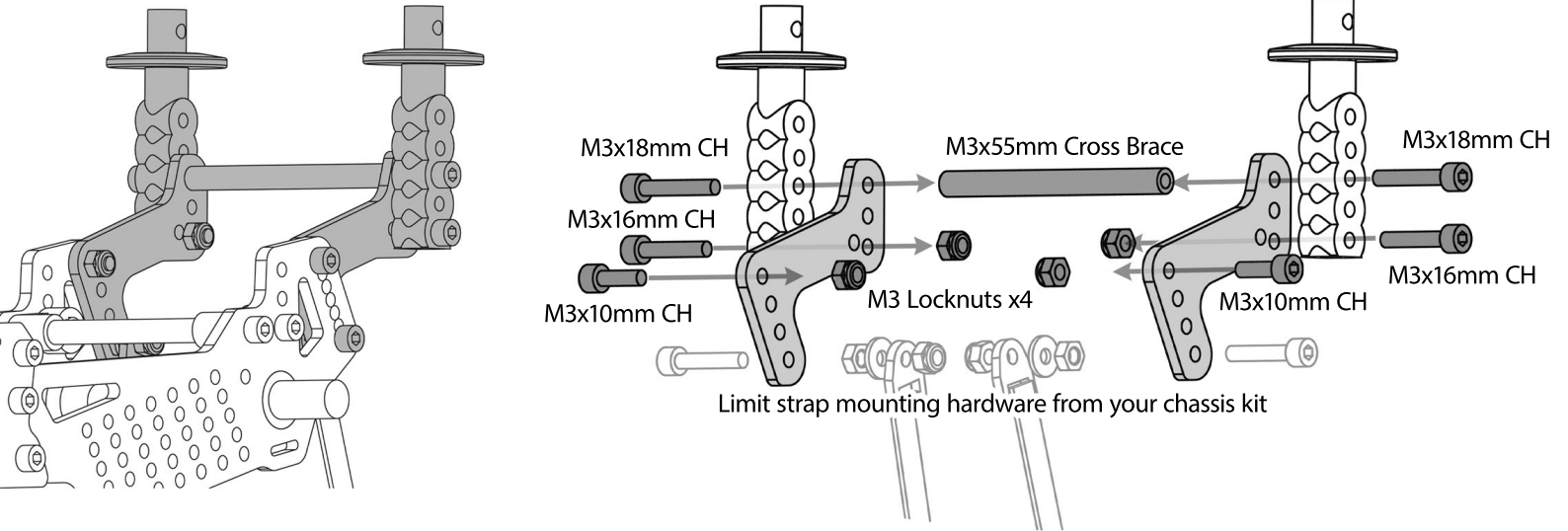

Body Post Extension Mounts